



Alumil  **SUPREME**
S650 PHOS



CONTENTS

SUPREME S650 PHOS

DESIGN PHILOSOPHY & CHARACTERISTICS	4
TECHNICAL CHARACTERISTICS	6
SENSE OF FREEDOM	8
ATTENTION TO DETAIL	10
THE ABSOLUTE MINIMAL DESIGN	12
FOCUS ON SAFETY	14
SECTIONS	16
STIFFENERS	34
GLAZING TYPES	35
INSTALLATION	36
APPLICATIONS	46
TABLE OF PERFORMANCE	47
REFERENCE PROJECTS	48



SUPREME S650 PHOS
is the ideal choice for sliding
windows with wide glazing surfaces
mounted in aluminium frames
that are totally flush
to the ceiling and the floor.

PHOS means **LIGHT**

*"Architecture is the learned game, correct and magnificent,
of forms assembled in the light."*

Bring Freedom

Inside

Alumil SUPREME
S650 PHOS

Alumil's sliding
thermal insulating system
SUPREME S650 PHOS...

Is the ideal solution for projects
requiring wide spans with **minimal
aluminium site lines.**

DESIGN PHILOSOPHY

@ CHARACTERISTICS

Massive yet elegant glazing surfaces

- All the aluminum profiles are totally concealed in wall so as to maximize natural light.
- Only 25 mm visible aluminium face width at the interlocking profile.
- Extra concealed profiles available for water drainage.
- Stainless steel rollers for smooth sliding & maximum functionality with high resistance to corrosion.
- Availability of 3 alternative solutions for the on-floor, in-floor or totally concealed in-floor installation, covered with the floor finish (version **SUPREME S650 Eclipse**).
- Alternative version for automated sliding sashes (**SUPREME S650 e-motion**).

alumil SUPREME
S650 PHOS



PRIVATE RESIDENCE / AEGINA, GREECE

TECHNICAL

CHARACTERISTICS

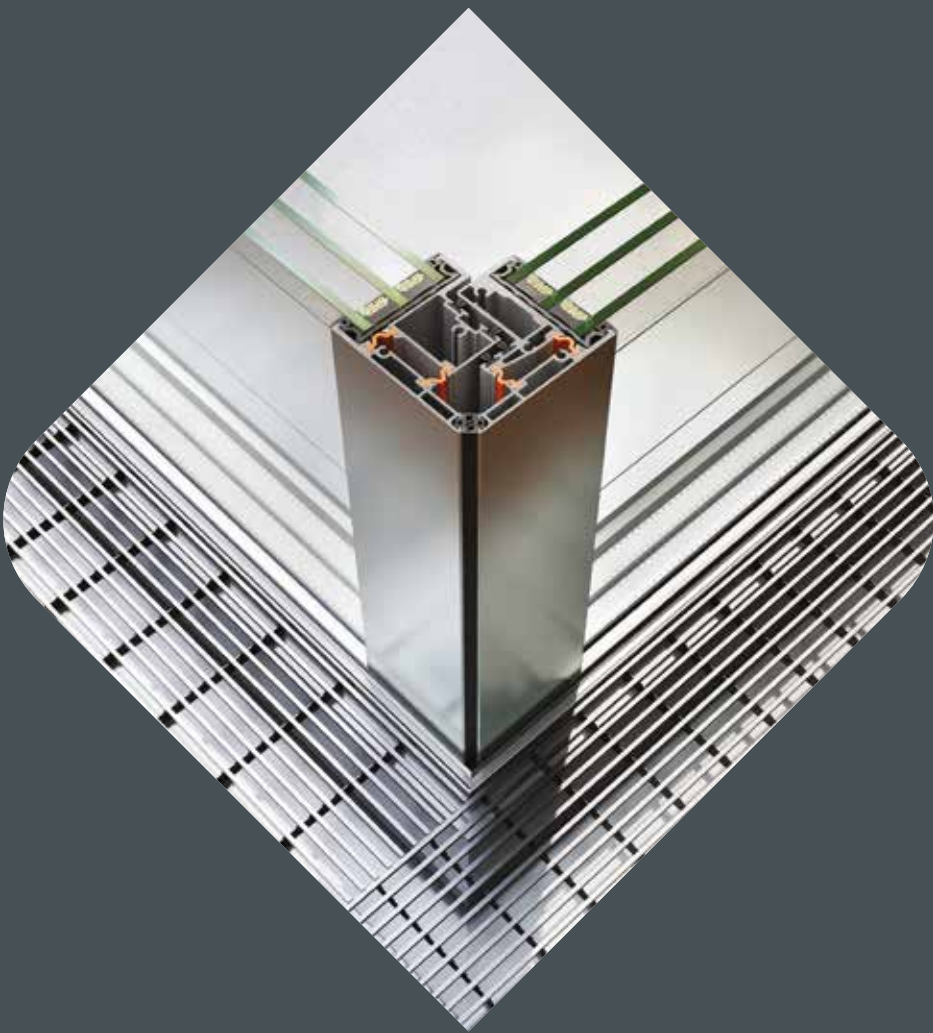

VISIBLE ALUMINIUM FACE WIDTH	CONCEALED PROFILES
FRAME HEIGHT	35 / 59 mm
FRAME WIDTH	164 mm
SASH HEIGHT	22 / 32 mm
SASH WIDTH	62 mm
INTERLOCKING PROFILE WIDTH	25 mm
SASH WEIGHT	1000 Kg
GLAZING	36 / 46 mm
INSULATION	POLYAMIDES, PVC

The limits between interior and exterior
are eliminated as the only aluminium width is

SENSE

OF FREEDOM

The system's main advantage is the improvement of living conditions by **maximizing the natural lighting and minimizing the visible aluminum face width**, which makes the residents feel closer to the external environment and increases their sense of freedom.

25mm at the interlocking profile.



Alumil SUPREME
S650 PHOS

SUPREME S650 PHOS offers a unique combination of **elegance** and **functionality**, satisfying even the most demanding requirements.

ATTENTION

ITS MINIMAL DESIGN ALONG WITH THE WIDE GLAZING SURFACES ENHANCE **MAXIMUM VISIBILITY** AND **NATURAL LIGHT** BY USING TOTALLY CONCEALED PROFILES INTO THE WALLS, THE FLOOR AND THE CEILING.

TO DETAIL

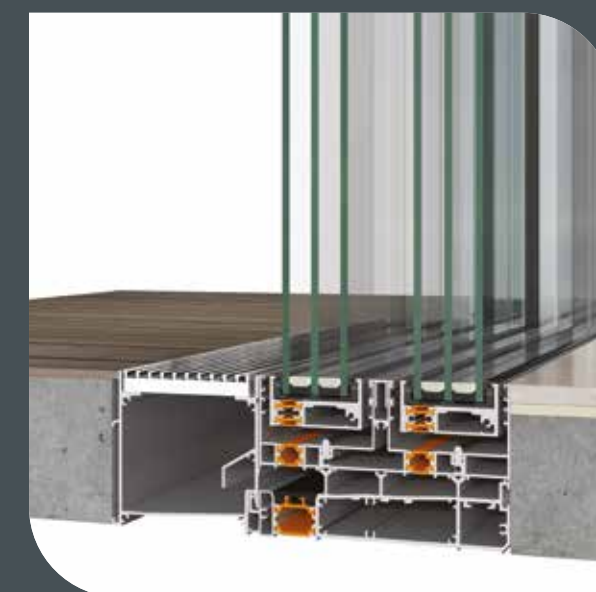

ALTERNATIVE VERSION FOR TOP-MOUNTED INSTALLATION WITH A LOW THRESHOLD, a flat track that is addressing safety issues for easy and safe access to children, elders and people with disabilities. A more flexible solution ideal for renovations with innovative water drainage.



Alumil SUPREME
S650 ECLIPSE

The innovative invisible track is totally integrated into the floor and covered with the floor finish offering a **flat surface** and creating continuity between the interior and the exterior environment.

THE ABSOLUT

DESIGNED TO MEET THE ARCHITECTURAL DEMANDS OF MINIMAL THERMALLY INSULATED SLIDING SYSTEMS WITH MINIMUM ALUMINUM SIGHT LINES.

MINIMAL DESIGN



- Invisible bottom frame totally flush to the floor
- Profiles totally concealed in-wall for maximum natural light.
- Only 25 mm visible aluminium face width at the interlocking profile.
- Concealed water drainage with high performance.
- Stainless steel rollers easily replaced for maintenance.
- New inox philosophy for flawless sash gliding & durability overtime.

Alumil SUPREME
S650 PHOS

FOCUS

ON SAFETY

ROLLERS

Stainless steel rollers ideal for seaside projects. For heavy duty constructions up to **1000 Kg** per sash, offering high functionality & smooth gliding of the sashes.

CERTIFIED PERFORMANCES TESTED ACCORDING EN 13126-1 AND EN 1670 FOR:

- CORROSION RESISTANCE
- DURABILITY
- STATIC LOAD
- HARDNESS

LOCKING SYSTEM

CERTIFIED PERFORMANCES TESTED ACCORDING EN 13126-1 AND EN 1670 FOR:

- MULTIPLE LOCKING POINTS.
- TOP - BOTTOM AND/OR AT THE LOCKING SIDE OF THE SASH.
- WRONG OPERATION SAFETY DEVICE TO PROTECT THE SASH FROM MISUSE.

HANDLES

Branded handles with **ALUMIL** unique design offer high security as they are lockable with key placed on the handle level. In addition, they are very easy to install after transportation on site and can be easily removed for maintenance.

- STANDARD HANDLE
- MINIMAL HANDLE
- FULL HEIGHT HANDLE



Alumil SUPREME
S650 PHOS

2 Sashes / 2 Track

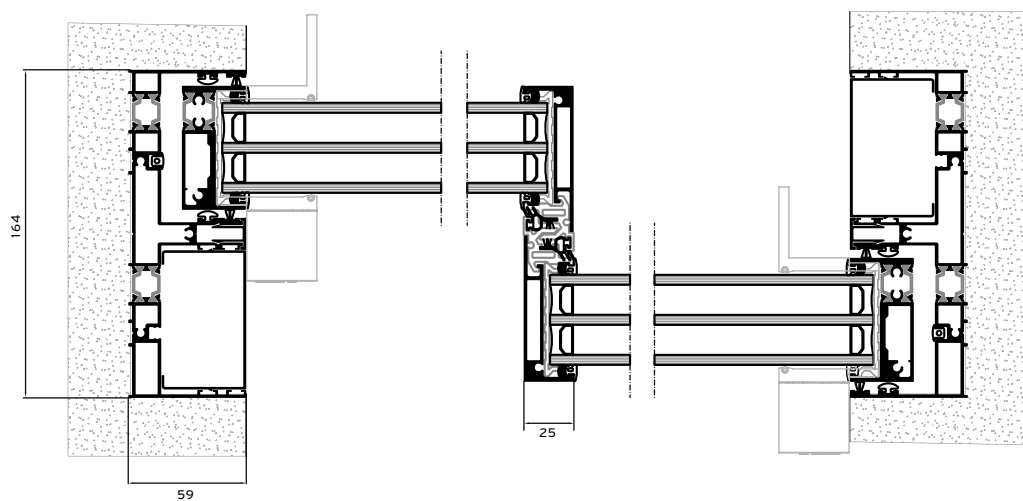
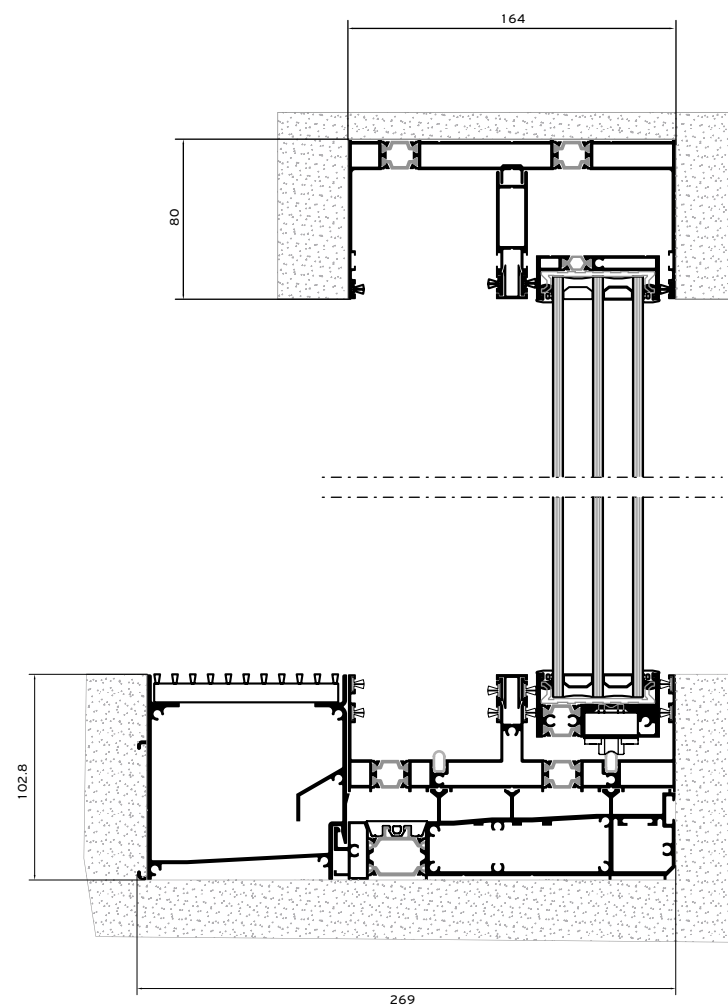
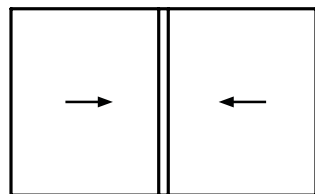

2 Sashes / 2 Track Low Threshold

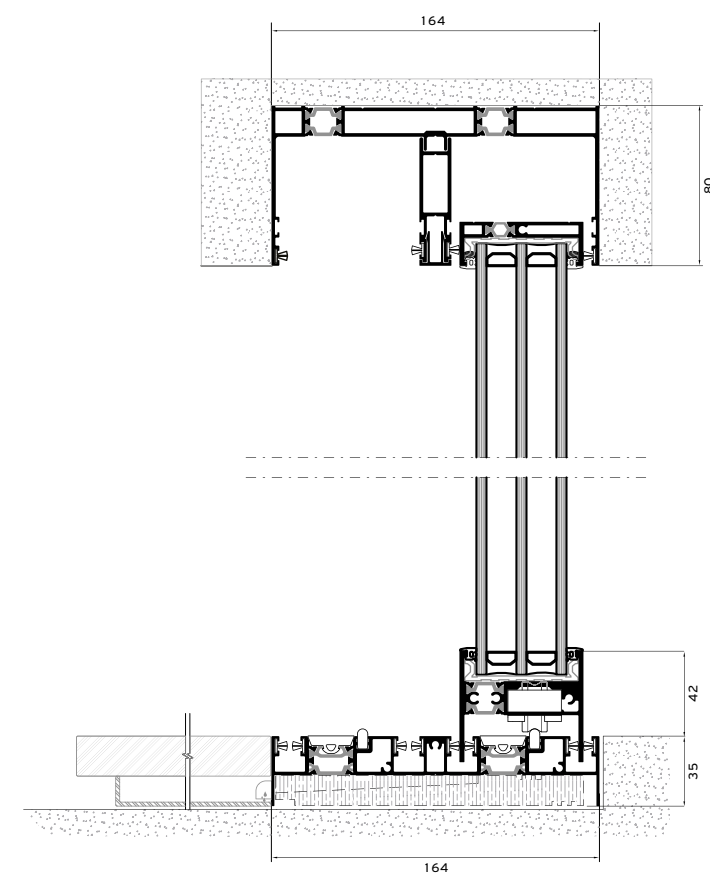
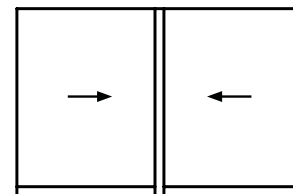

3 Sashes / 3 Track

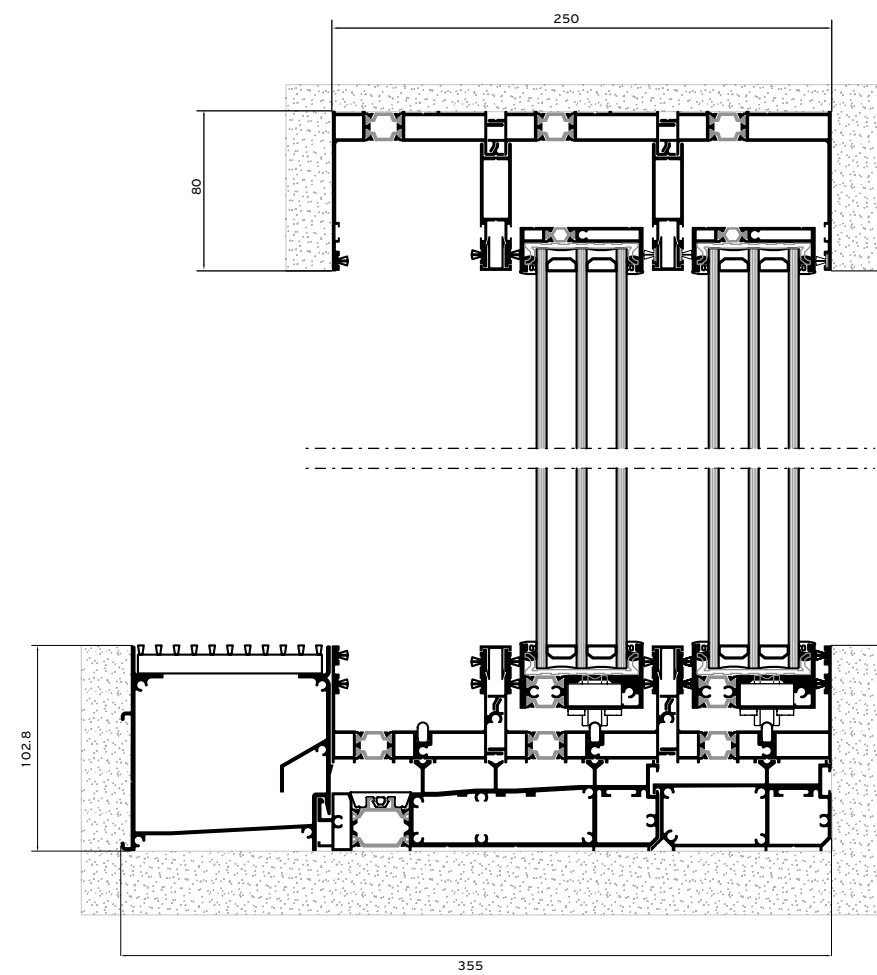
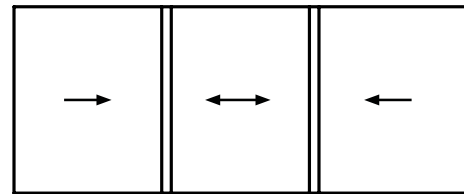

3 Sashes / 3 Track Low Threshold

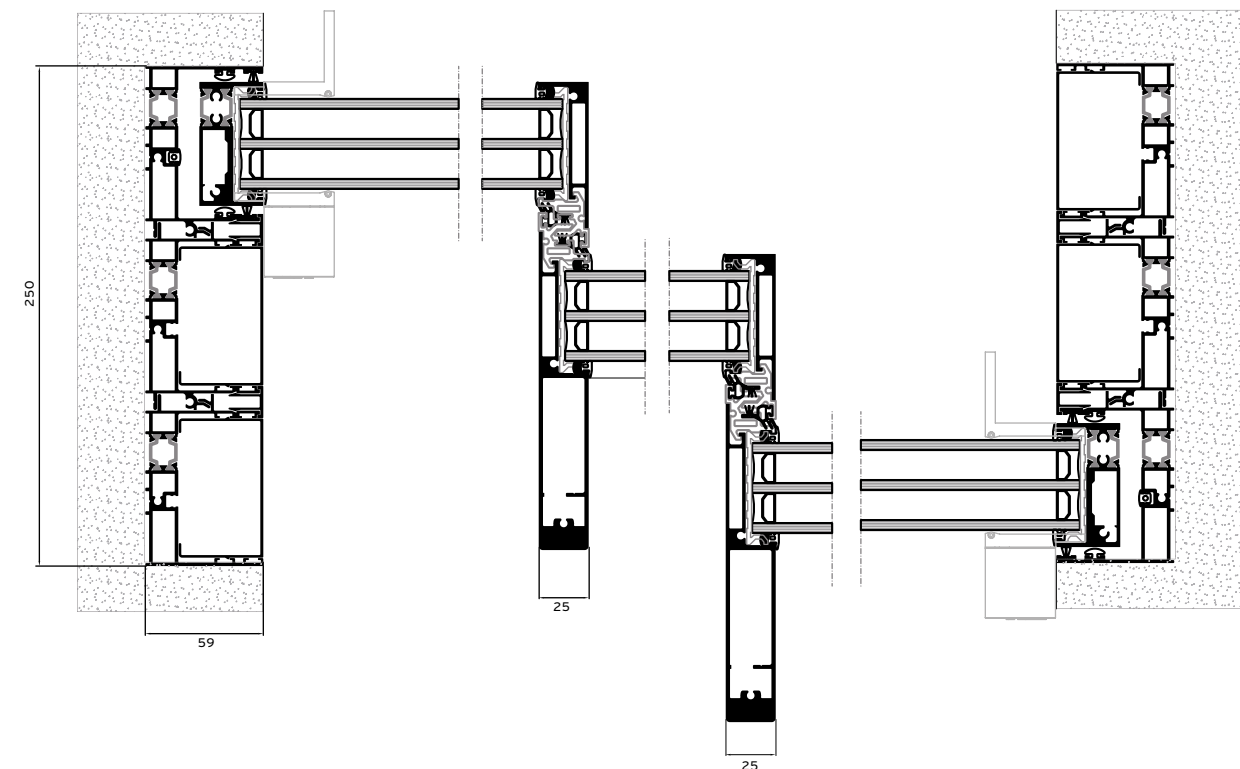
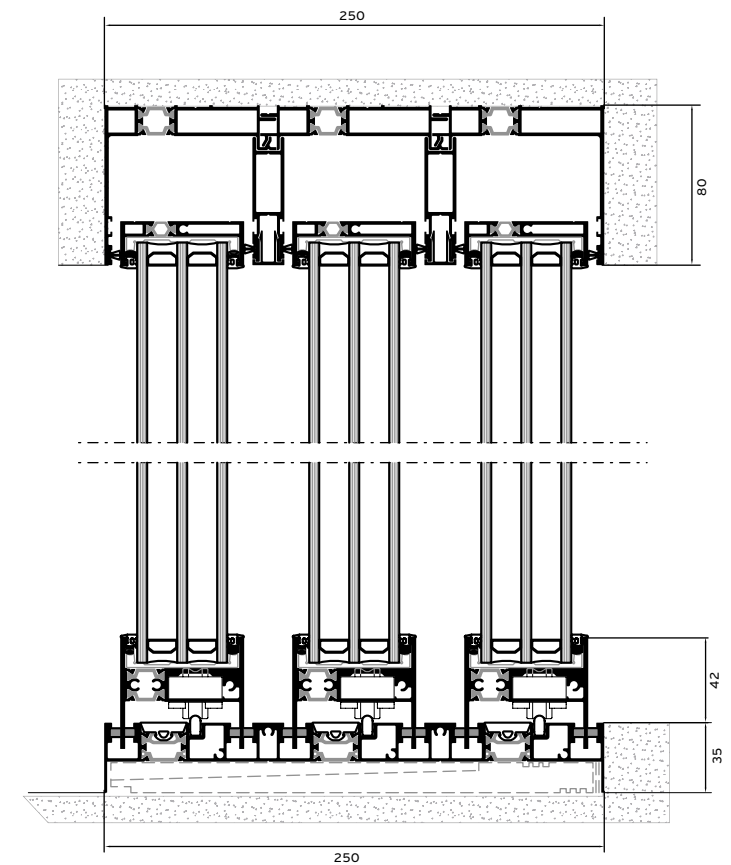
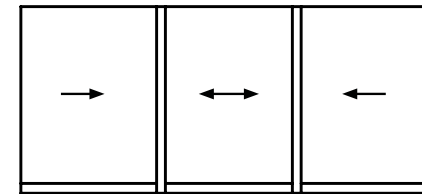

Alumil SUPREME
S650 PHOS

2 Sashes / 3 Track / Flyscreen

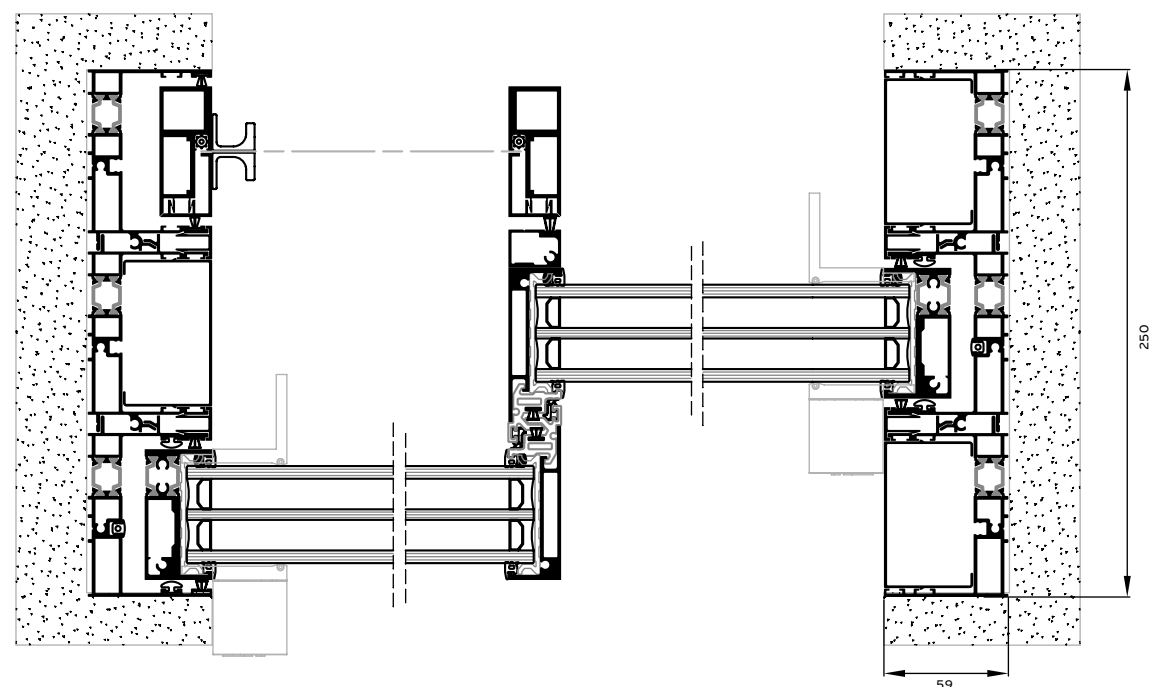
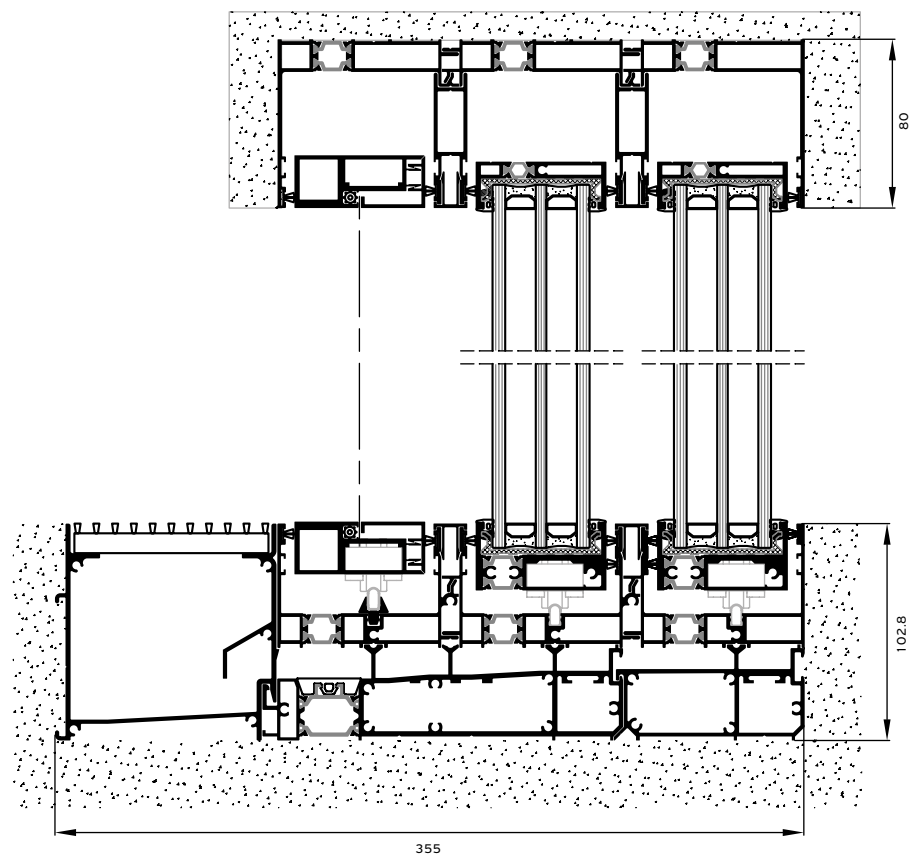
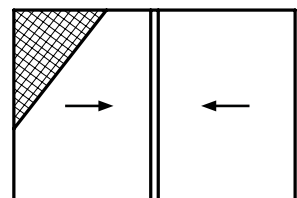

2 Sashes / 3 Track / Flyscreen

Low Threshold

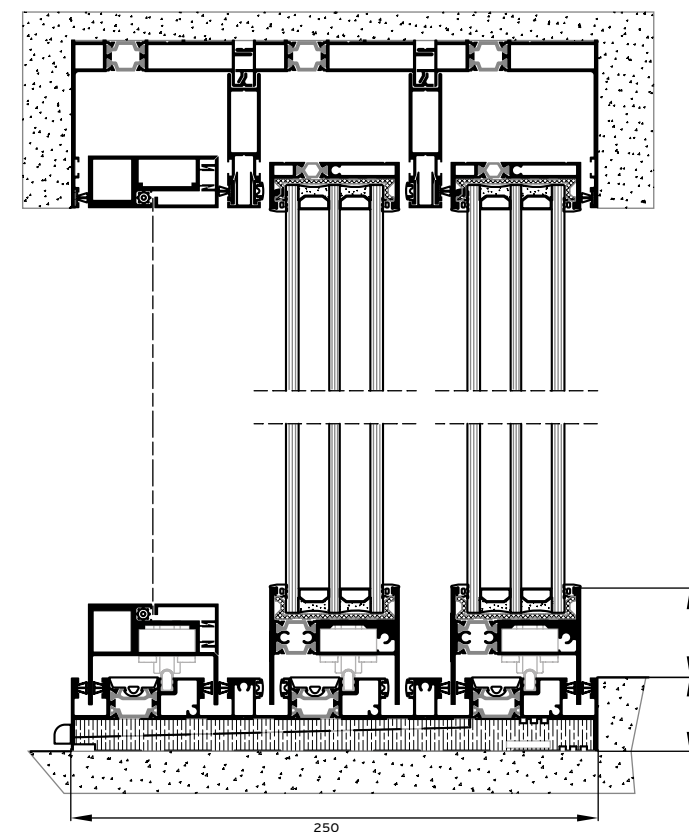
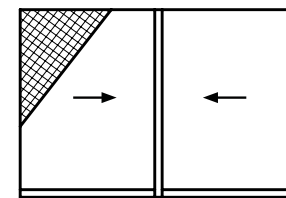

2 Sashes / 2 Track

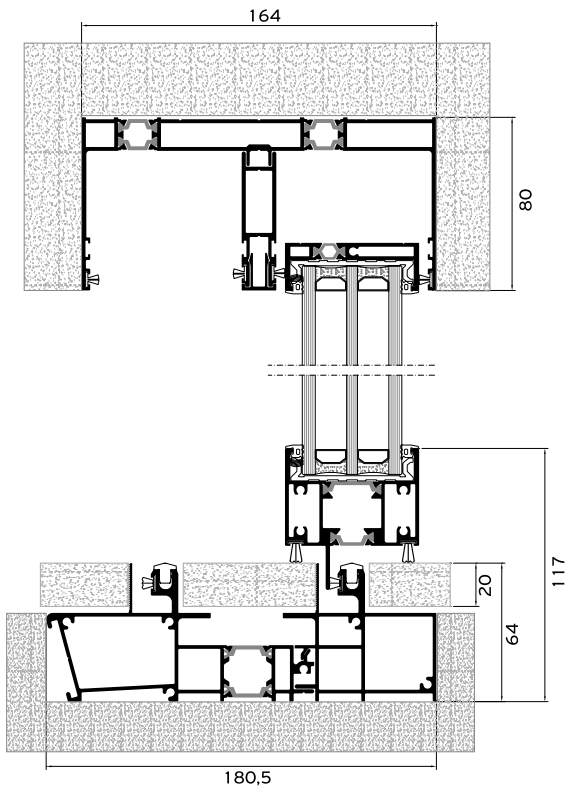
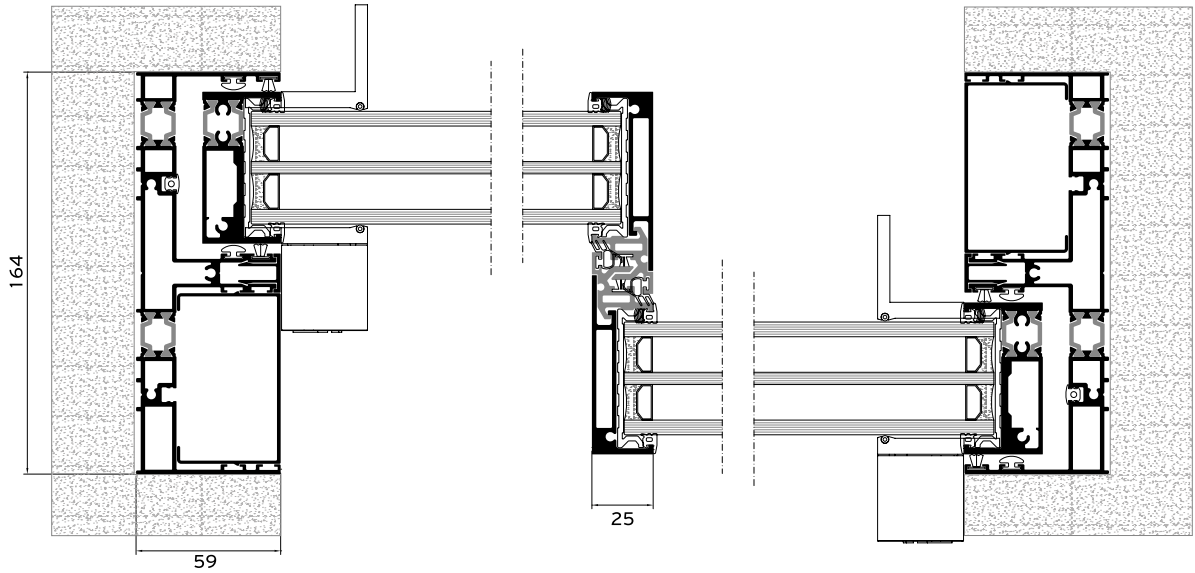
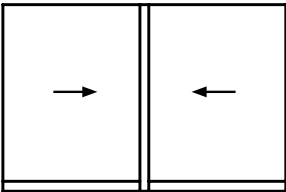

3 Sashes / 3 Track

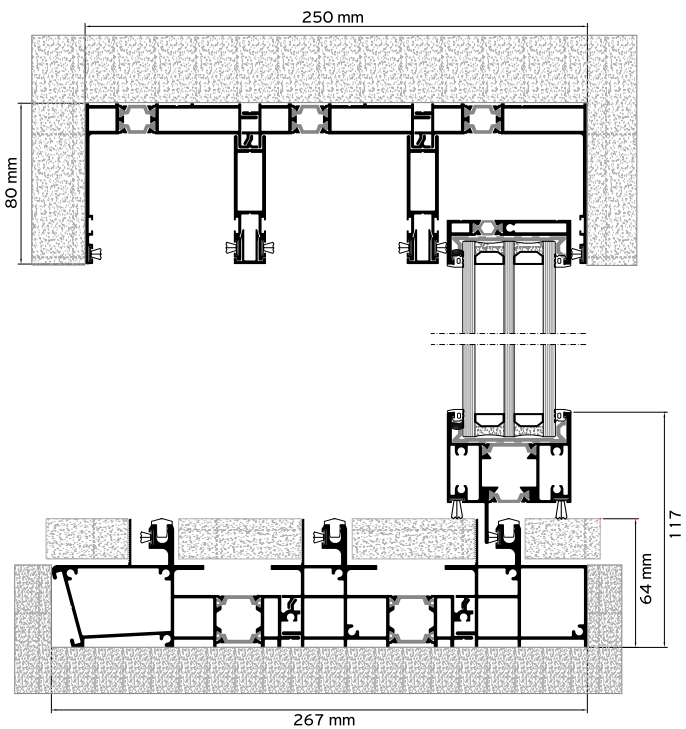
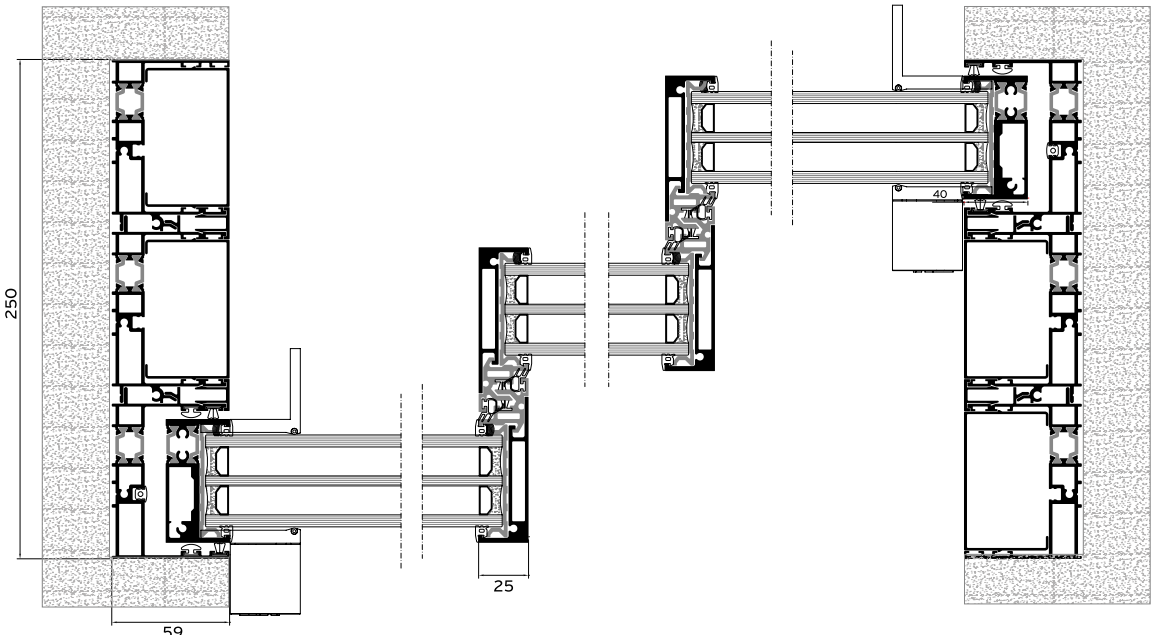
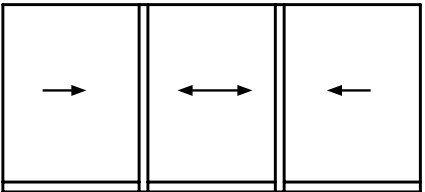

Alumil > SUPREME
S650 ECLIPSE

2 Sashes / 2 Track / Flyscreen

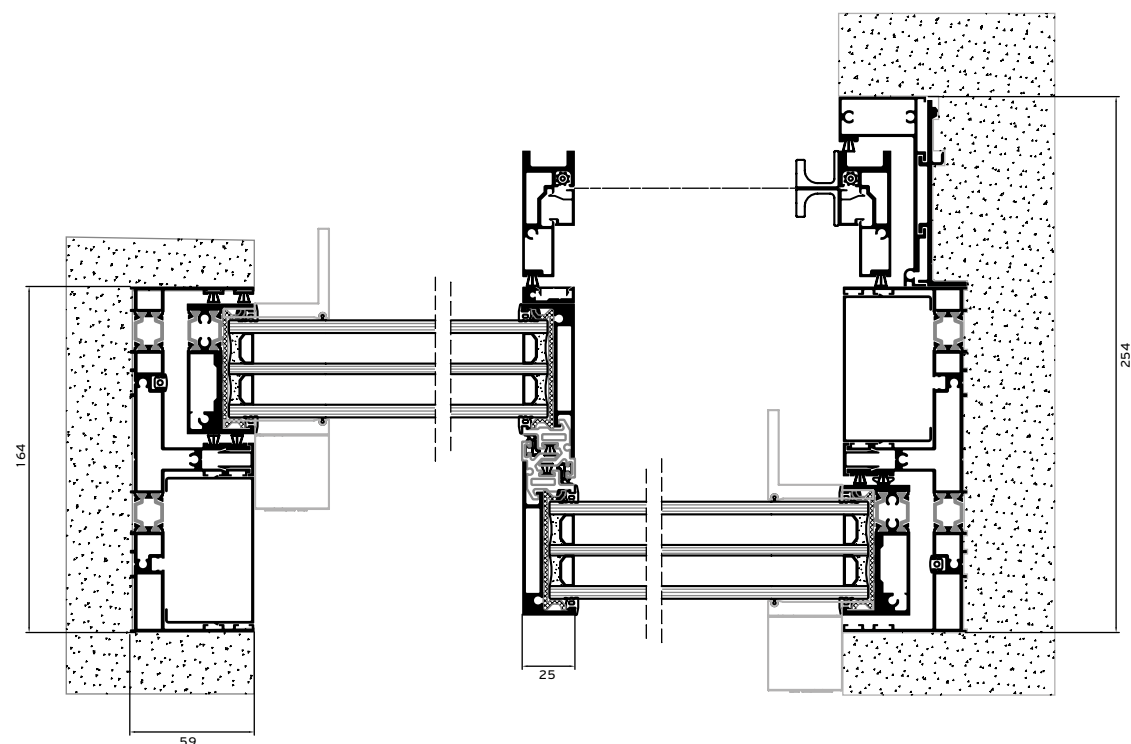
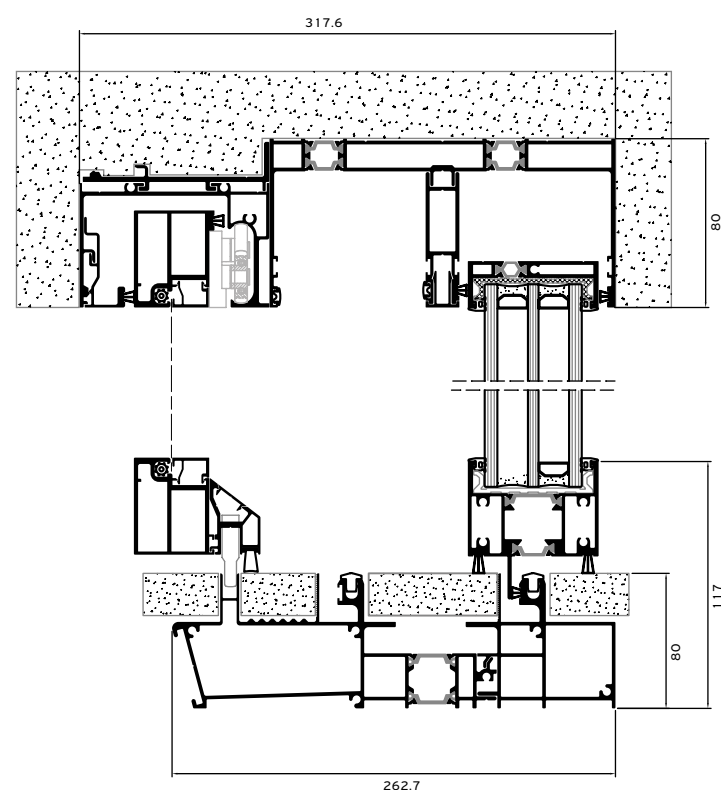
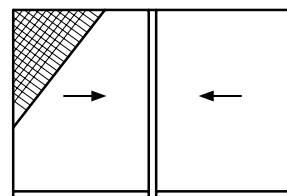

Alumil > SUPREME
S650 PHOS

4 Sashes / 2 Track

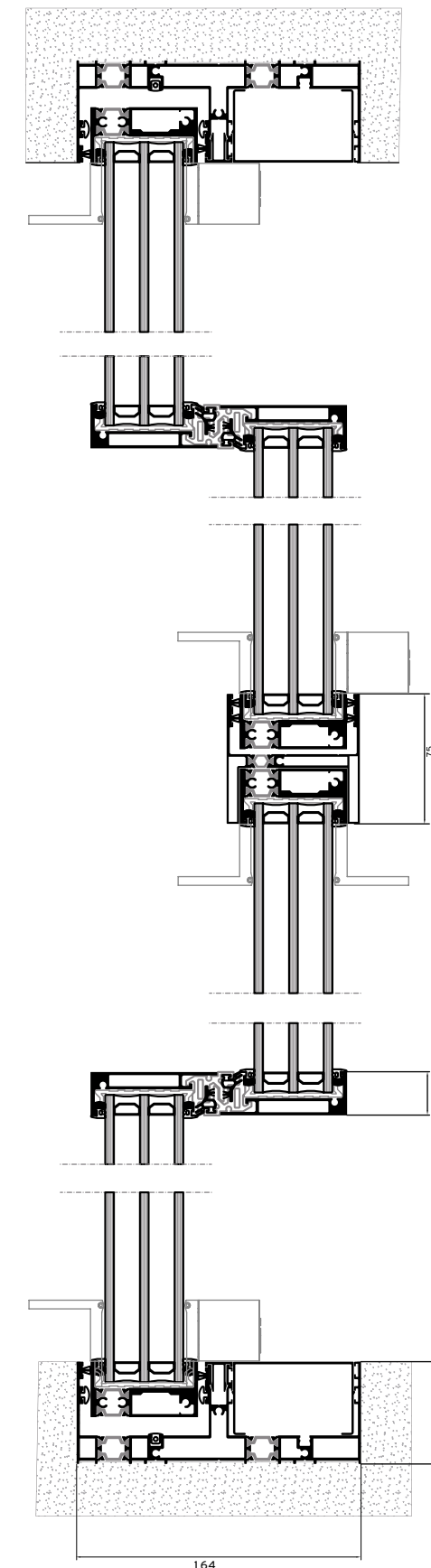
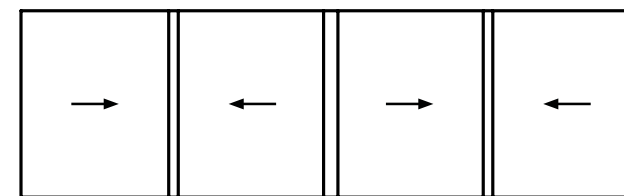

Rotate the technical drawing
90° CLOCKWISE IN ORDER
TO READ IT PROPERLY

1 Sash / 2 Fixed lights

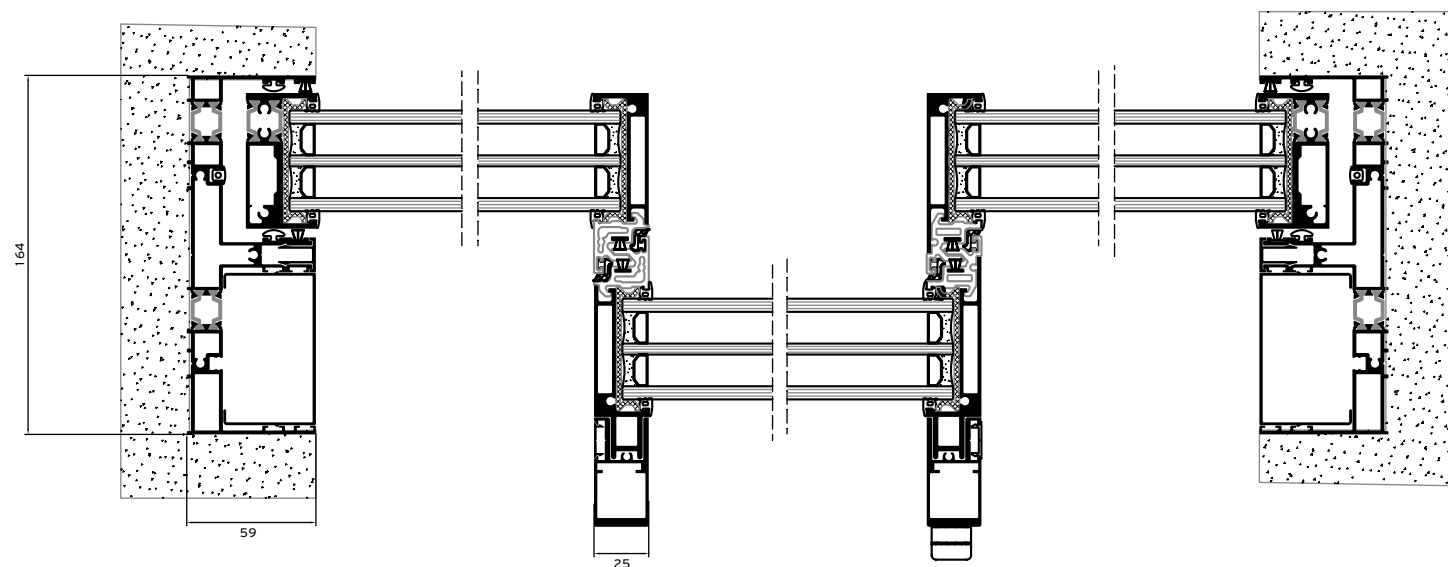
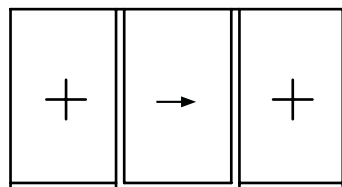

2 Sashes / 2 Fixed lights

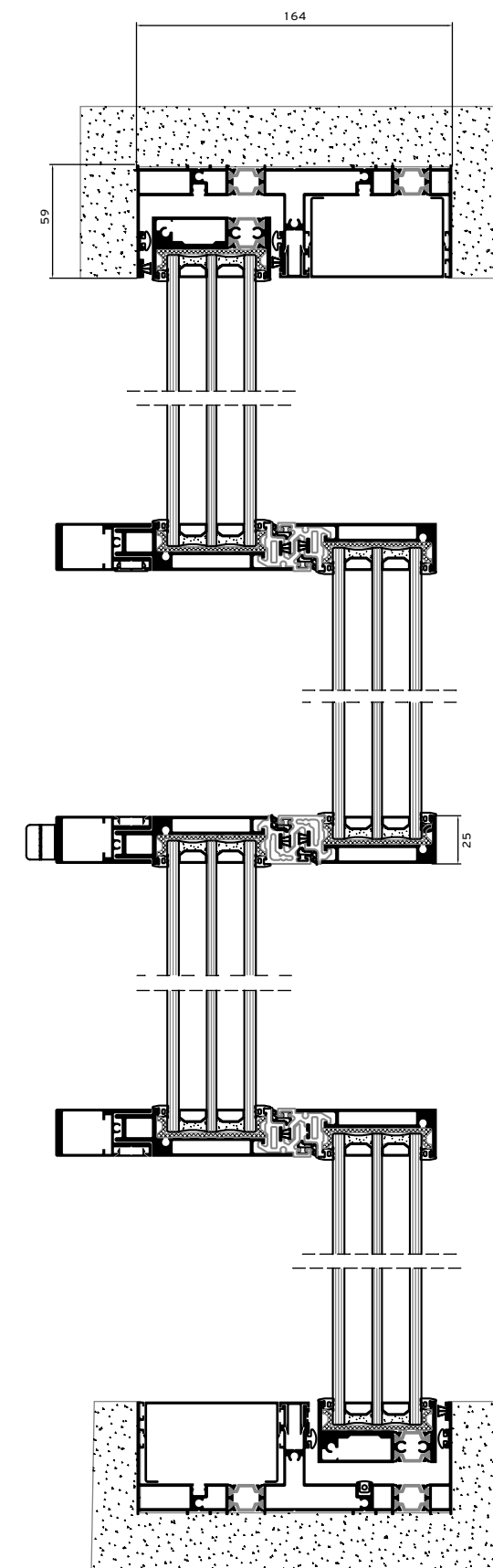
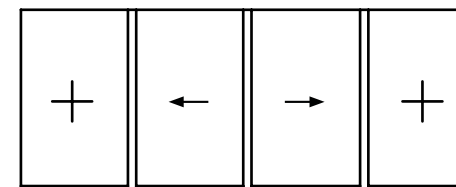

Rotate the technical drawing
90° CLOCKWISE IN ORDER
TO READ IT PROPERLY

Alumil > SUPREME
S650 PHOS

External Corner

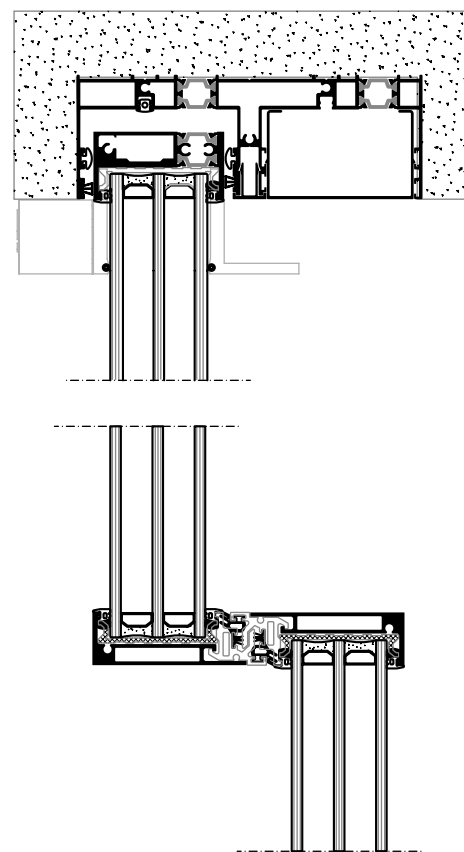
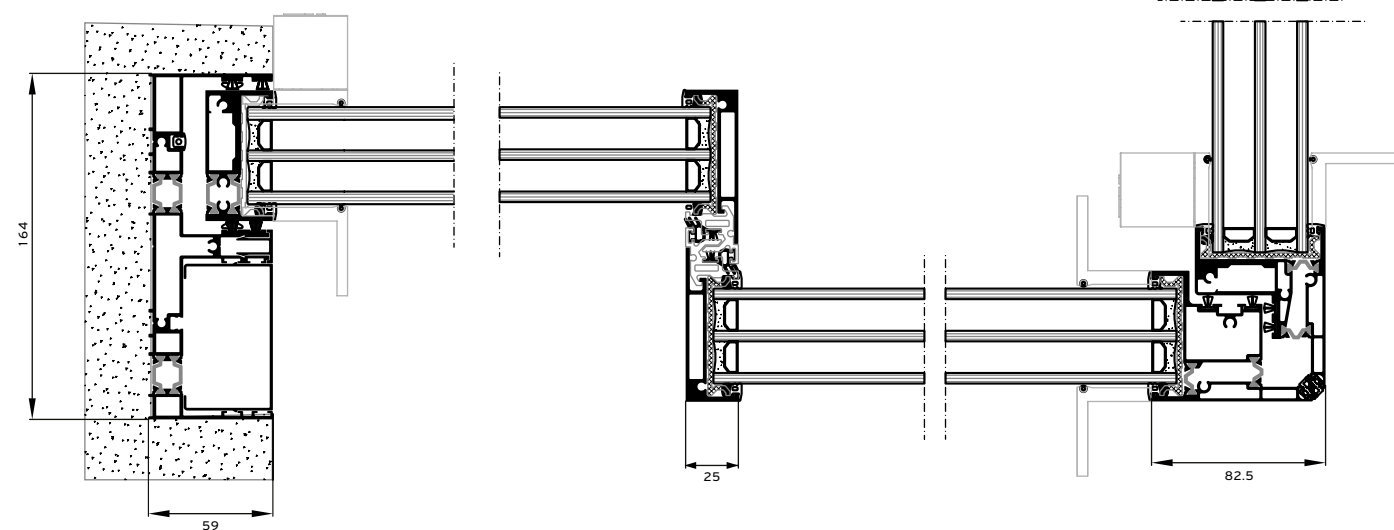
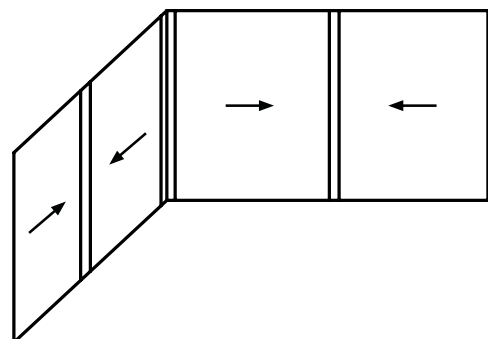

Pocket Window

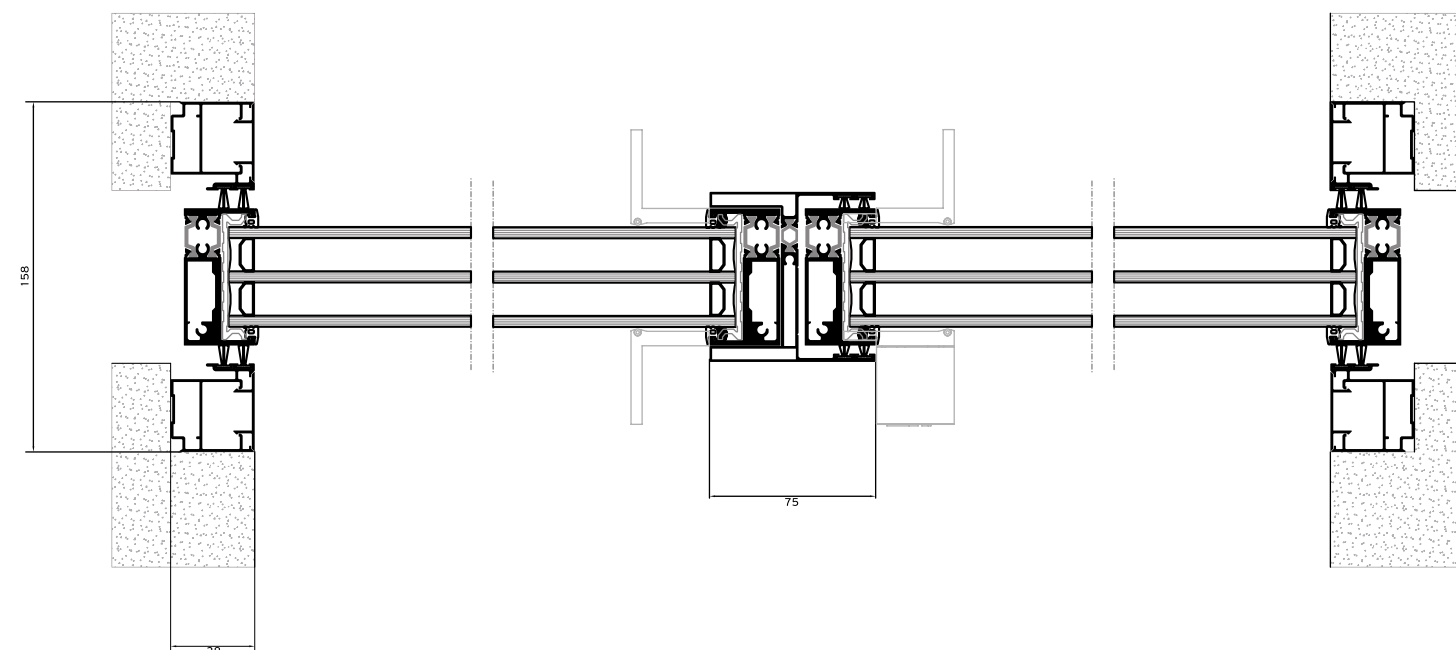
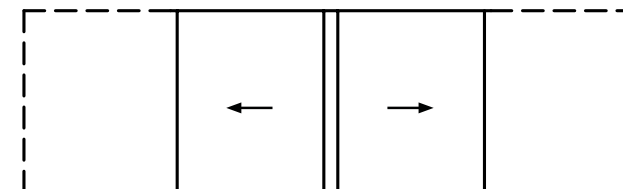

2 Sashes / 1 Track

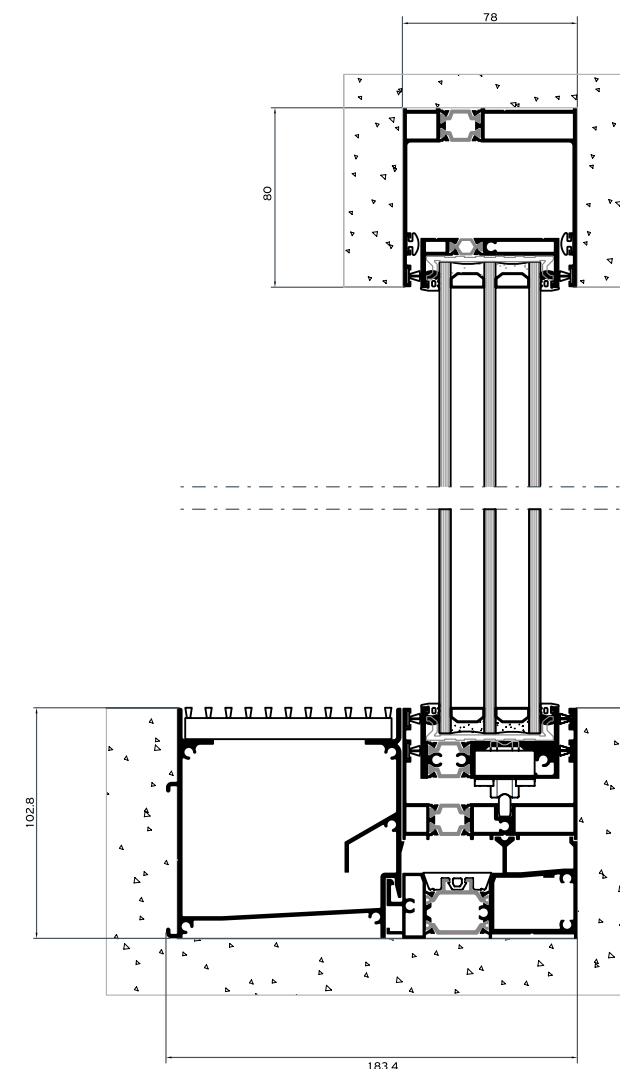

Alumil SUPREME S650 PHOS

Multi Track

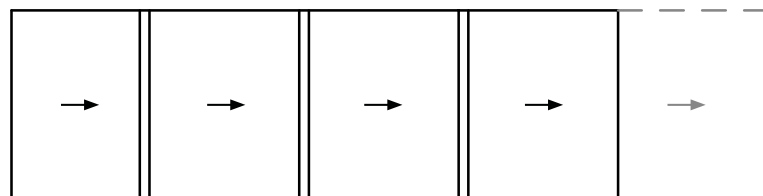

"No limits at the number of the horizontal sashes with the multi track typologies"

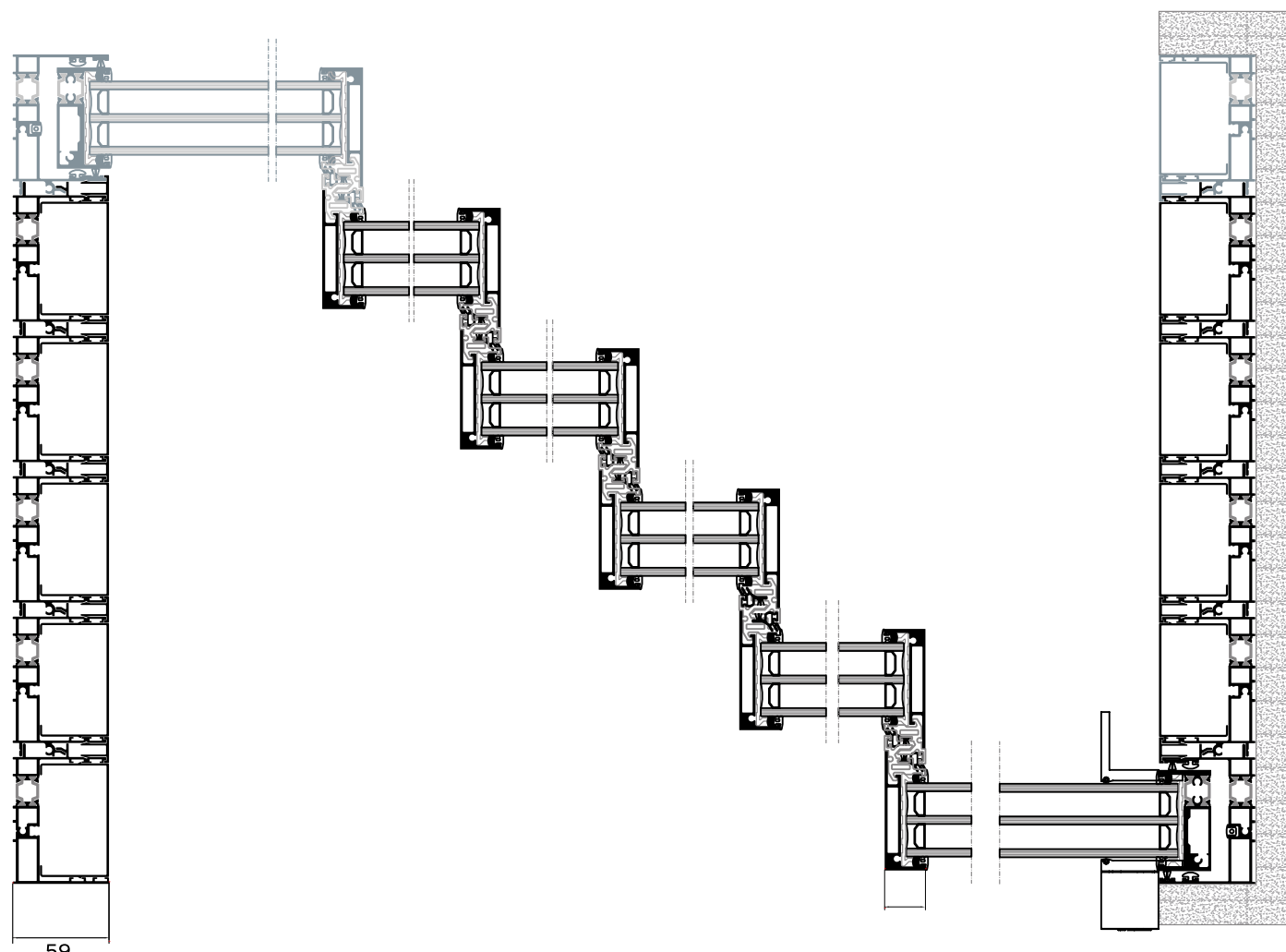
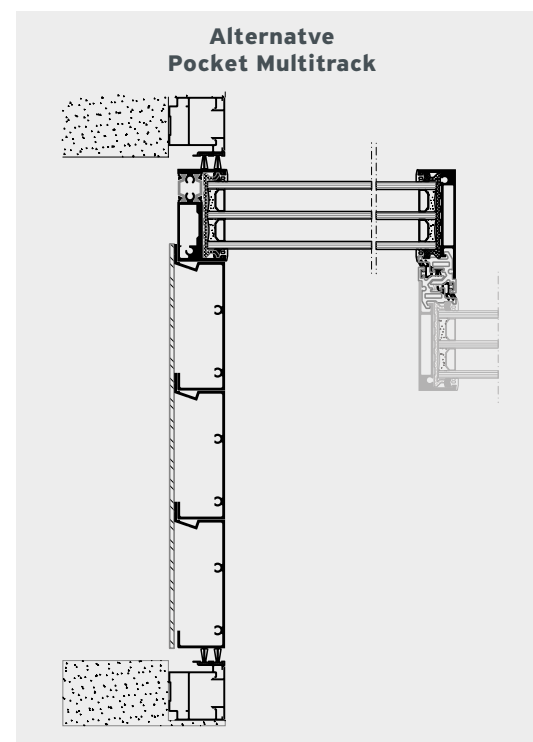

2 Sashes / 2 Track / ZIP Screen

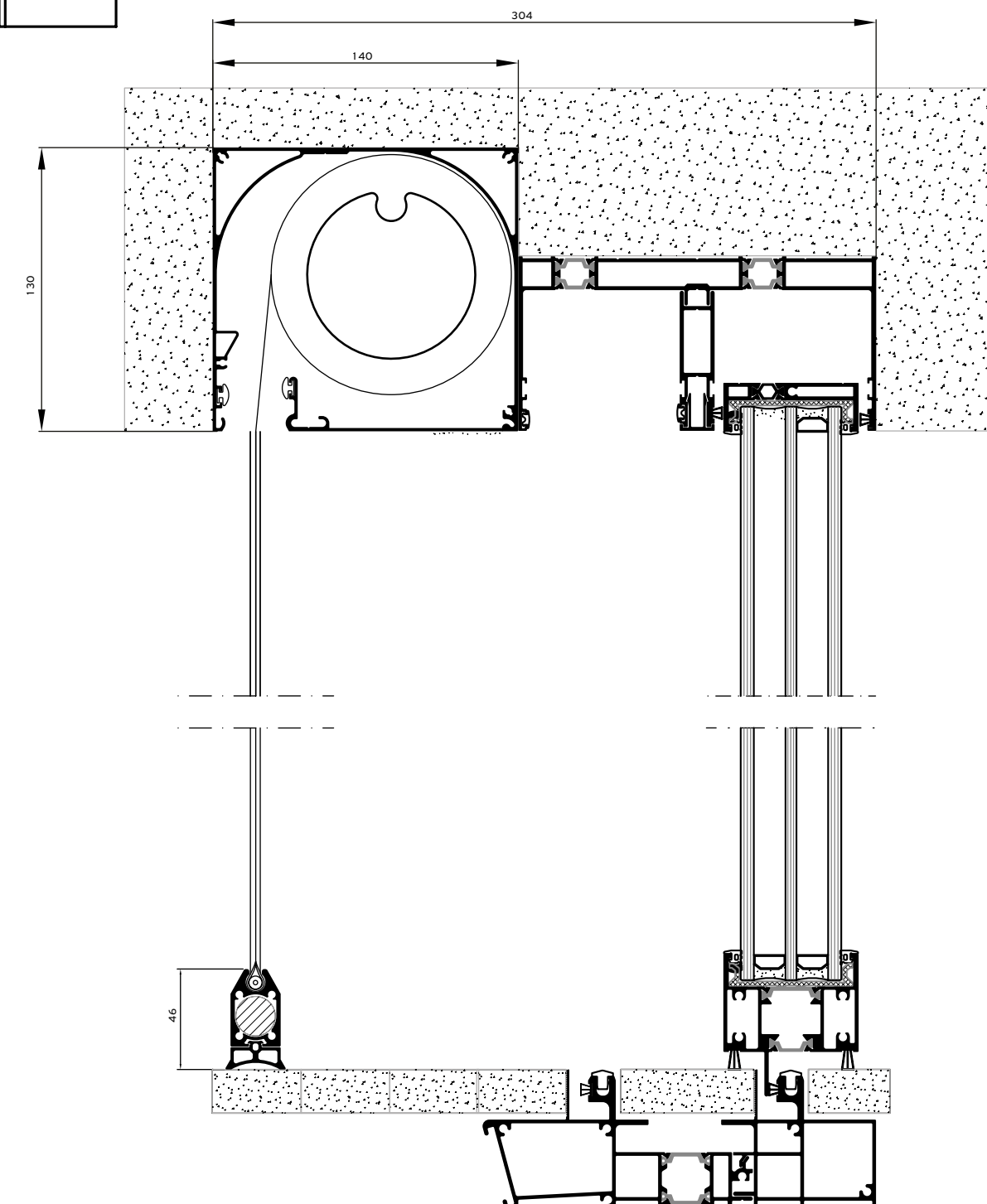
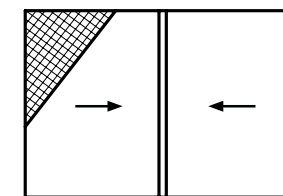

Alumil SUPREME
S650 ECLIPSE

2 Sashes / 2 Track / Integrated Flyscreen IFS

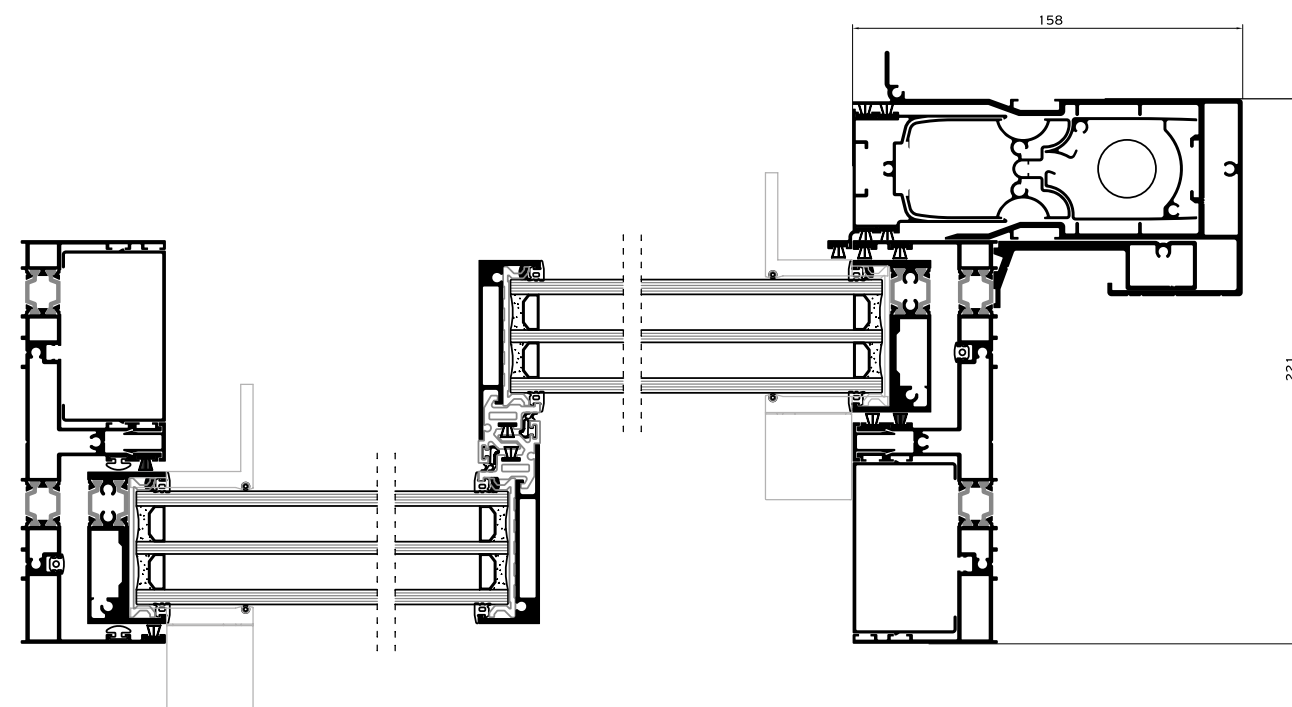
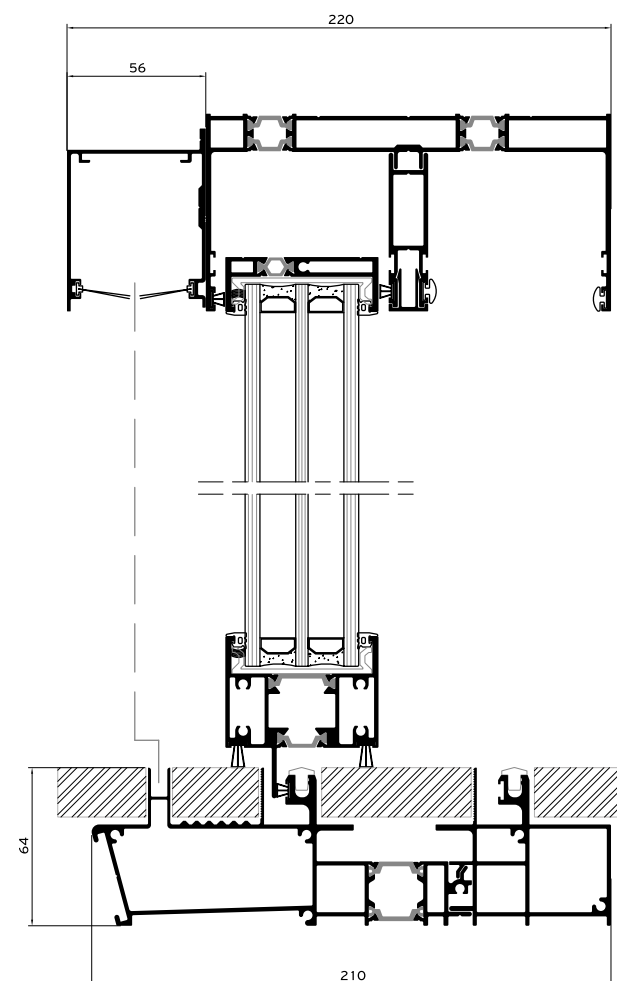
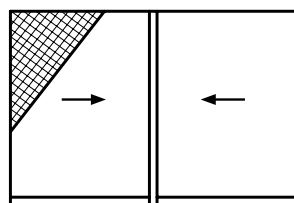

Alumil SUPREME
S650 PHOS

2 Sashes / 2 Track / Integrated Flyscreen IFS Low Threshold

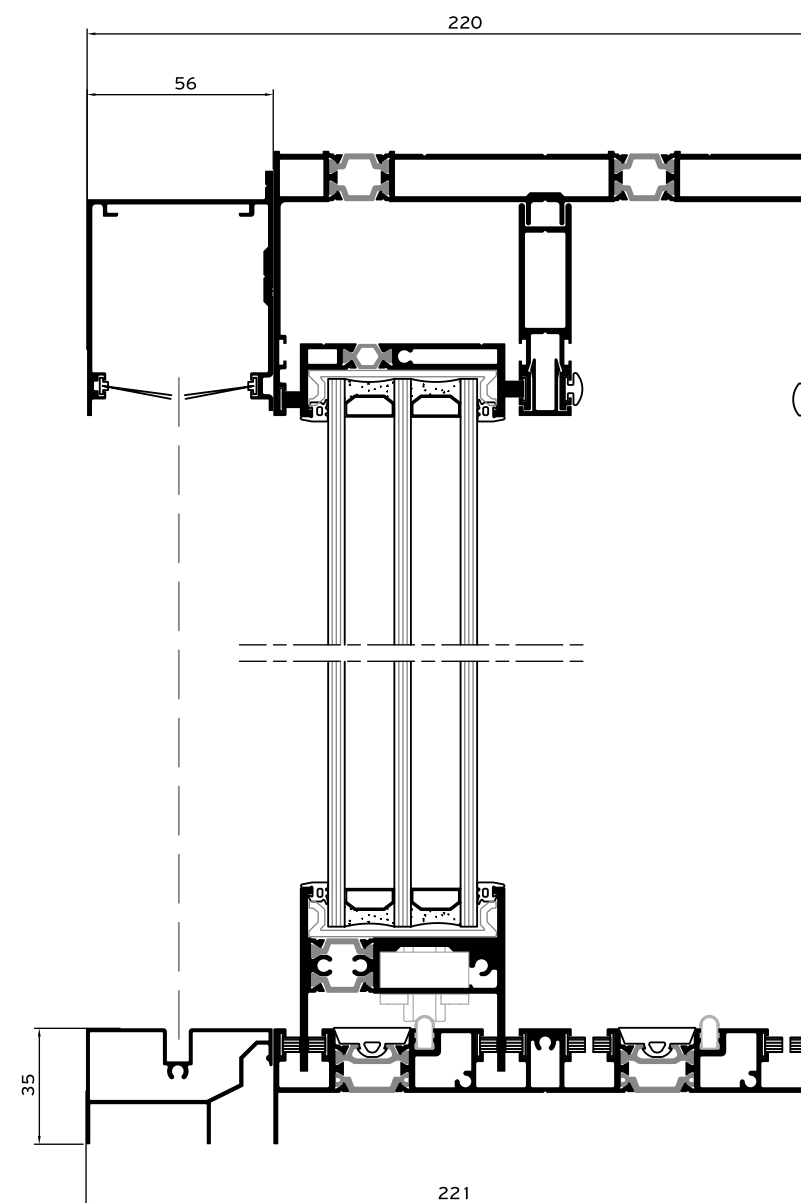
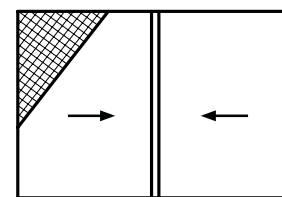

STIFFENERS

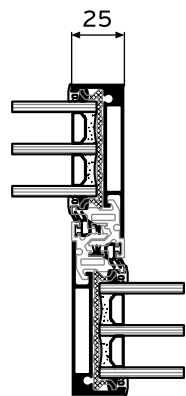

$I_x = 34,8 \text{ cm}^4$

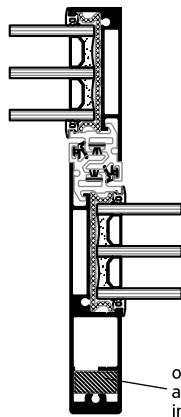

$I_x = 101,4 \text{ cm}^4$
with insert:
 $I_x = 114,1 \text{ cm}^4$

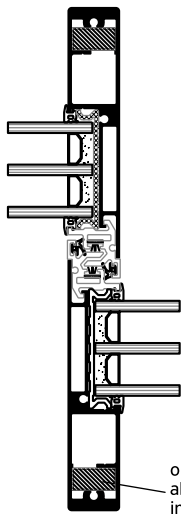

$I_x = 168 \text{ cm}^4$
with insert:
 $I_x = 193,4 \text{ cm}^4$

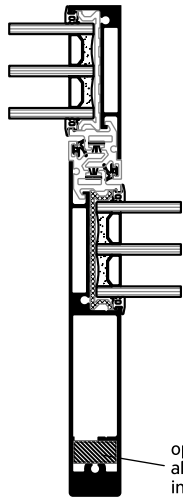

$I_x = 245,4 \text{ cm}^4$
with insert:
 $I_x = 267,4 \text{ cm}^4$

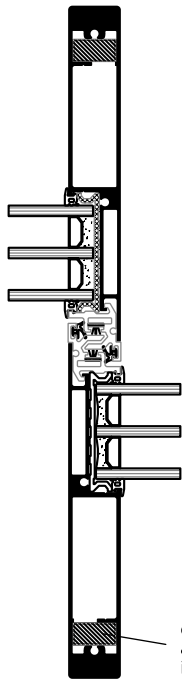

$I_x = 456 \text{ cm}^4$
with insert:
 $I_x = 500 \text{ cm}^4$

GLAZING TYPES

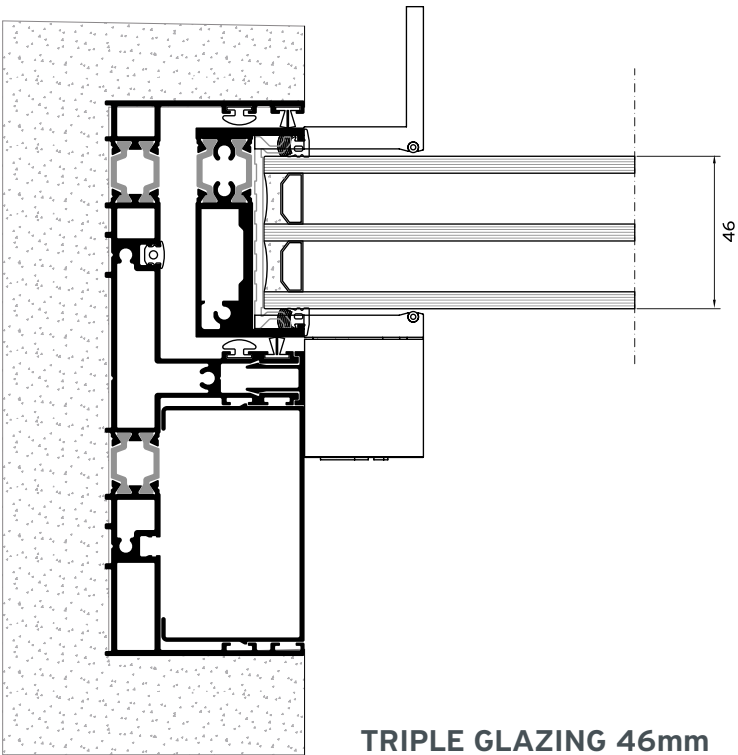



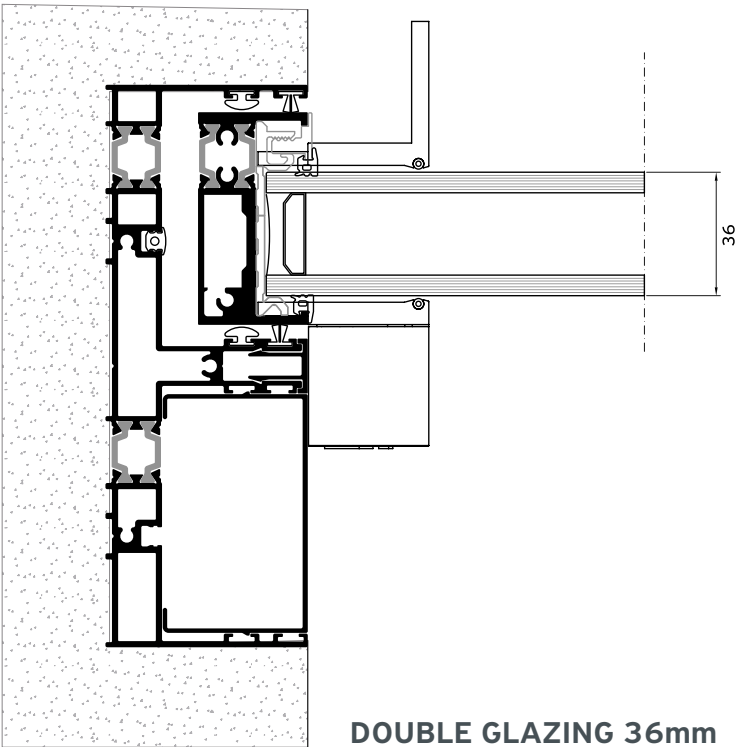



TRIPLE GLAZING 46mm

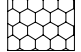
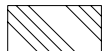

DOUBLE GLAZING 36mm

Installation

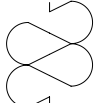
SIDE SECTION

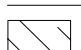
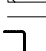
	PRECOMPRESSED MULTI-FUNCTION SEALING TAPE
	BACKER ROD
	HYBRID SEALANT OR NEUTRAL SILICONE
	STYRODUR HIGH DENSITY BOARD
	MARBLE
	POLYURETHANE FOAM
	POLYSTYRENE
	WALL CONSTRUCTION
	WALL FINISH
	REINFORCED CONCRETE
	AIR WATER VAPOR BARRIER TAPE

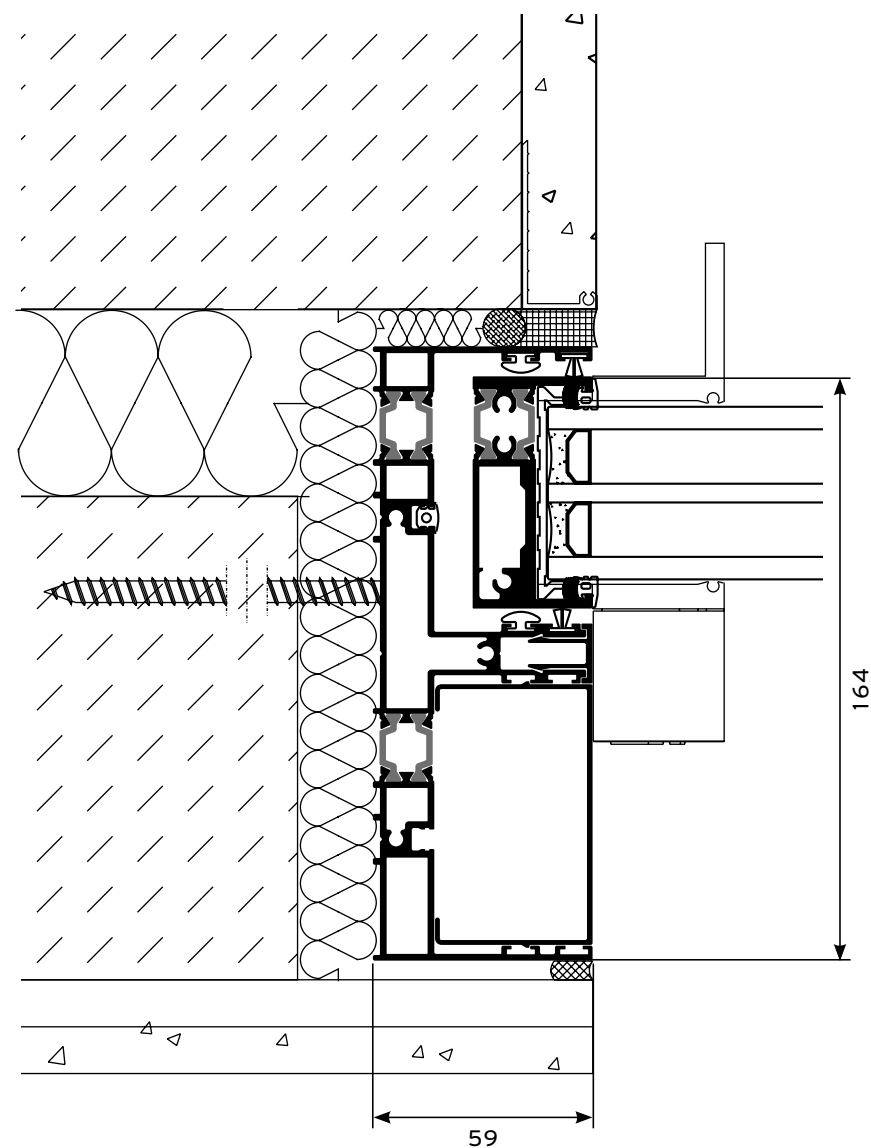

TOP SECTION

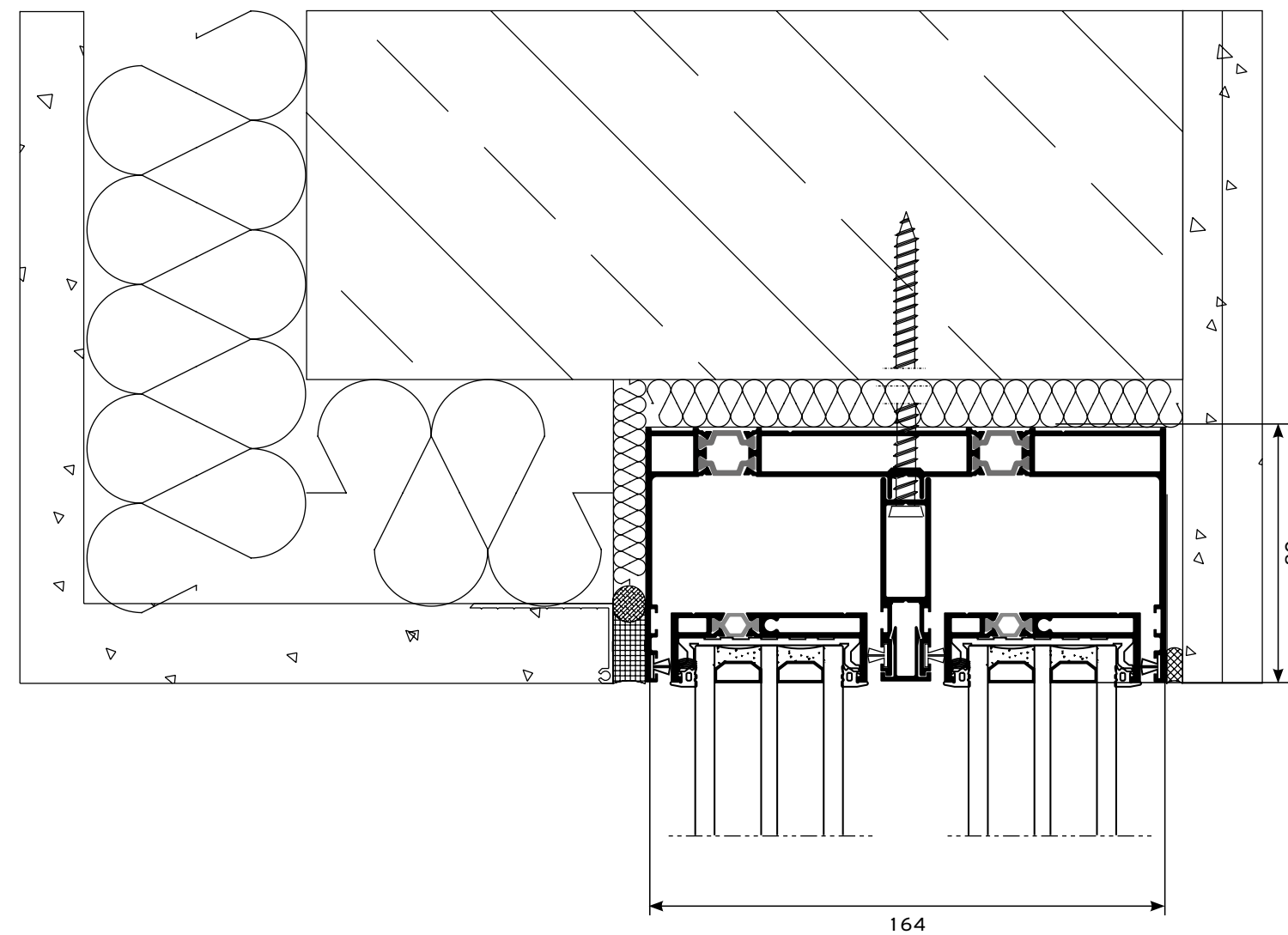

Installation

BOTTOM SECTION WITH GUTTER

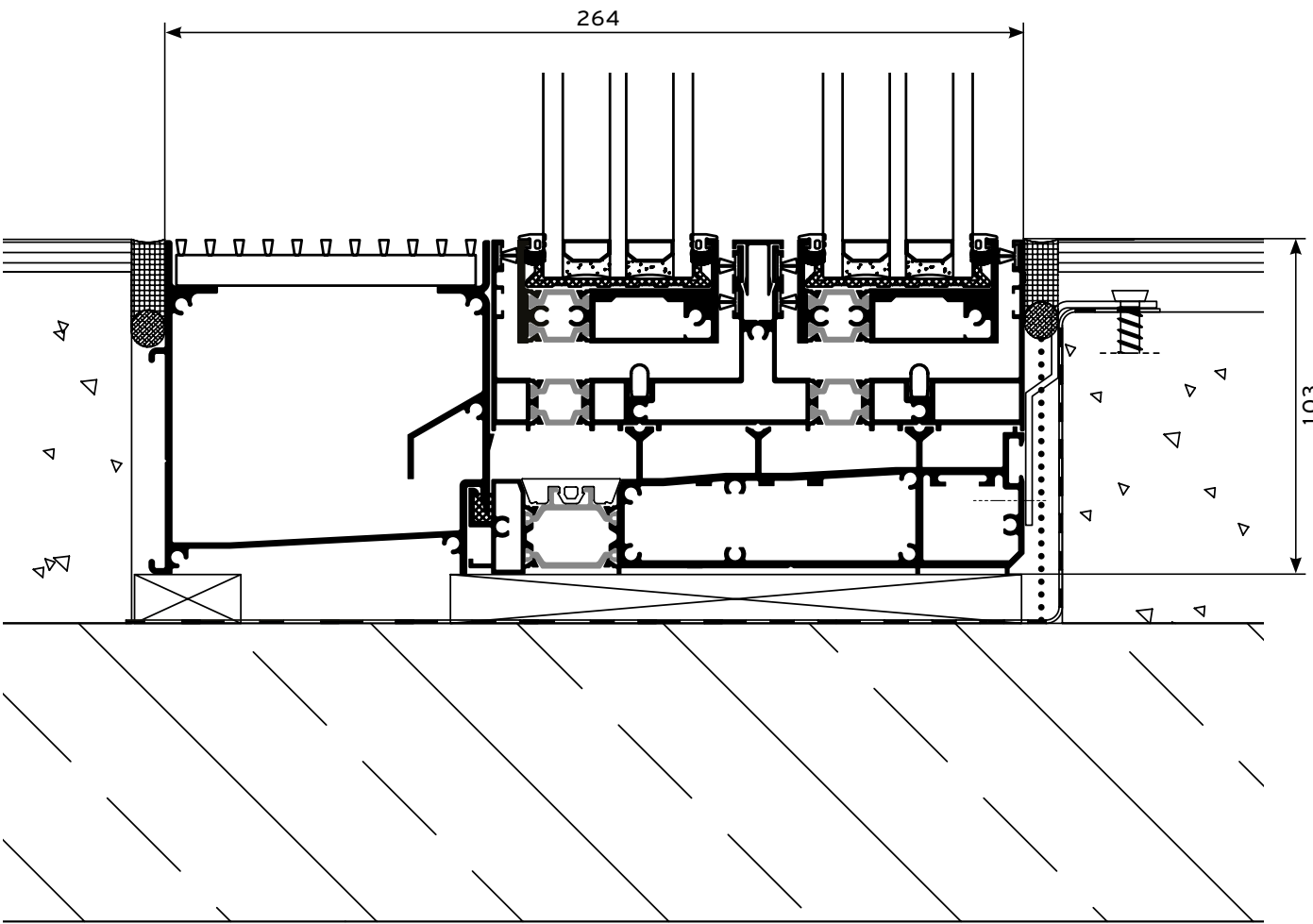

BOTTOM SECTION ECLIPSE

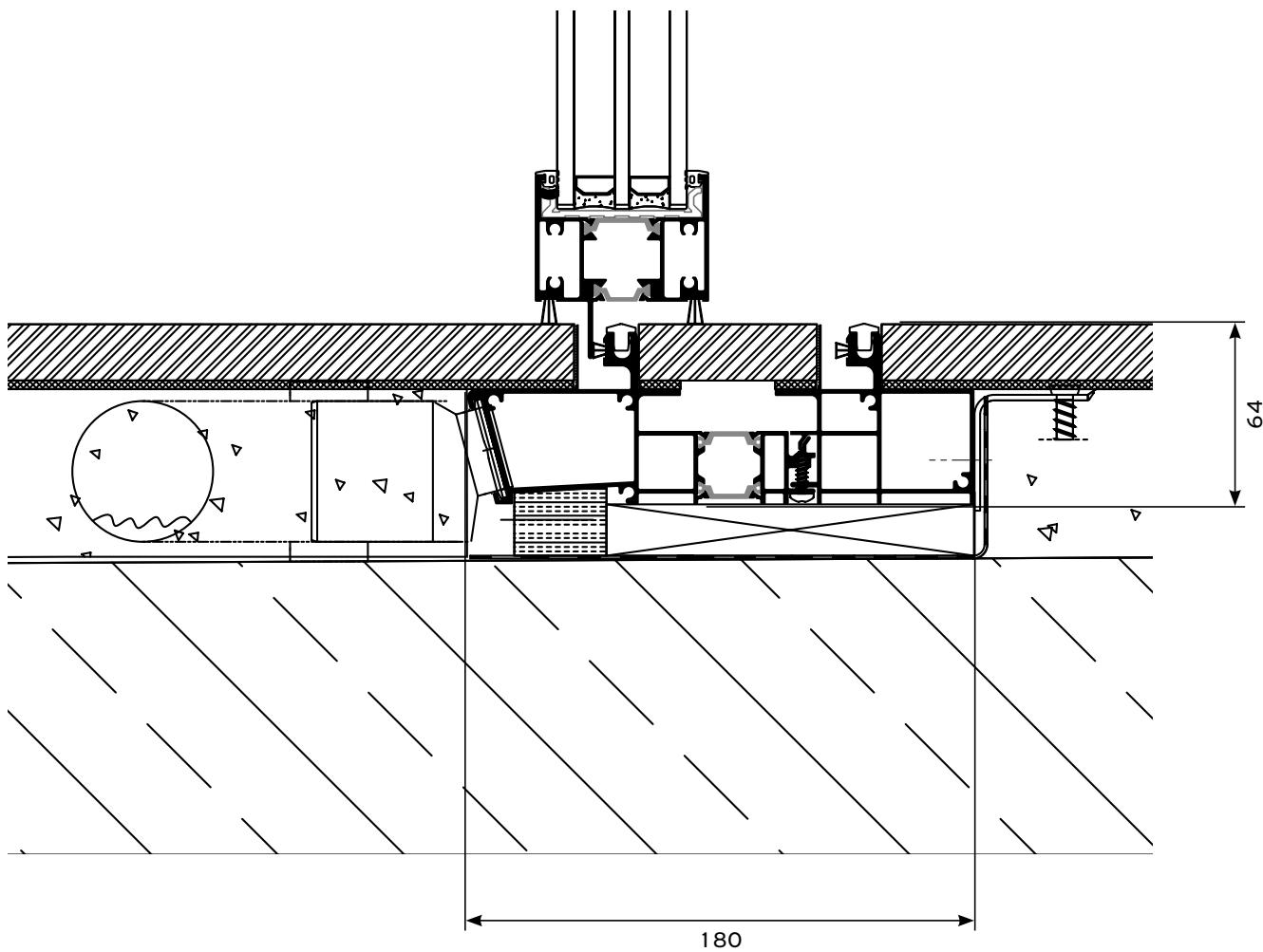

Installation

BOTTOM SECTION WITH LOW TRACK A

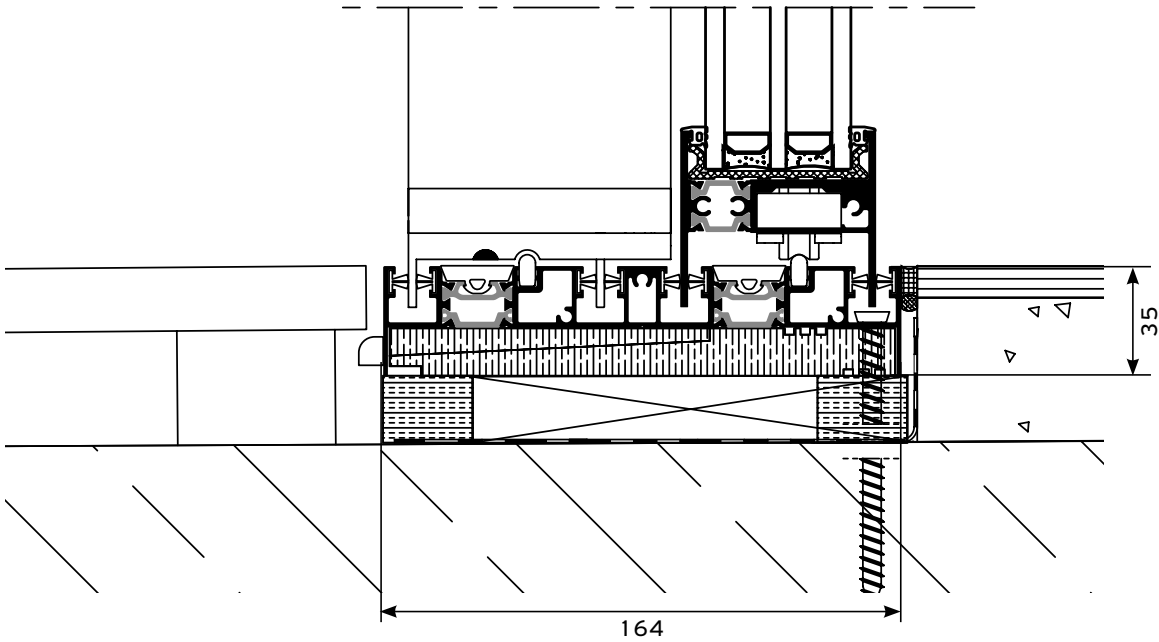

BOTTOM SECTION WITH LOW TRACK C

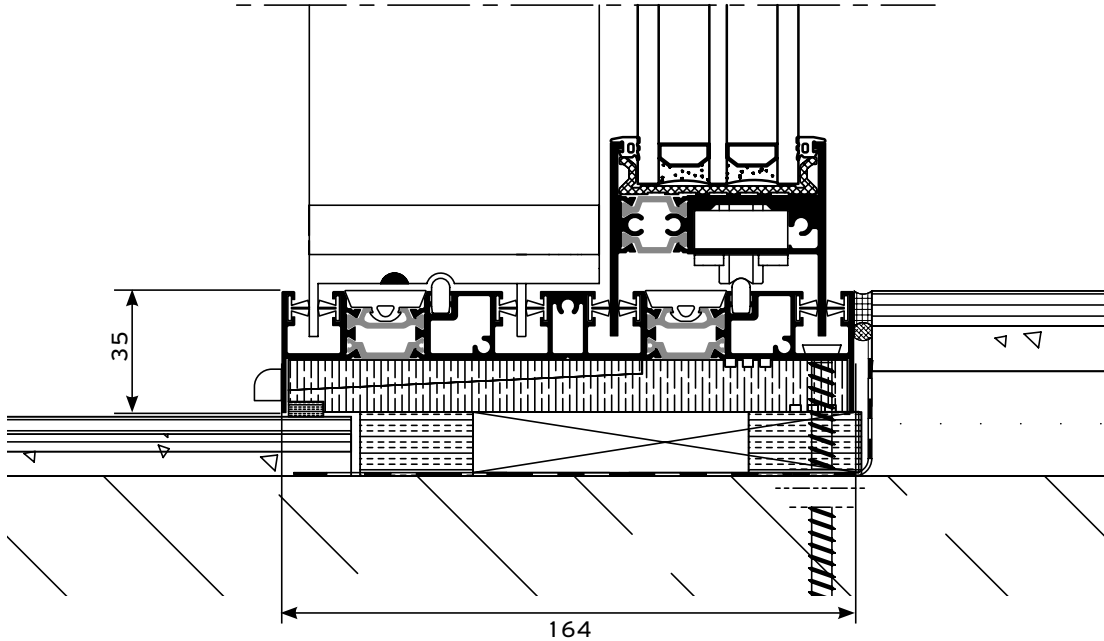

BOTTOM SECTION WITH LOW TRACK B

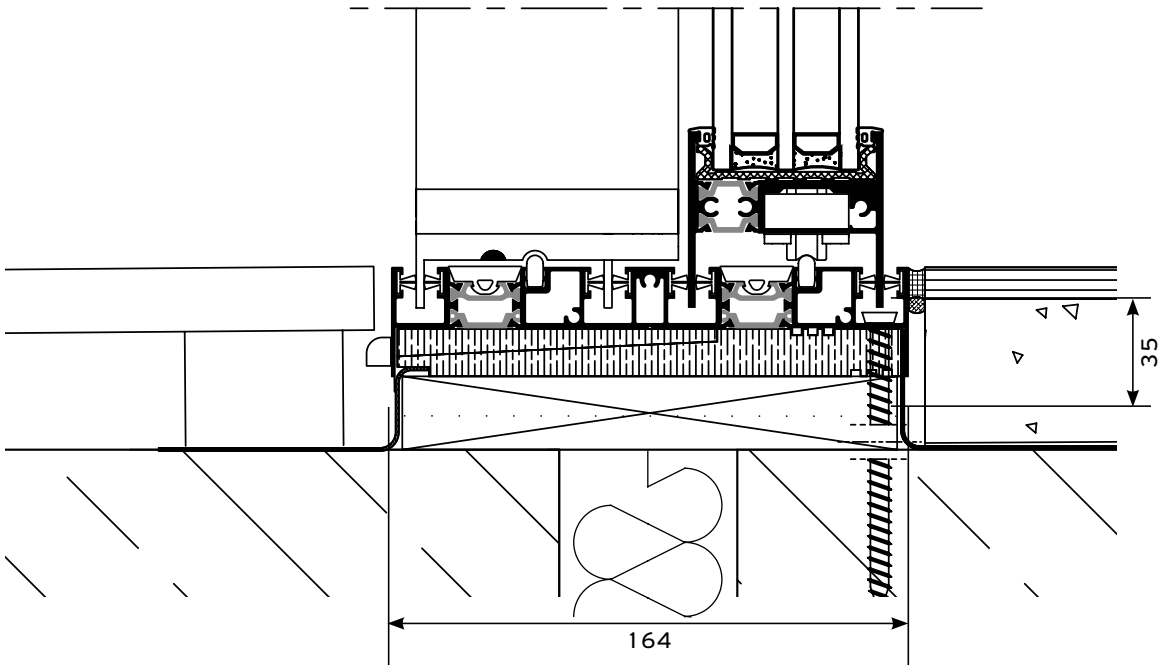

BOTTOM SECTION WITH LOW TRACK D

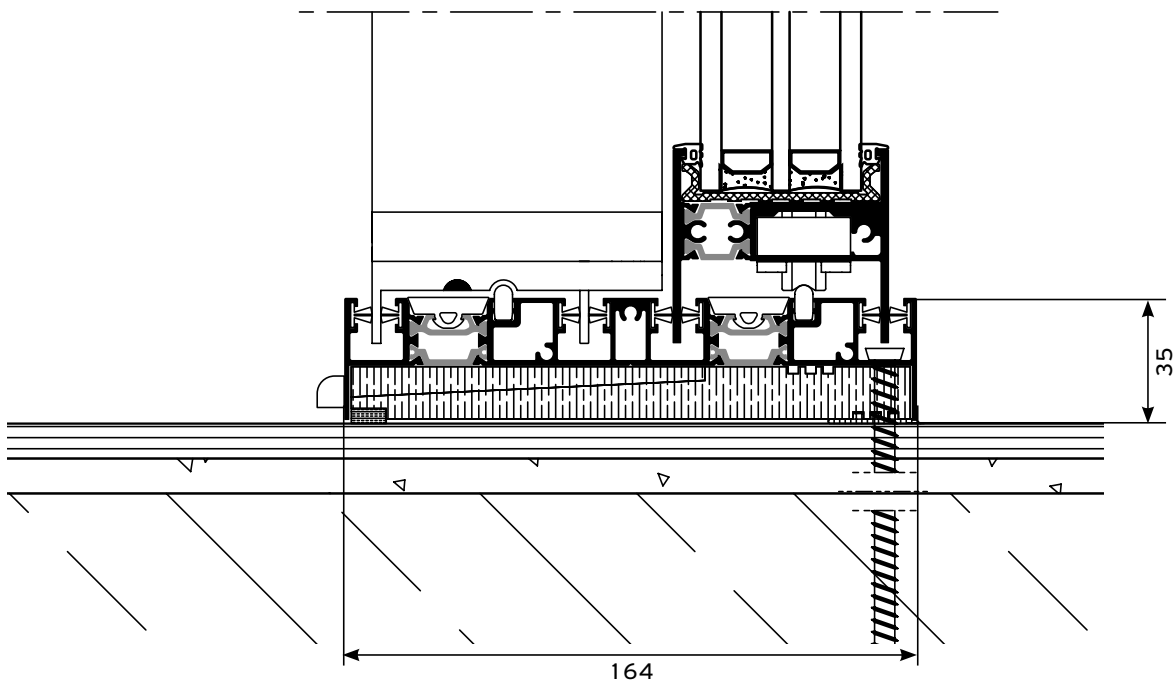

Installation

BOTTOM SECTION WITH INTEGRATED FLYSCREEN IFS

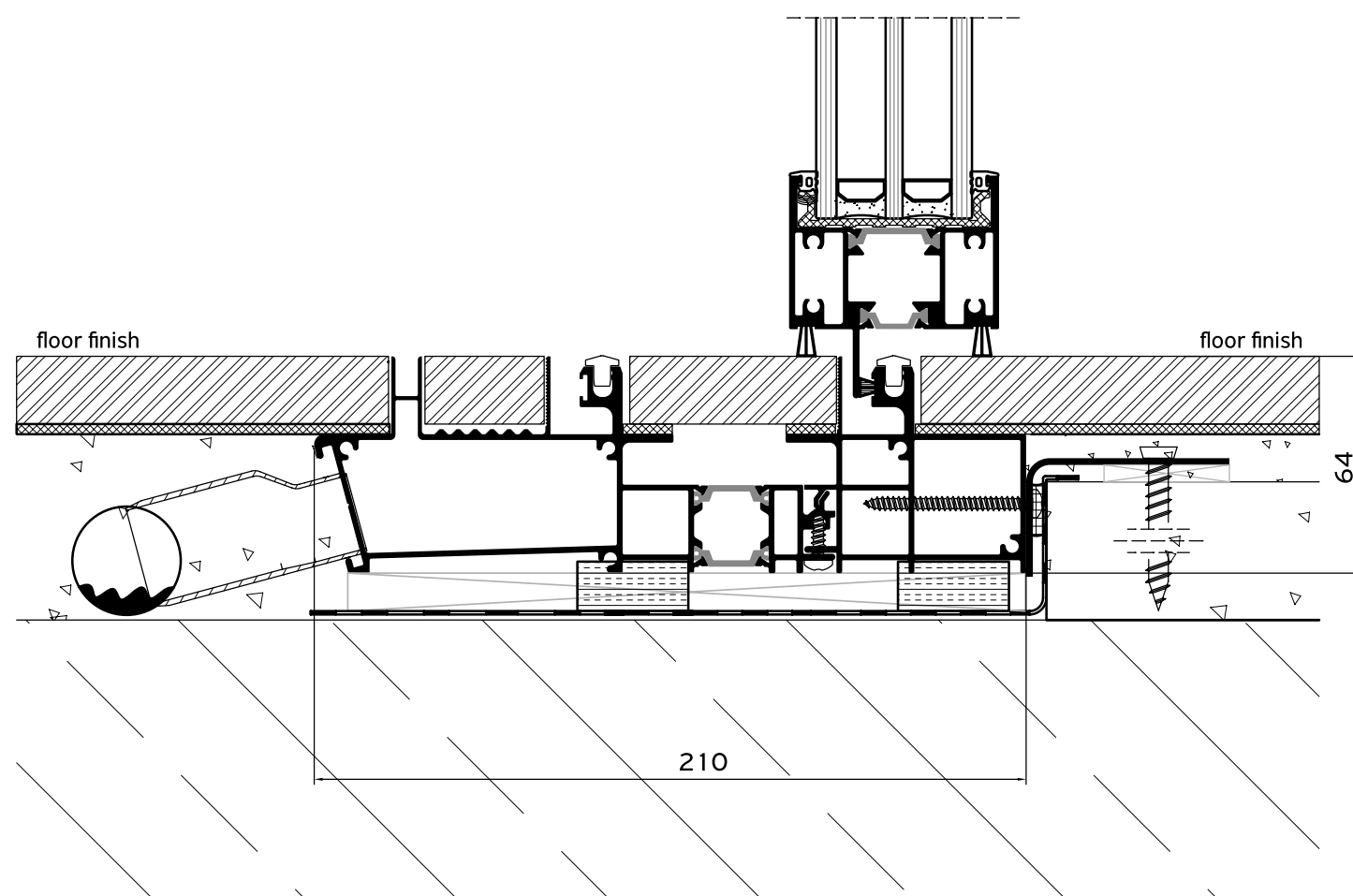

BOTTOM SECTION WITH INTEGRATED FLYSCREEN IFS
LOW THRESHOLD

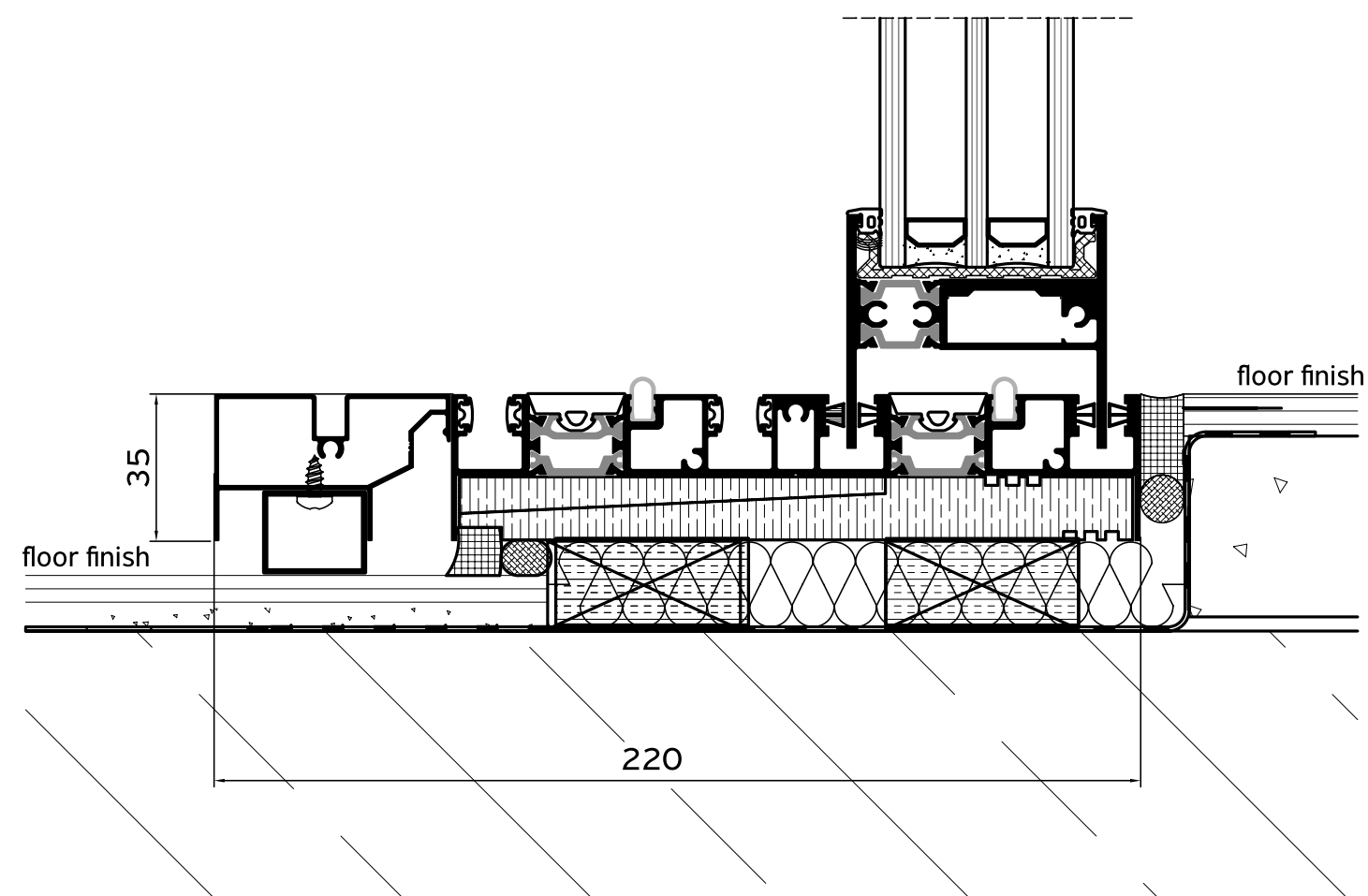

Installation

TOP SECTION WITH INTEGRATED FLYSCREEN IFS

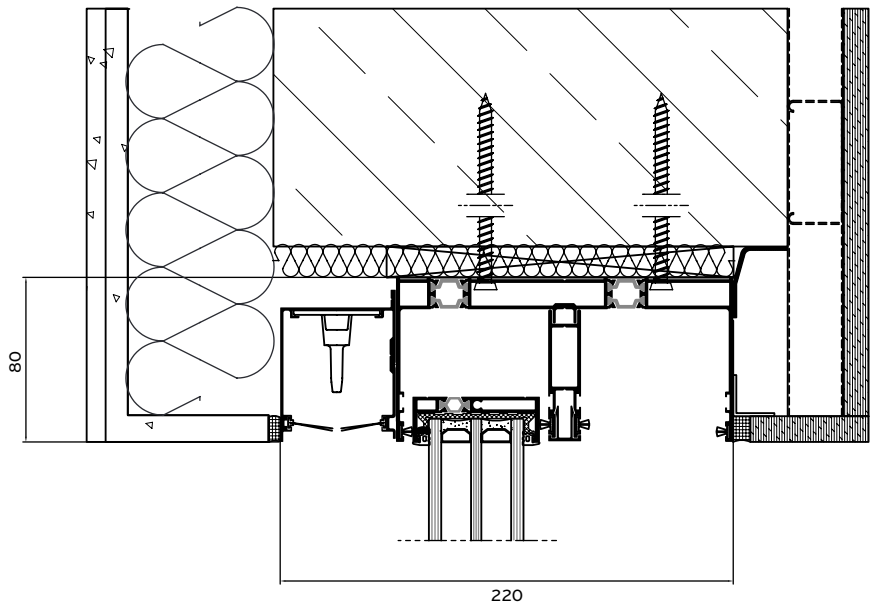

SIDE SECTION A WITH INTEGRATED FLYSCREEN IFS

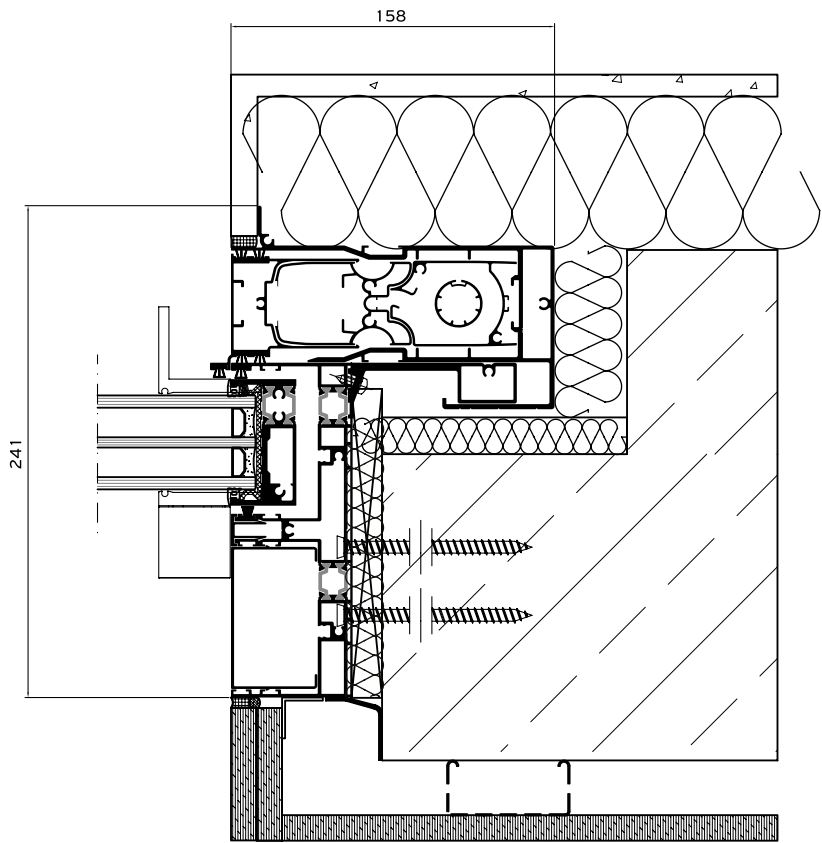

SIDE SECTION B WITH INTEGRATED FLYSCREEN IFS

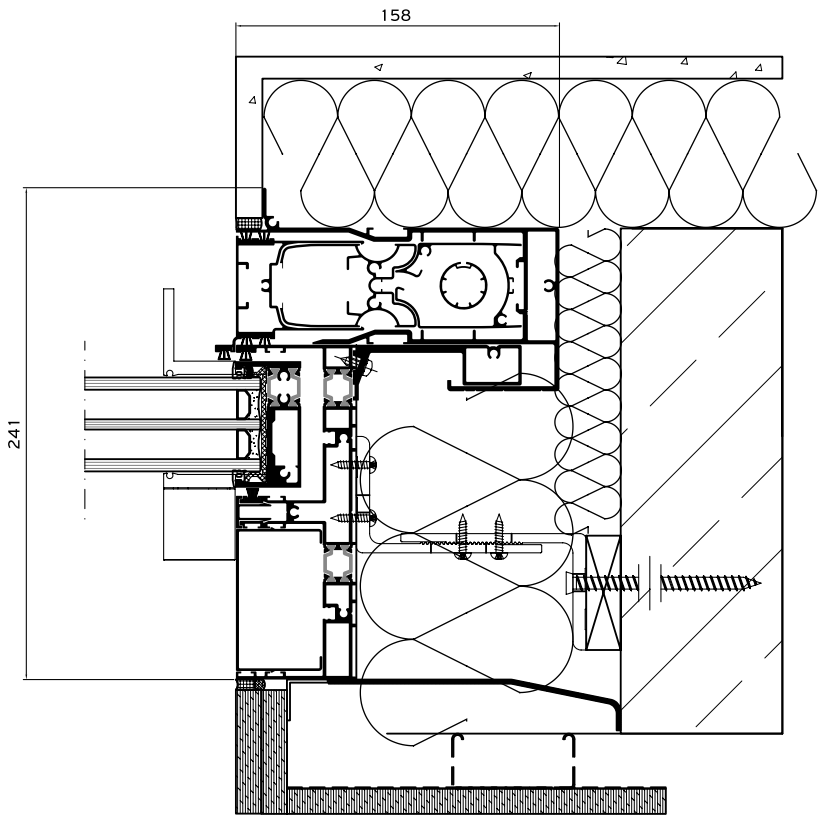

SIDE SECTION C WITH INTEGRATED FLYSCREEN IFS

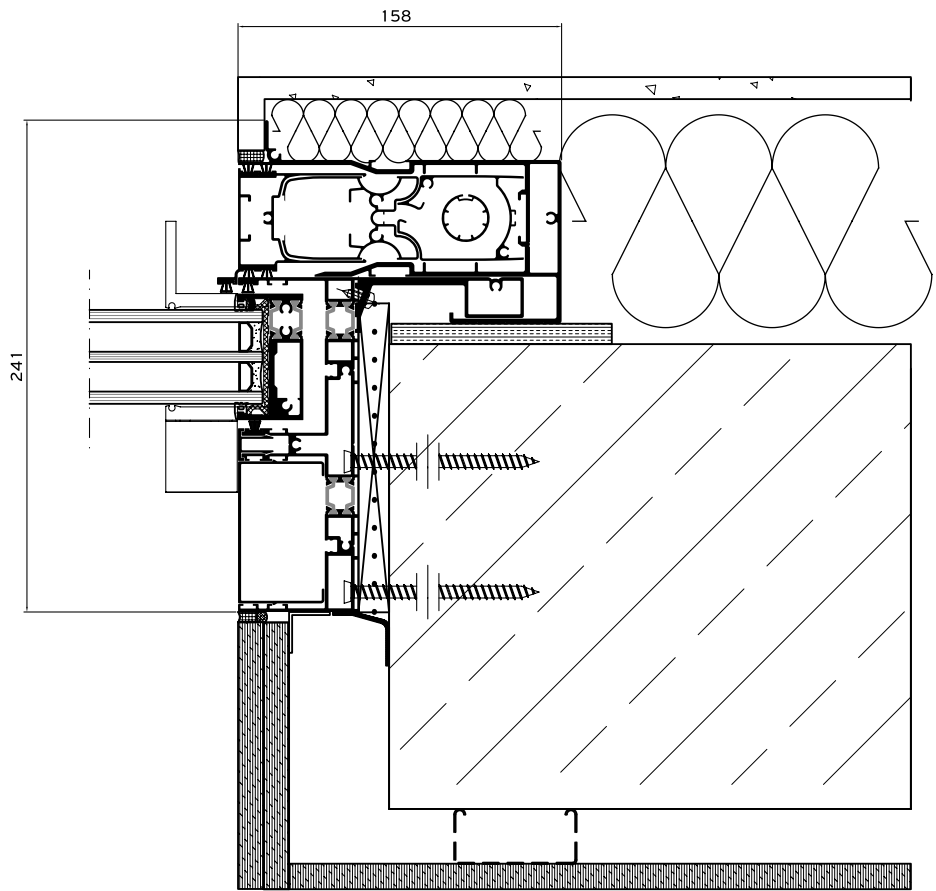







Applications

Alumil ➤ SUPREME S650 PHOS ➤ SUPREME S650 ECLIPSE



Table of performance

➤ SUPREME S650 PHOS

CERTIFICATION		CLASSIFICATION								
	WATER TIGHTNESS EN 12208	1A (0 Pa)	2A (50 Pa)	3A (100 Pa)	4A (150 Pa)	5A (200 Pa)	6A (250 Pa)	7A (300 Pa)	8A (450 Pa)	9A (600 Pa)
	AIR PERMEABILITY EN 12207	1		2			3		4	
	WIND RESISTANCE MAX TEST PRESSURE EN 12210	1 (400 Pa)		2 (800 Pa)		3 (1200 Pa)		4 (1600 Pa)		5 (2000 Pa)
	WIND LOAD RESISTANCE TO FRONTAL DEFLECTION EN 12210	A (≤ 1/150)				B (≤ 1/200)				C (≤ 1/300)
	SOUND REDUCTION EN14351	41dB								
	BURGLAR RESISTANCE EN 1627 - 1630	RC 1				RC 2			RC 3	

Alumil has also certified the systems SUPREME S650 according to AAMA & AS standards which are available upon request.

THERMAL	DIMENSIONS IN MM (w x h)	U _w in W/m² K (U _g = 0,6)	U _w in W/m² K (U _g = 0,8)	U _w in W/m² K (U _g = 1,1)
2 SASHES / 2 TRACK	2600 x 2400	1,14	1,32	1,59
2 SASHES / 2 TRACK LOW THRESHOLD	2600 x 2400	1,15	1,32	1,59
4 SASHES / 2 TRACK	5200 x 2400	1,12	1,30	1,57

Thermal performance for non-installed frames certified according to EN ISO 10077-2

REFERENCE PROJECTS

1. **PRIVATE RESIDENCE** / KOS, GREECE
2. **PRIVATE RESIDENCE** / THESSALONIKI, GREECE
3. **PRIVATE RESIDENCE** / ATHENS, GREECE
4. **SKA VILLA LAGOS** / NIGERIA, AFRICA
5. **PRIVATE RESIDENCE** / AEGINA, GREECE
6. **MAYIA EXCLUSIVE RESORT & SPA** / RHODES, GREECE



1

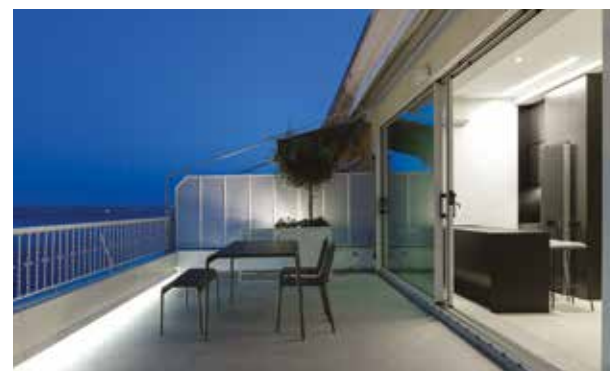

2



4



3



5



6

REFERENCE PROJECTS



7

7. EL HOUSE / CYPRUS
8. H 34 / VOULA, ATHENS
9. ALKYONIDES VILLAS / ZANTE, GREECE

10. THE LAP POOL HOUSE / TINOS, GREECE
11. HAESLEY CONDOMINIUM / SOUTH KOREA
12. ARISTOTELOUS RESIDENCE / THESSALONIKI, GREECE



10



11



8



9



12

www.alumil.com

DISCOVER MORE:



**ALUMIL
HEAD OFFICES
& SHOWROOM - THESSALONIKI**

GOGOUSI 8, EFKARPIA
THESSALONIKI - GR 56429
TEL.: +30 2313011000
E-MAIL.: info@alumil.com

**ALUMIL
HEADQUARTERS**

KILKIS INDUSTRIAL AREA
KILKIS - GR 61100
TEL.: +30 23410 79300
E-MAIL.: info@alumil.com



**ALUMIL
HEAD OFFICES
& SHOWROOM - THESSALONIKI**

GOGOUSI 8, EFKARPIA
THESSALONIKI - GR 56429
TEL.: +30 2313011000
FAX.: +30 231692473
E-MAIL.: info@alumil.com

**ALUMIL
HEADQUARTERS**

KILKIS INDUSTRIAL AREA
KILKIS - GR 61100
TEL.: +30 23410 79300
E-MAIL.: info@alumil.com

EN JAN 2025

alumil