



**Alumil**  
Building excellence every day

**Alumil**  **SMARTIA**  
**S350**



# CONTENTS

## SMARTIA S350

DESIGN PHILOSOPHY & CHARACTERISTICS	4
SENSE OF FREEDOM	8
ATTENTION TO DETAIL	12
EXPLOITING EVERY CONTEMPORARY NEED	14
SECTIONS	16
INSTALLATION	28
APPLICATIONS	32
PERFORMANCE	33
REFERENCE PROJECTS	34



### **SMARTIA S350**

is distinguished by the slim design and light profiles combined with substantial thermal insulation and high certified performances.

Slim lines,  
effortless operation

SMARTIA S350  
is a flexible insulated  
sliding system ...

with a **modern flat design**. It is ideal  
for refurbishments or renovations  
thanks to its **construction easiness**.

## DESIGN PHILOSOPHY

## @ CHARACTERISTICS



- Basic system depth 35 mm.
- Maximum visibility and natural light with only 25 mm width at the interlocking profile.
- Easy access with low threshold ideal for renovations (version SMARTIA S350 LT).
- High thermal insulation with special sash available using anti-distortion polyamides, ideal for dark frames.
- Smooth and easy gliding, thanks to inox rails.
- Wide variety of typologies, compatible with various mechanisms.

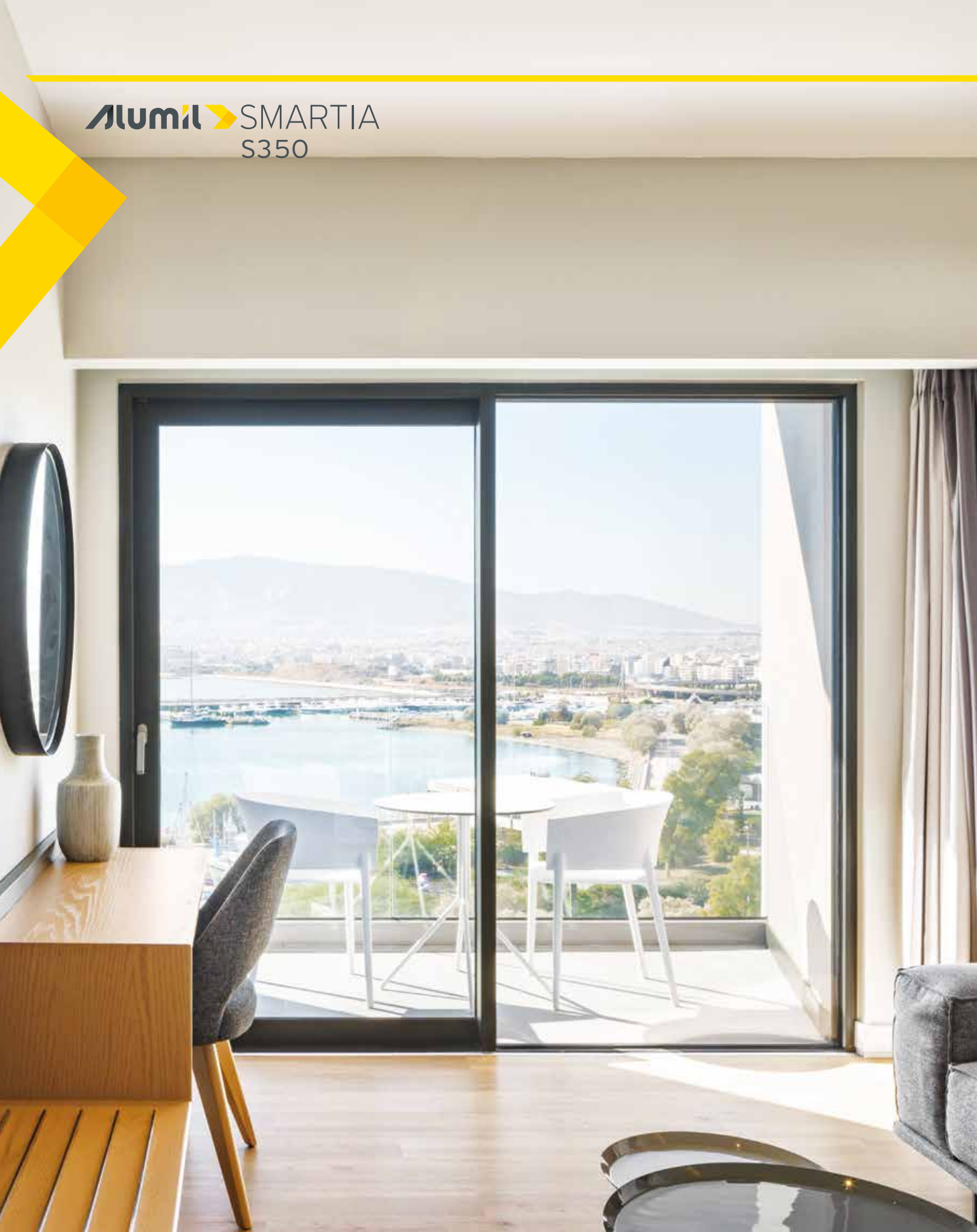

TECHNICAL

CHARACTERISTICS



VISIBLE ALUMINIUM FACE WIDTH	101 / 116 mm
FRAME HEIGHT	32 / 38 mm
FRAME WIDTH	92 mm
SASH HEIGHT	76 / 85 mm
SASH WIDTH	35 mm
INTERLOCKING PROFILE WIDTH	25 / 50,5 / 88,5 mm
SASH WEIGHT	UP TO 180 KG
GLAZING	18 UP TO 28 mm
THERMAL INSULATION	POLYAMIDES 24 mm, PVC

The ideal combination of **elegant appearance**, seamless functionality and ease of construction.

**ALTERNATIVE VERSION WITH LOW THRESHOLD:**  
for safe and easy access perfect for renovations.

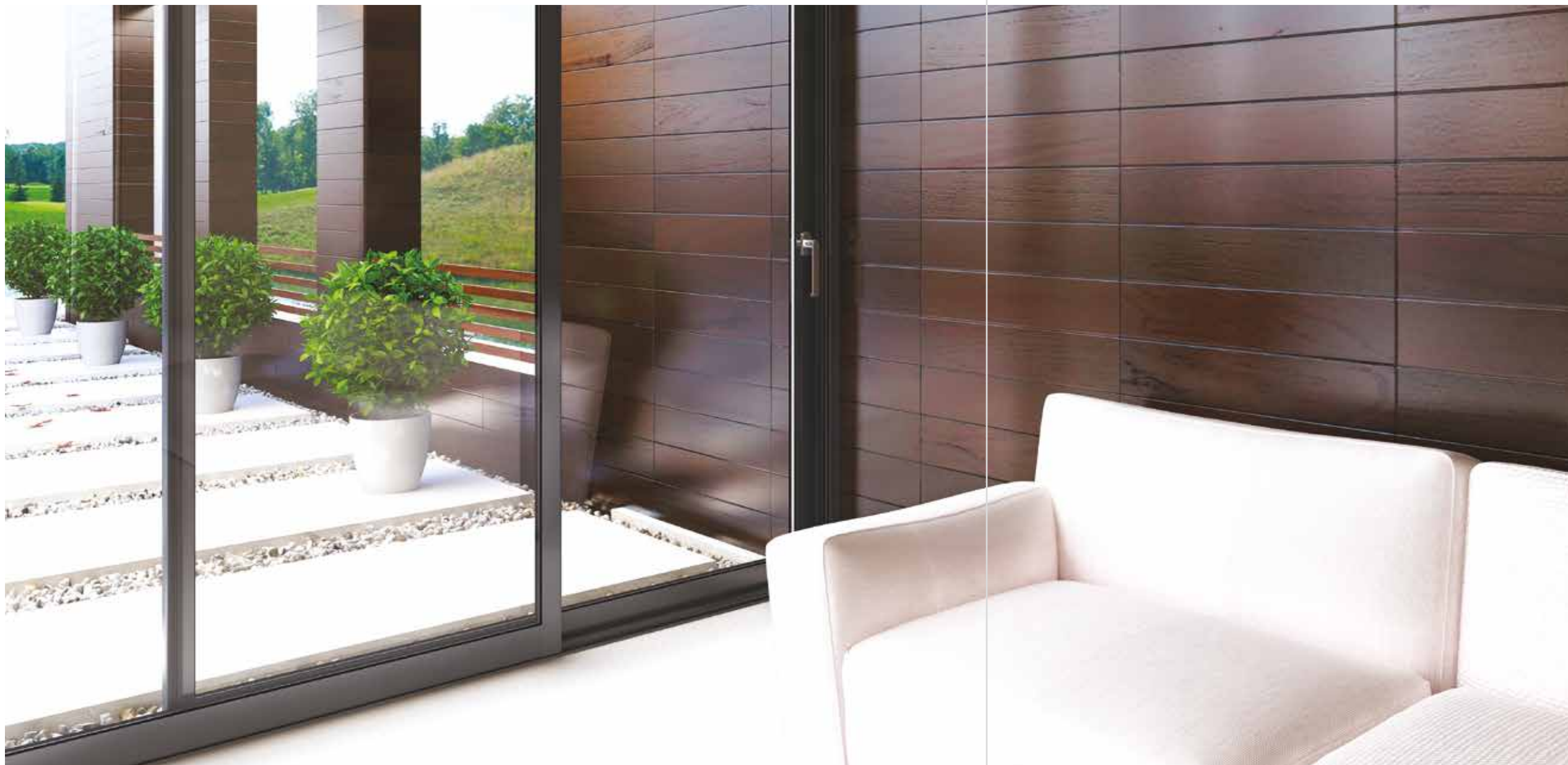

LOW THRESHOLD SMARTIA S350 LT



STANDARD THRESHOLD SMARTIA S350

**Alumil** SMARTIA  
S350

SENSE

OF FREEDOM

**Minimal design** that  
enhances visibility...

and natural light with only **25 mm**  
width at the interlocking profile.



Available interlocking profile with **integrated reinforcement** empowers the construction against high wind pressures.

**Alumil** SMARTIA  
S350

## ATTENTION

## TO DETAIL

High thermal insulation is achieved with **fiberglass reinforced polyamides**.

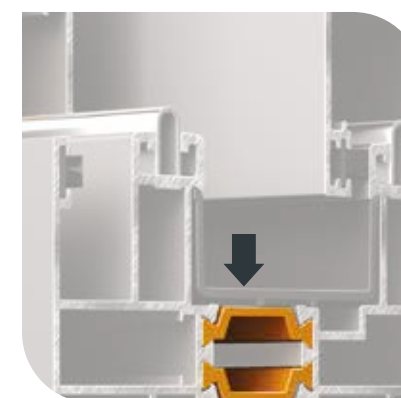

Available sash with special **anti-distortion polyamides** minimizes potential malfunctions caused by high-temperature fluctuations.



**High quality brushes** with **triple membrane** perimetrically of the sash, enhance the air permeability and watertightness.

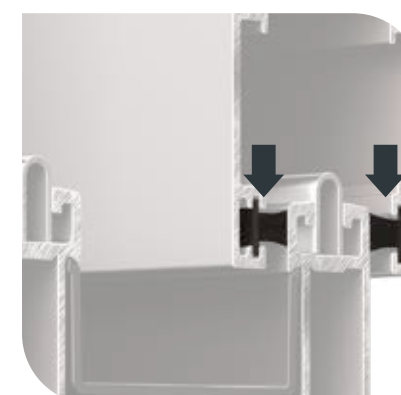

The **UV protected PVC profiles** for the track reduce the visible depth/complexity and contributes to the thermal insulation.

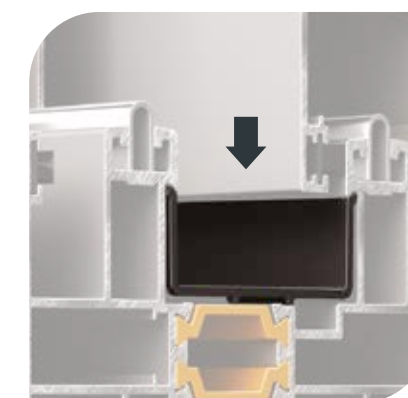

The specially designed **PVC profiles for the narrow interlocking profile** optimize air permeability and thermal insulation, enhancing energy saving.

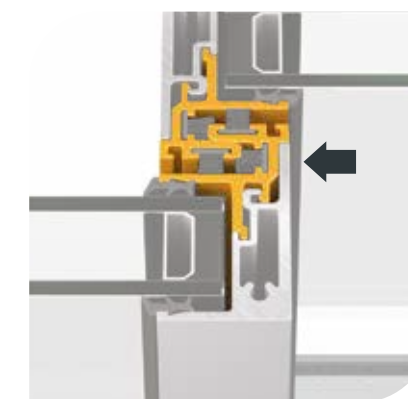

The sash glides **easily and quietly** on the rails made of stainless steel AISI 316L.

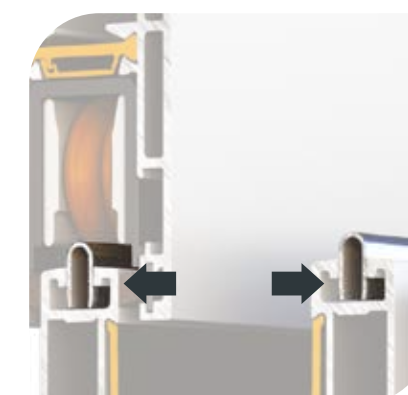

SASH PROFILES				
	S384	S390	S35011	S35013
TRACK PROFILE				
STANDARD THRESHOLD	•	•	•	•
LOW THRESHOLD	•	•	•	•
INTERLOCKING PROFILE				
NARROW 25 mm			•	
NARROW 50,5 mm	•	•		
STANDARD	•	•	•	•
ADJOINING PROFILE				
NARROW	•	•		
STANDARD	•	•	•	•
GLAZING WIDTH				
18 - 26 mm	•	•	•	•
28 mm			•	

EXPLOITING

EVERY CONTEMPORARY NEED

SMARTIA  
S350

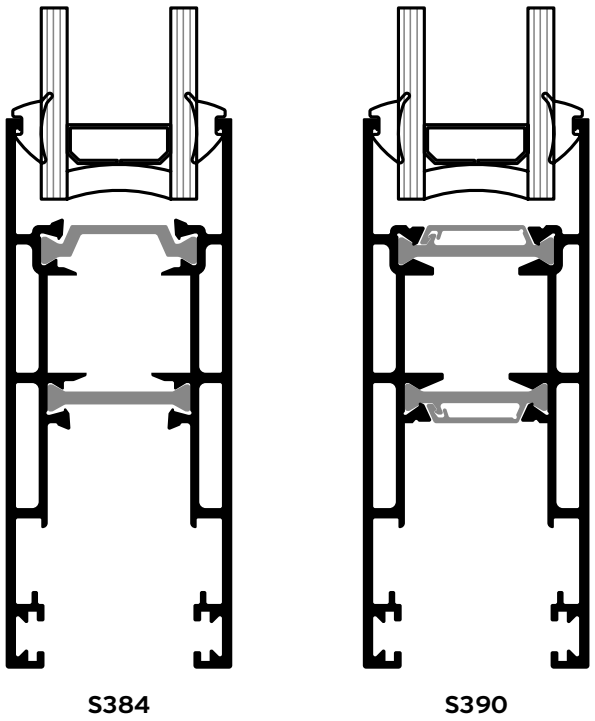

SMARTIA  
S350 LT

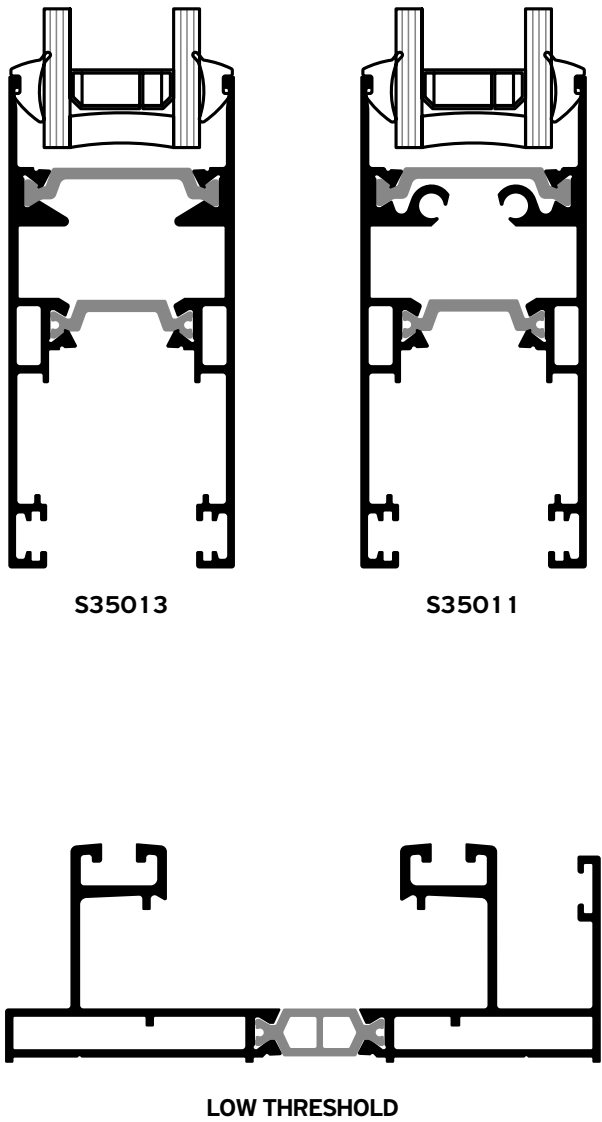

**Alumil** SMARTIA  
S350

**2 Sashes / 2 Track**

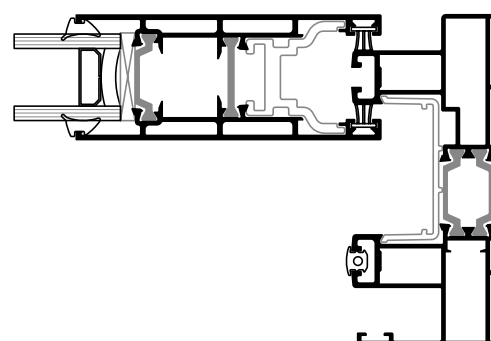
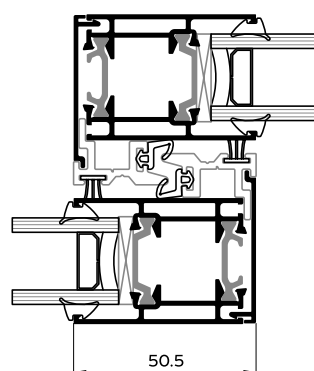
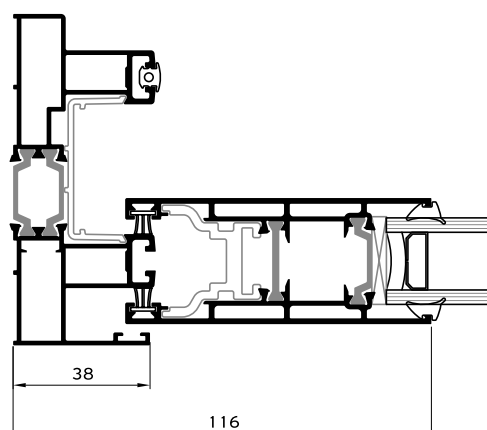
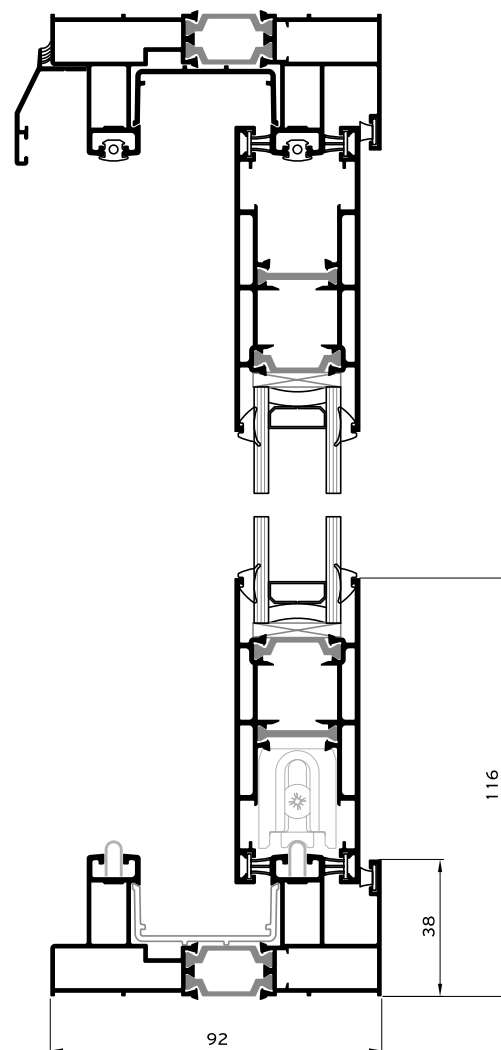
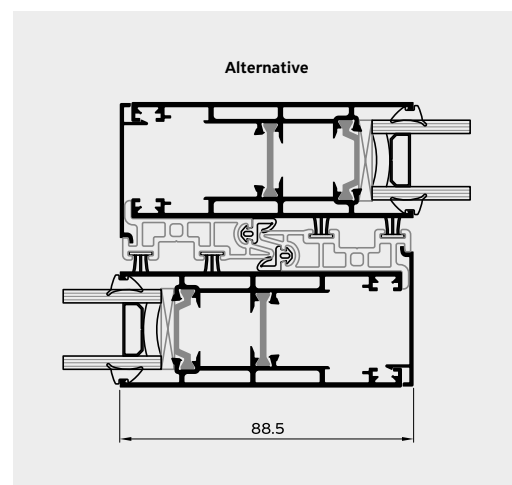
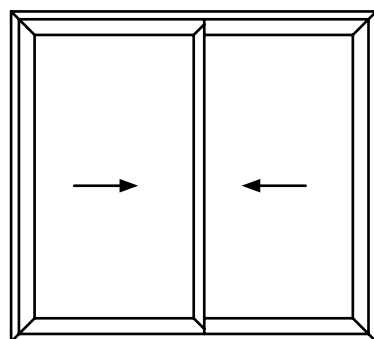

**Alumil** SMARTIA  
S350 LT

**2 Sashes / 2 Track**  
**Low Threshold**

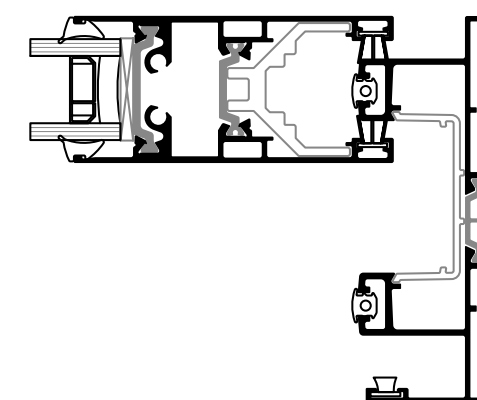
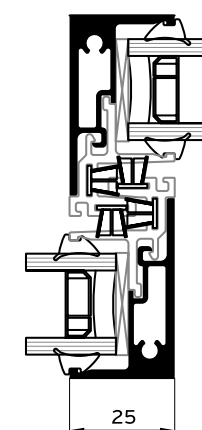
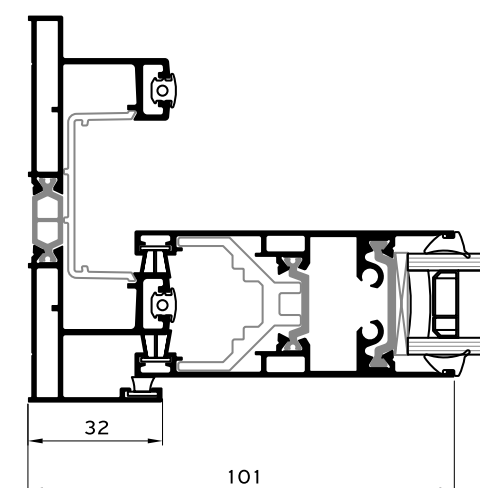
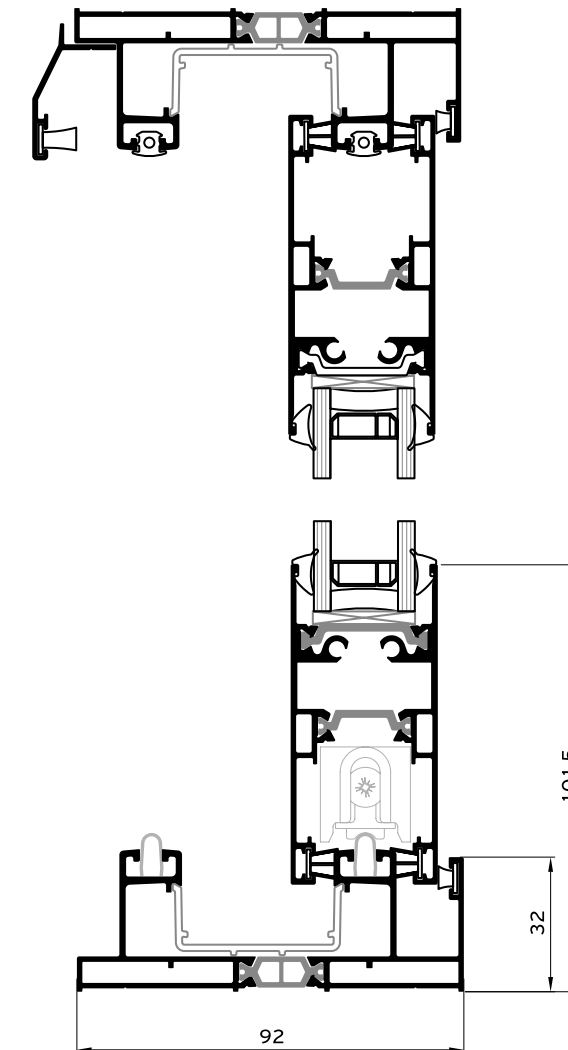
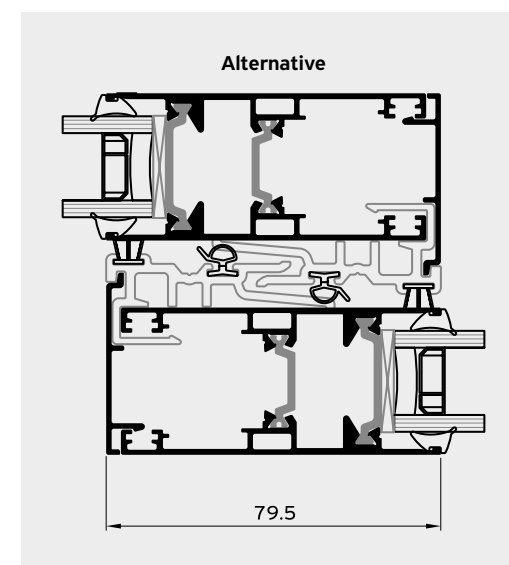
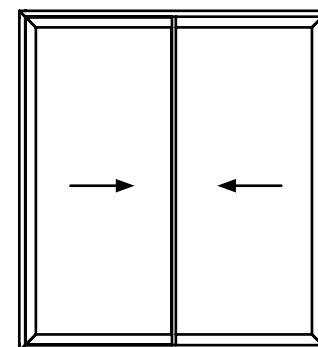

**Alumil SMARTIA S350**    **2 Sashes / 2 Track / Flyscreen**

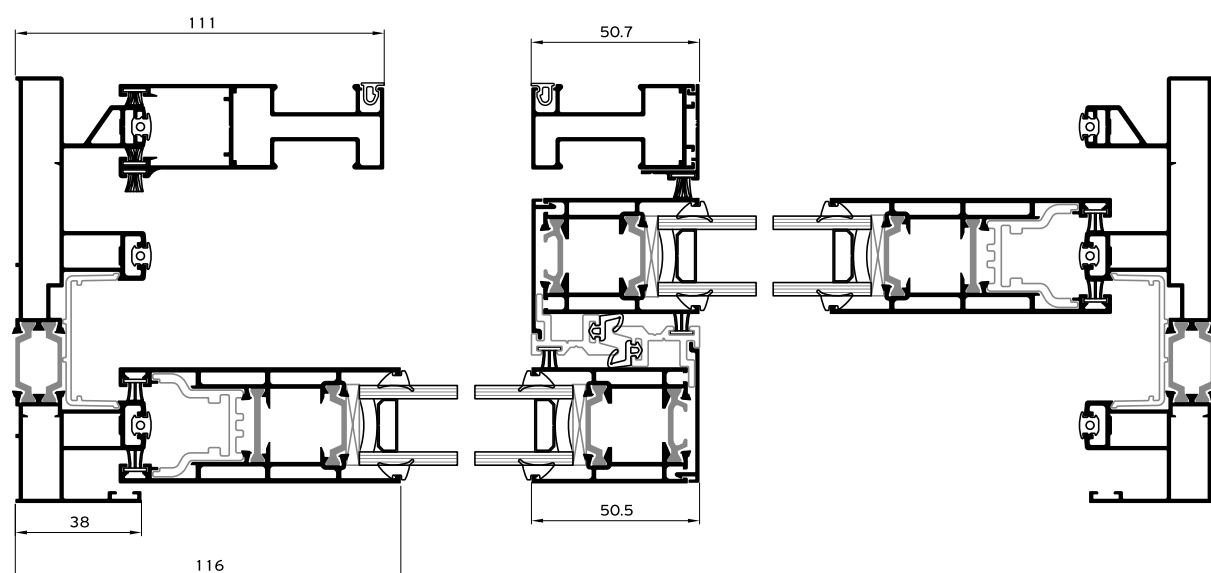
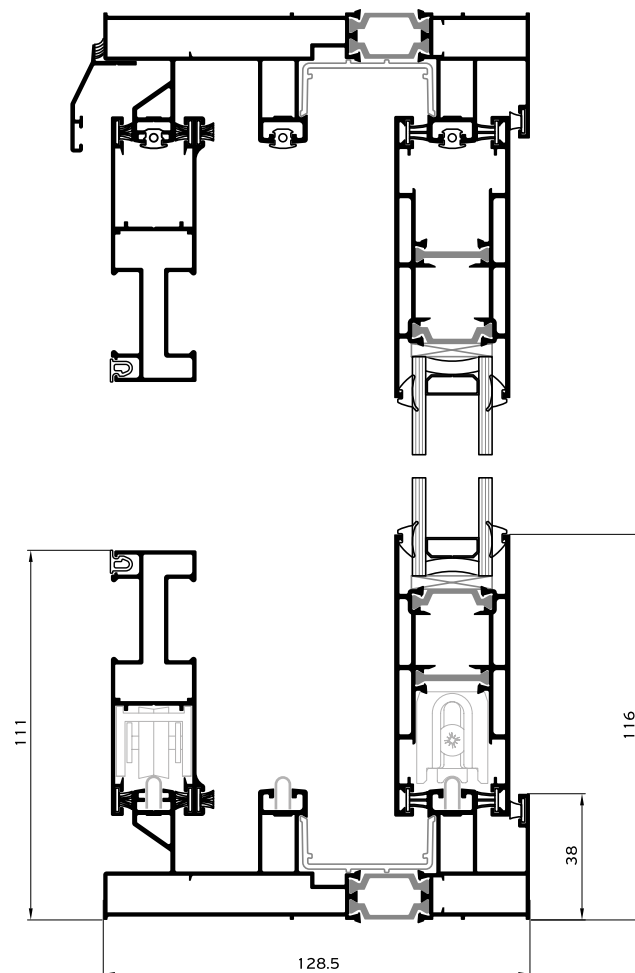
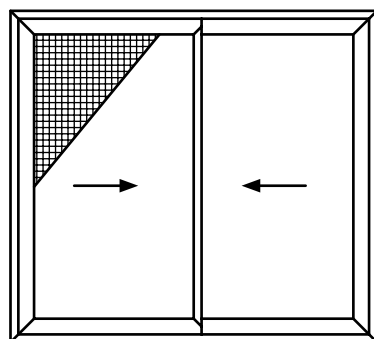

**Alumil SMARTIA S350 LT**    **2 Sashes / 2 Track / Flyscreen**  
**Low Threshold**

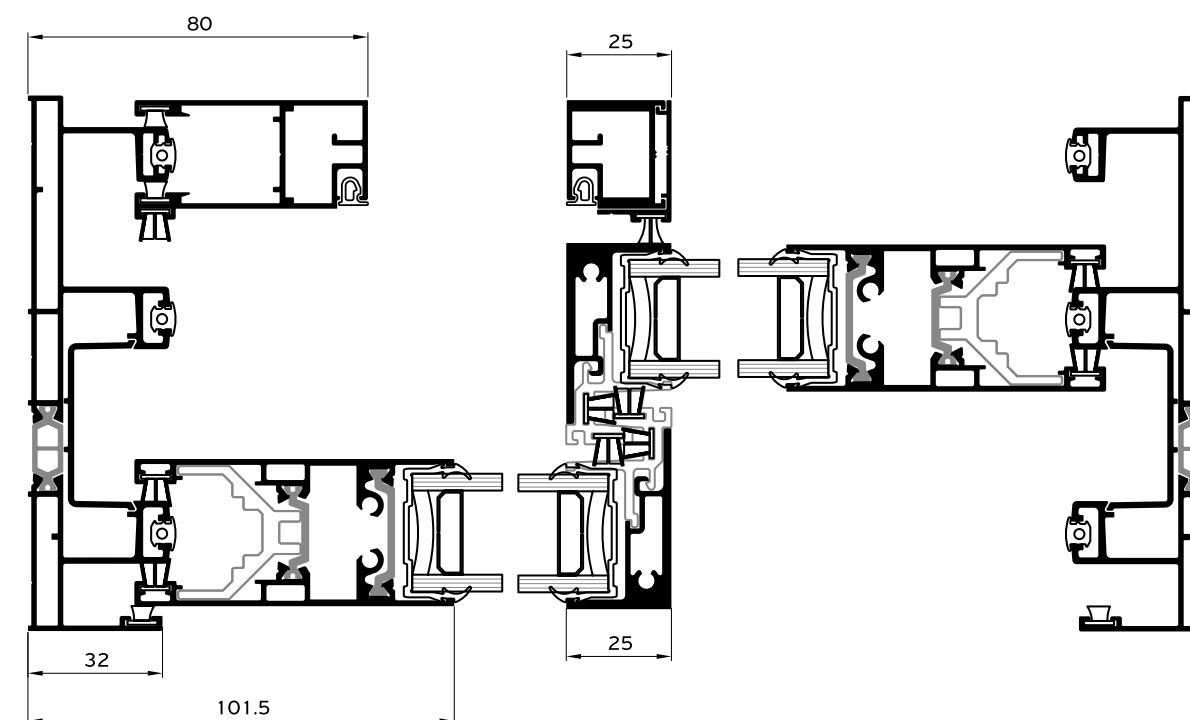
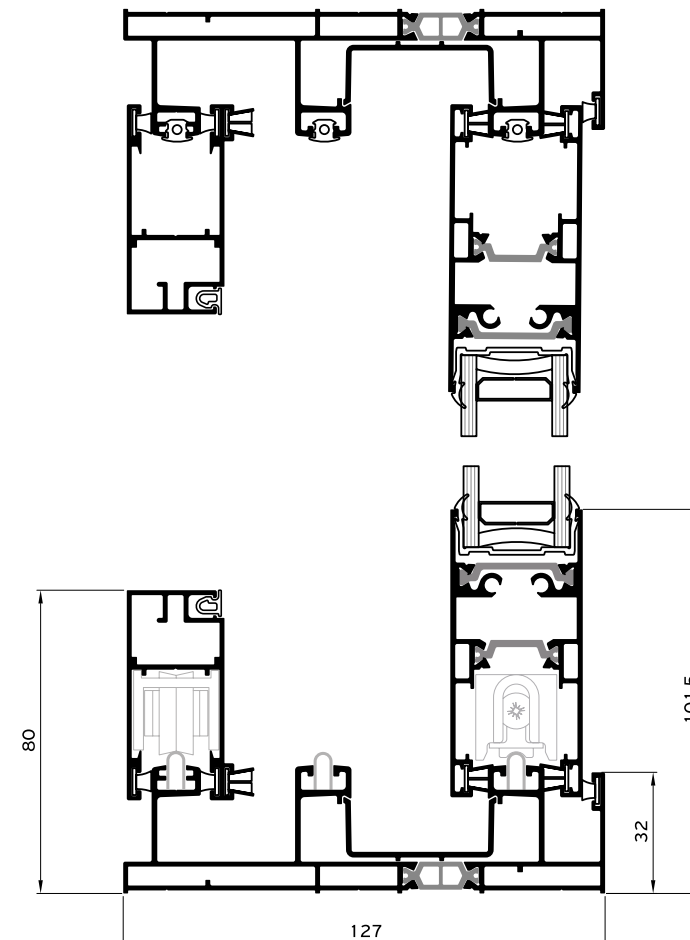
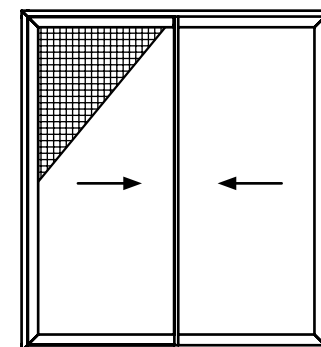

Alumil SMARTIA  
S350

3 Sashes / 3 Track

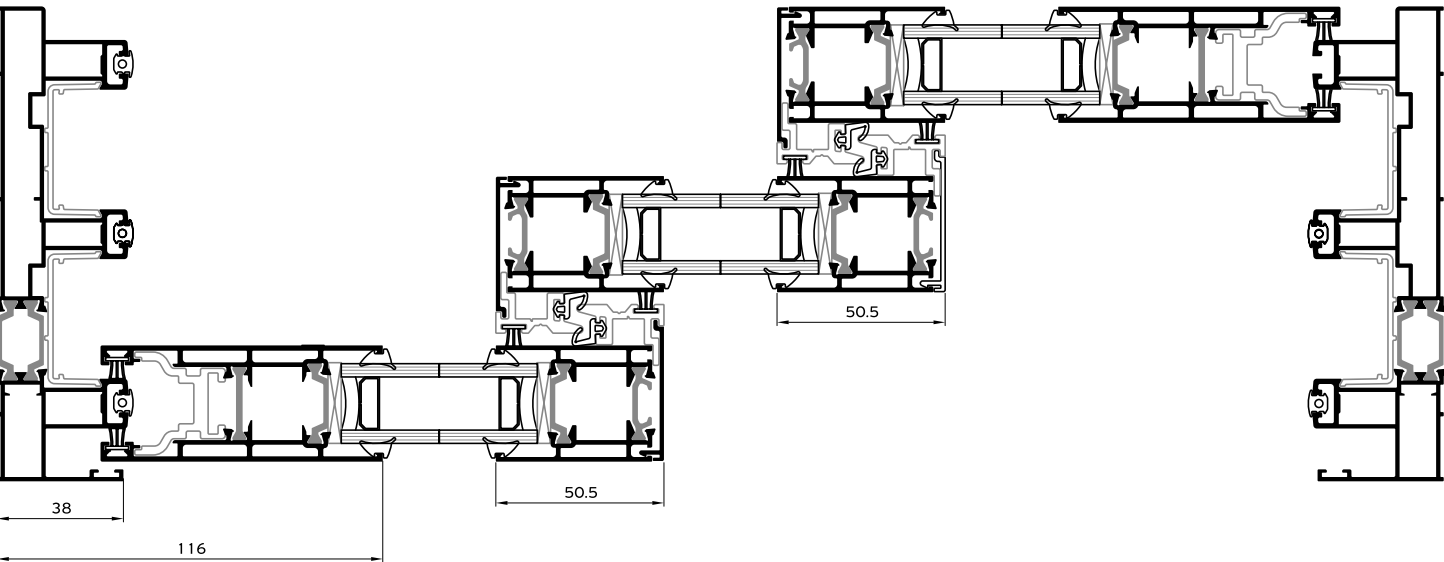
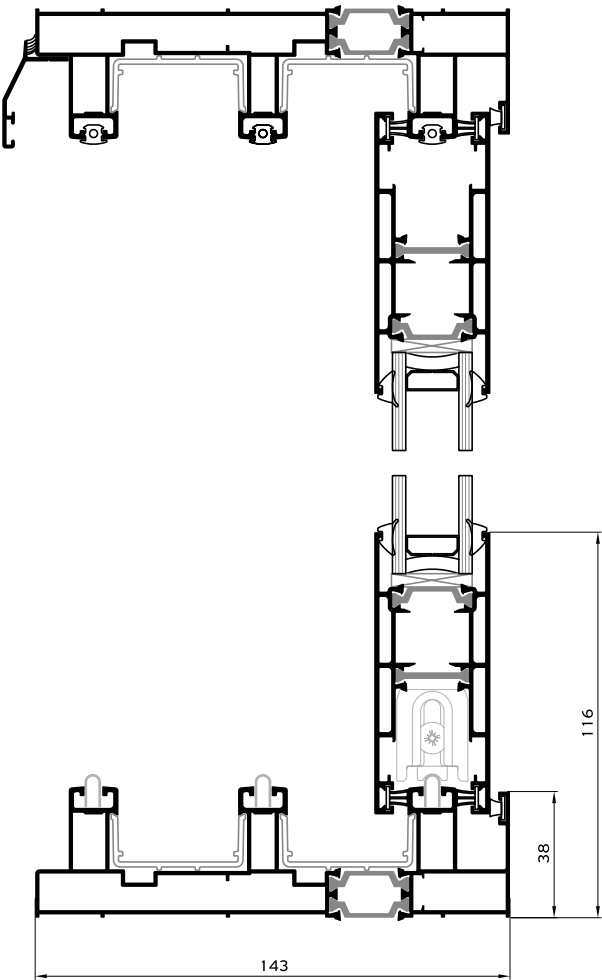
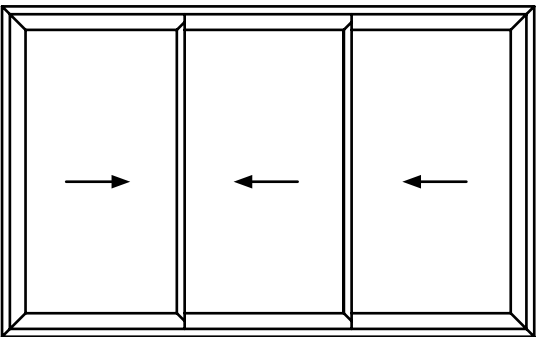

Alumil SMARTIA  
S350 LT

3 Sashes / 3 Track  
Low Threshold

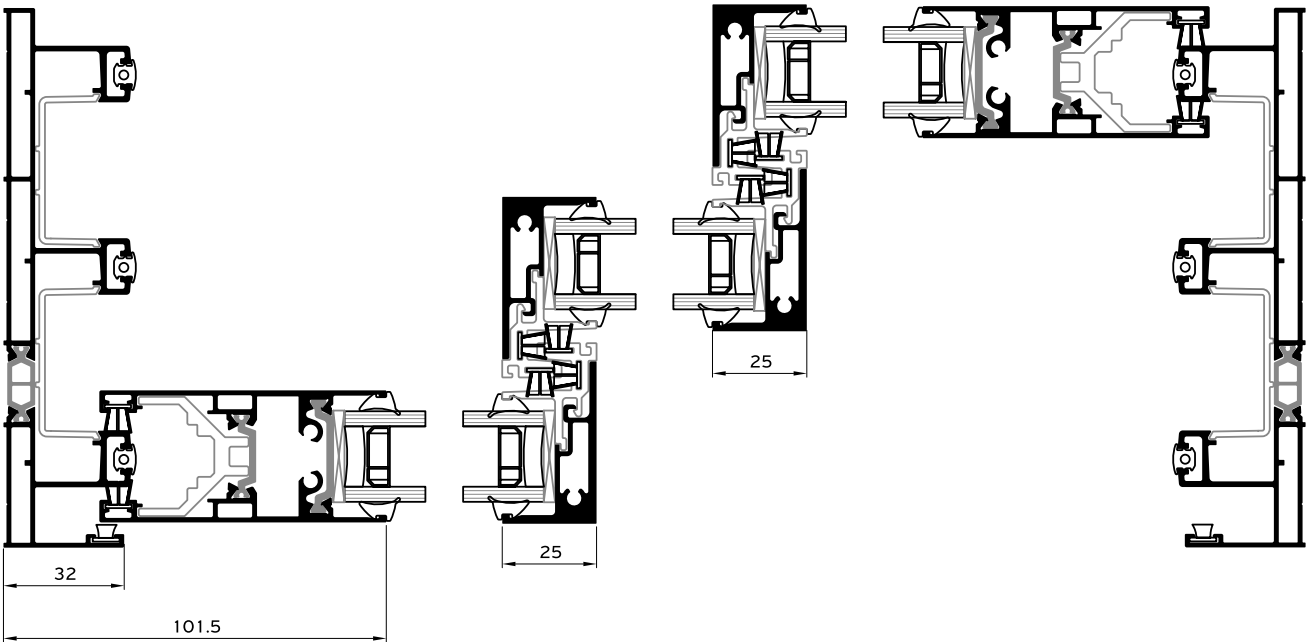
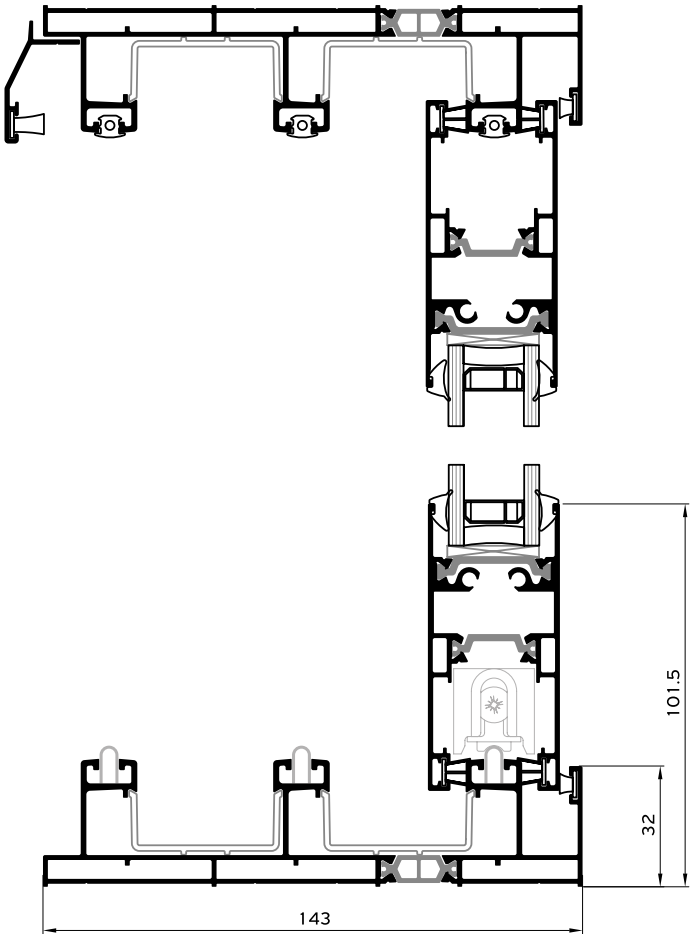
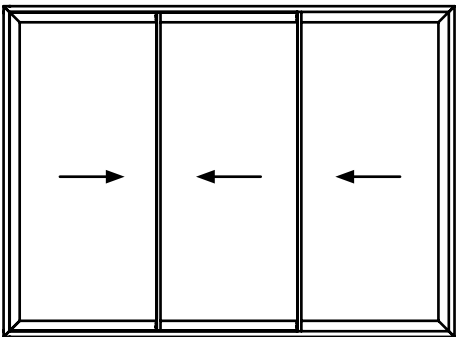

**Alumil** SMARTIA  
S350

**4 Sashes / 2 Track**

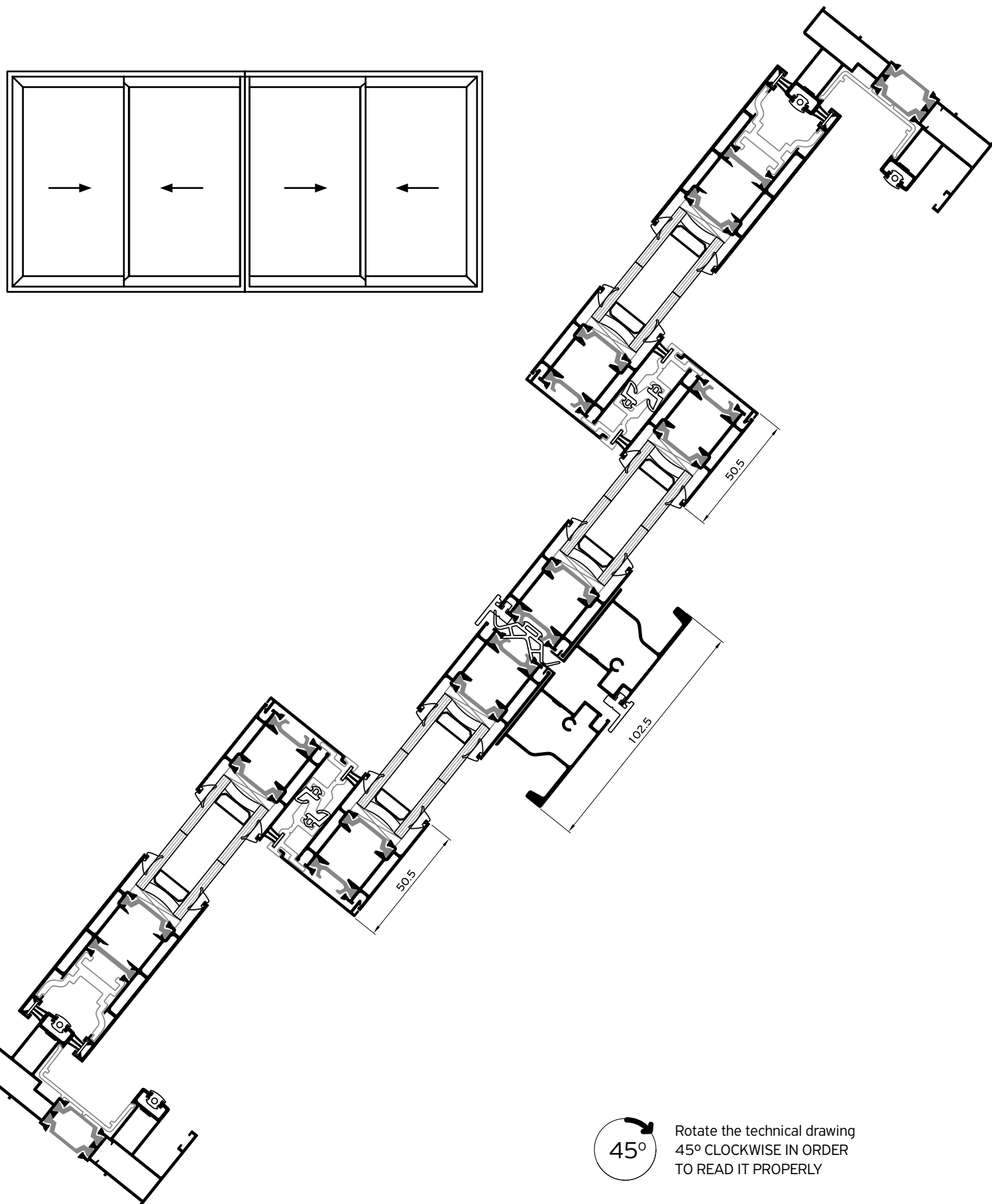

45° Rotate the technical drawing  
45° CLOCKWISE IN ORDER  
TO READ IT PROPERLY

**Alumil** SMARTIA  
S350 LT

**4 Sashes / 2 Track**  
**Low Threshold**

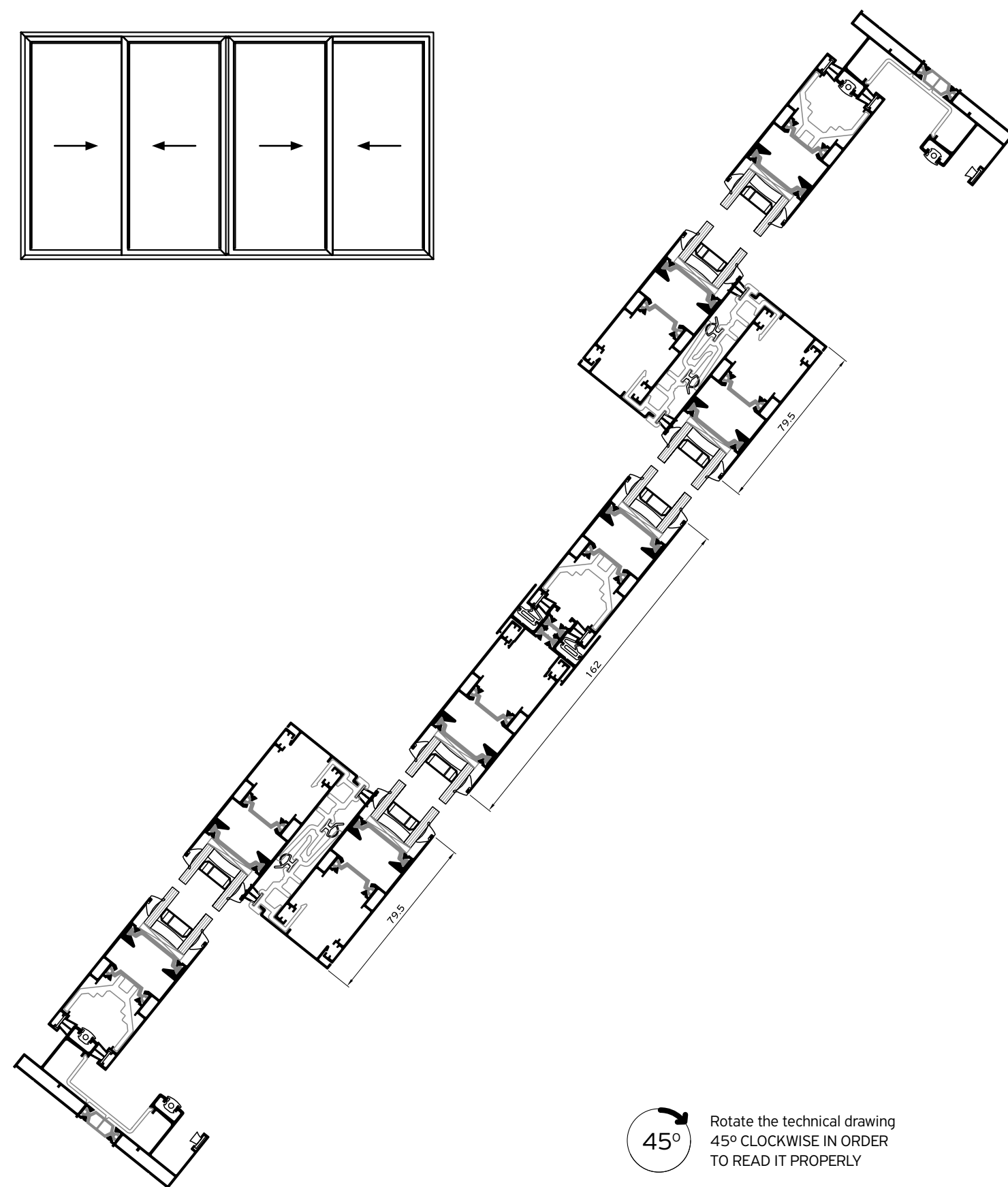

45° Rotate the technical drawing  
45° CLOCKWISE IN ORDER  
TO READ IT PROPERLY

**Alumil** SMARTIA  
S350

## POCKET WINDOW

2 Sashes / 1 Track  
Flyscreen / Shutter

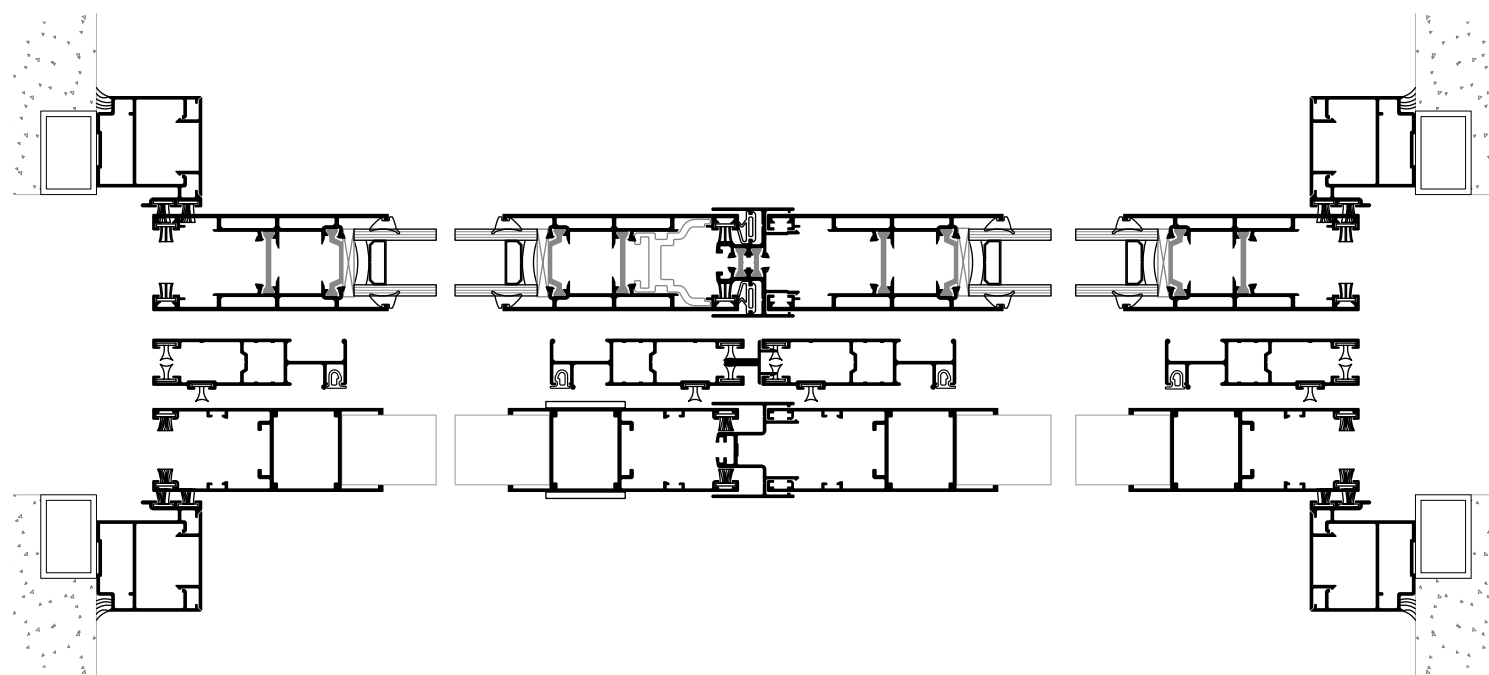
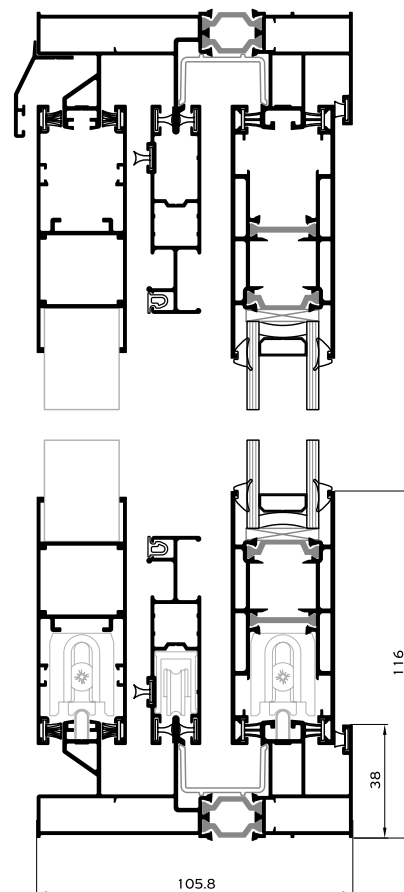
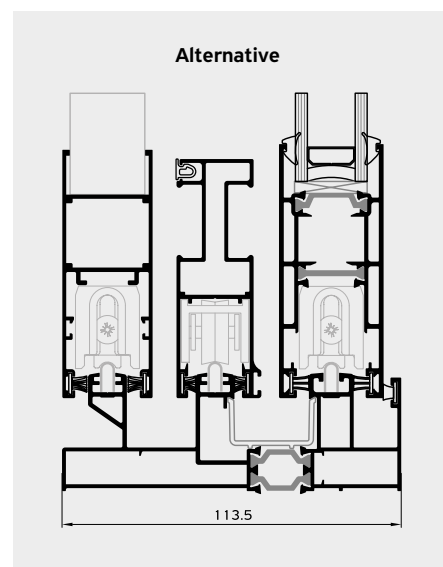
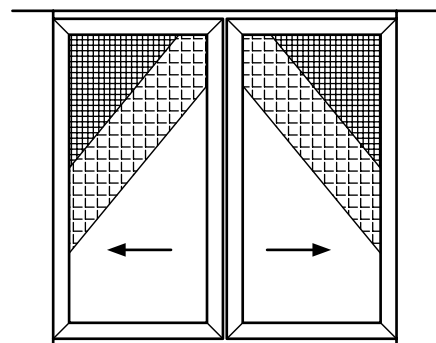

**Alumil** SMARTIA  
S350 LT

## POCKET WINDOW



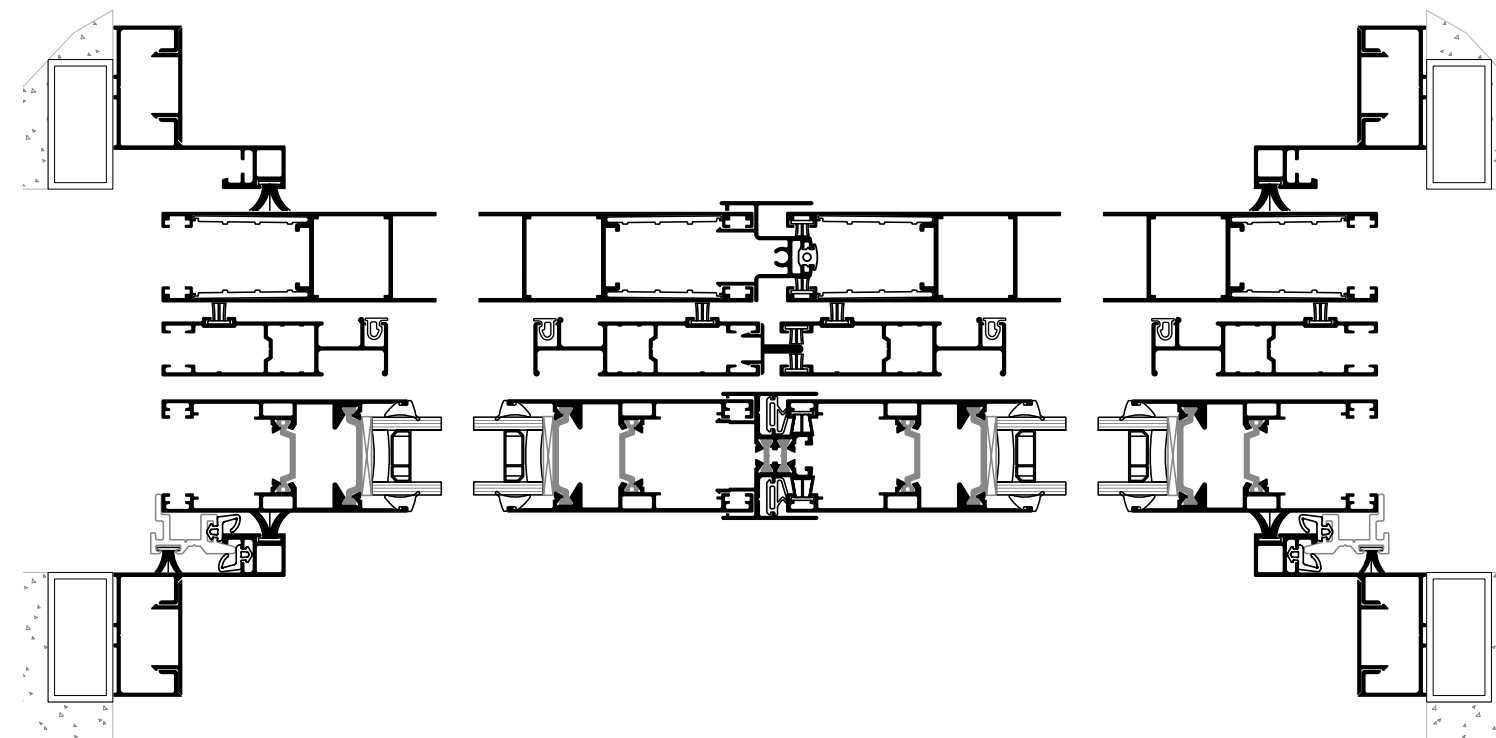
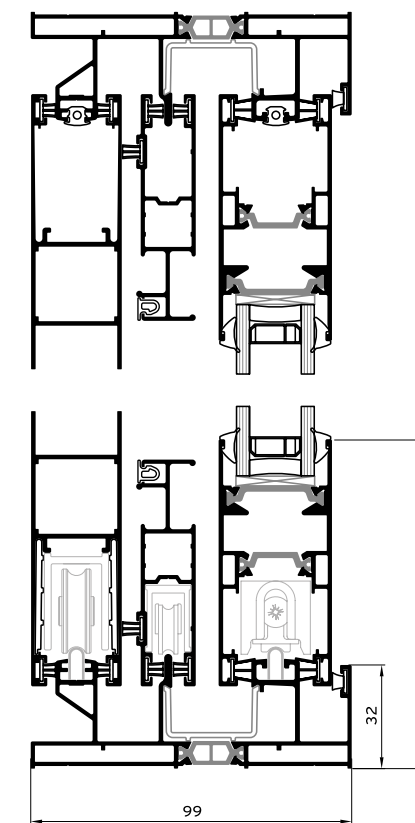
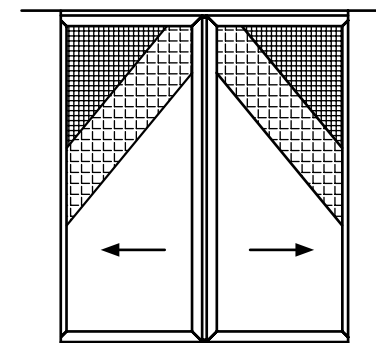



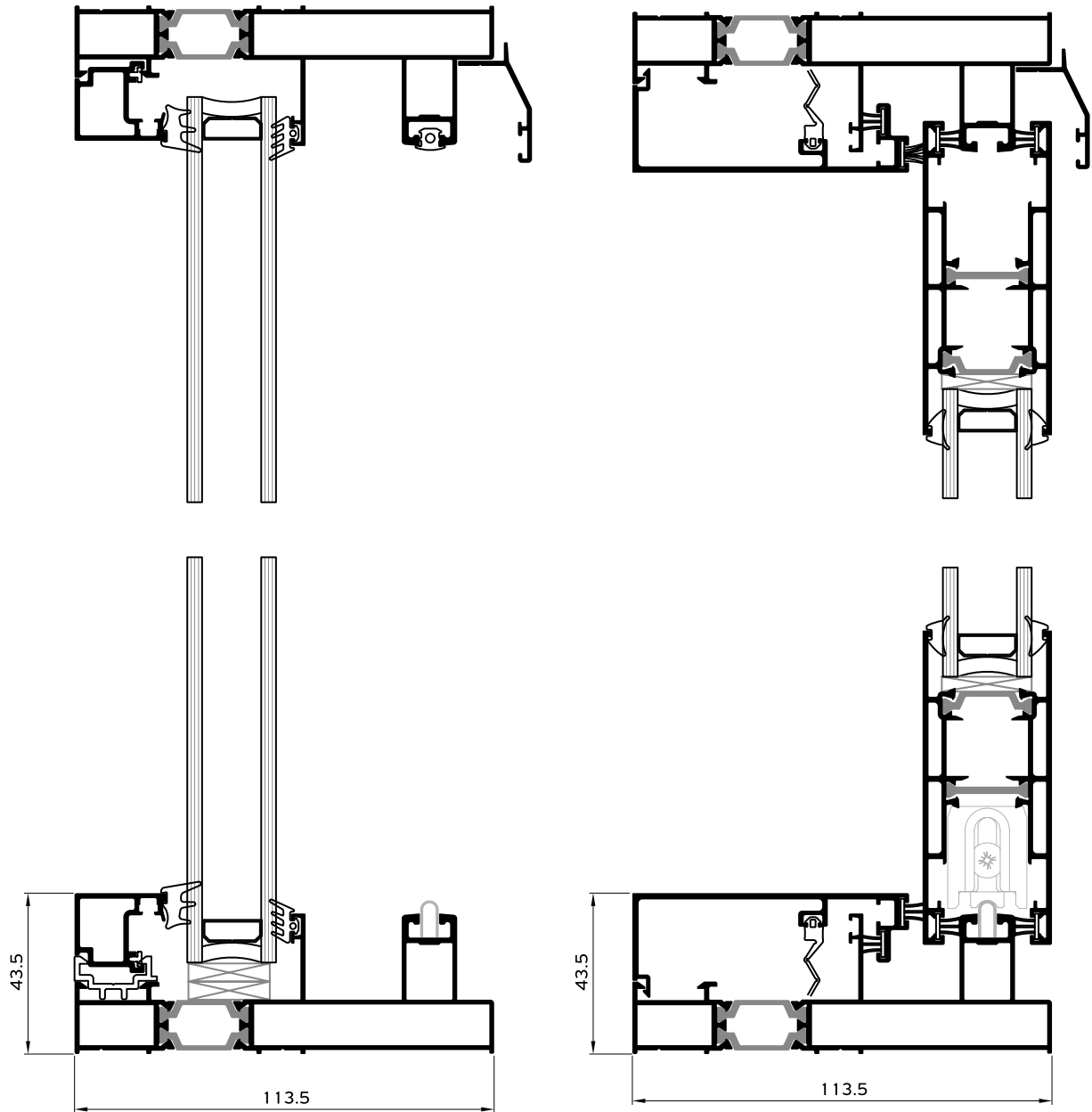
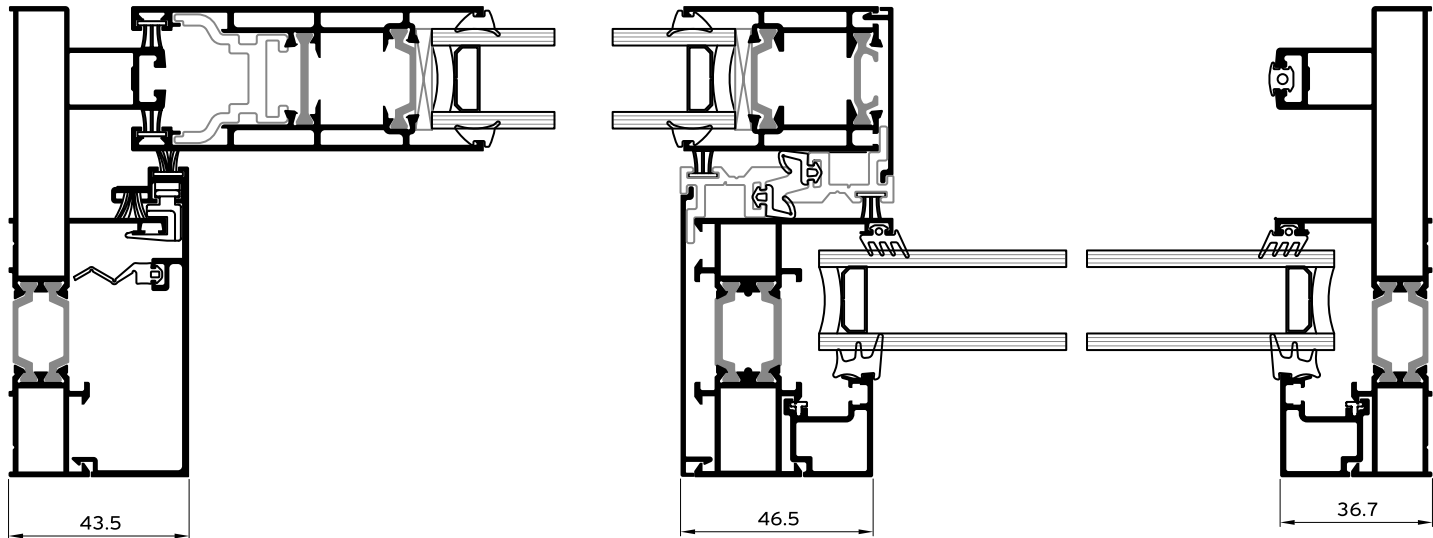
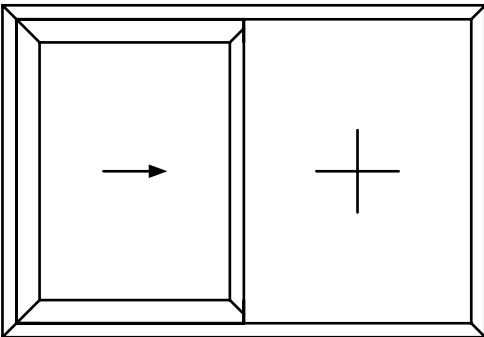

2 Sashes / 1 Track  
Flyscreen / Shutter  
Low Threshold

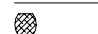

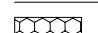
1 Sash / Fixed Light

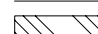
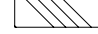

# Installation

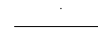
	PRECOMPRESSED MULTI-FUNCTION SEALING TAPE
	BACKER ROD
	HYBRID SEALANT OR NEUTRAL SILICONE
	STYRODUR HIGH DENSITY BOARD
	MARBLE
	POLYURETHANE FOAM
	POLYSTYRENE
	WALL CONSTRUCTION
	WALL FINISH
	REINFORCED CONCRETE
	AIR WATER VAPOR BARRIER TAPE

SIDE SECTION

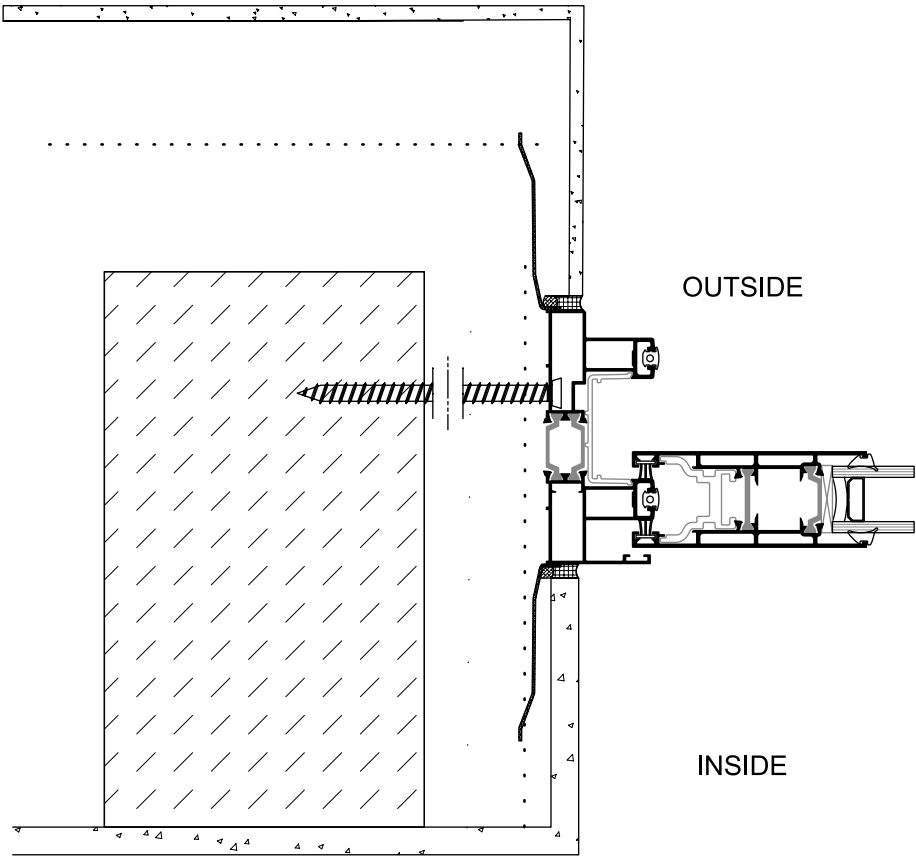

TOP SECTION

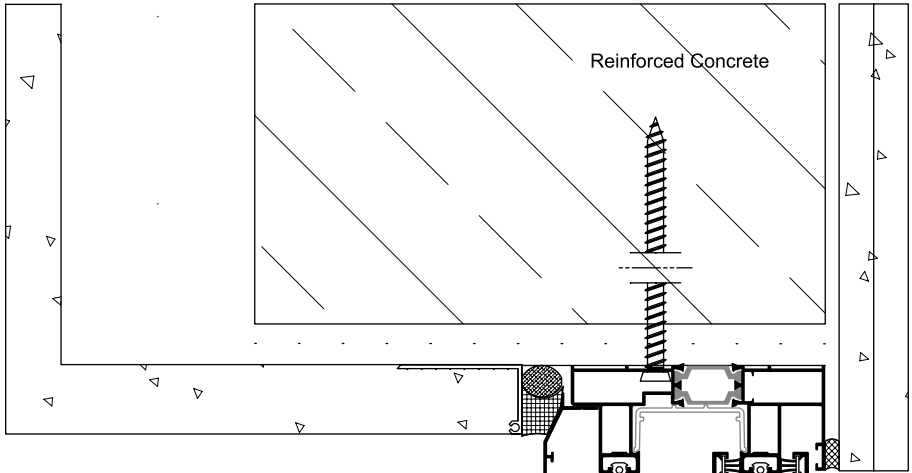





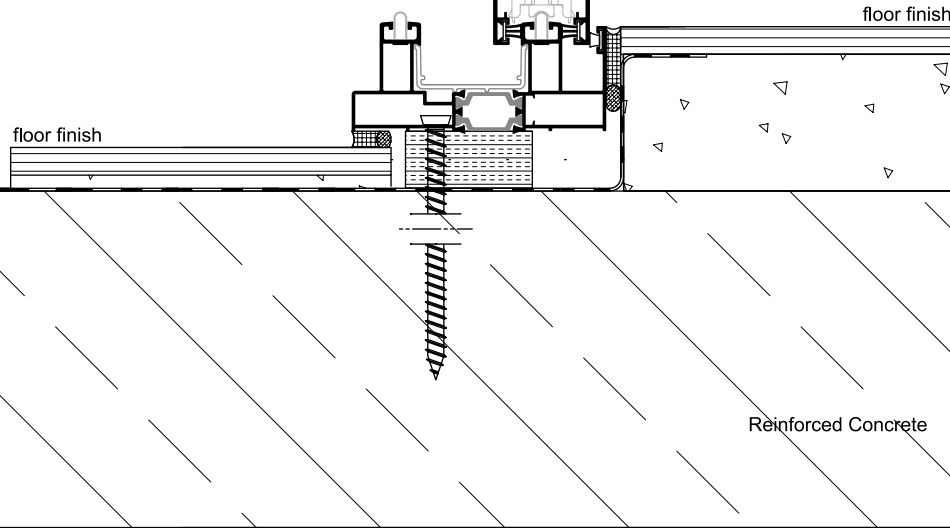



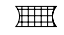
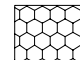

OUTSIDE

INSIDE

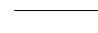

BOTTOM SECTION

# Installation

	PRECOMPRESSED MULTI-FUNCTION SEALING TAPE
	BACKER ROD
	HYBRID SEALANT OR NEUTRAL SILICONE
	STYRODUR HIGH DENSITY BOARD
	MARBLE
	POLYURETHANE FOAM
	POLYSTYRENE
	WALL CONSTRUCTION
	WALL FINISH
	REINFORCED CONCRETE
	AIR WATER VAPOR BARRIER TAPE

SIDE SECTION

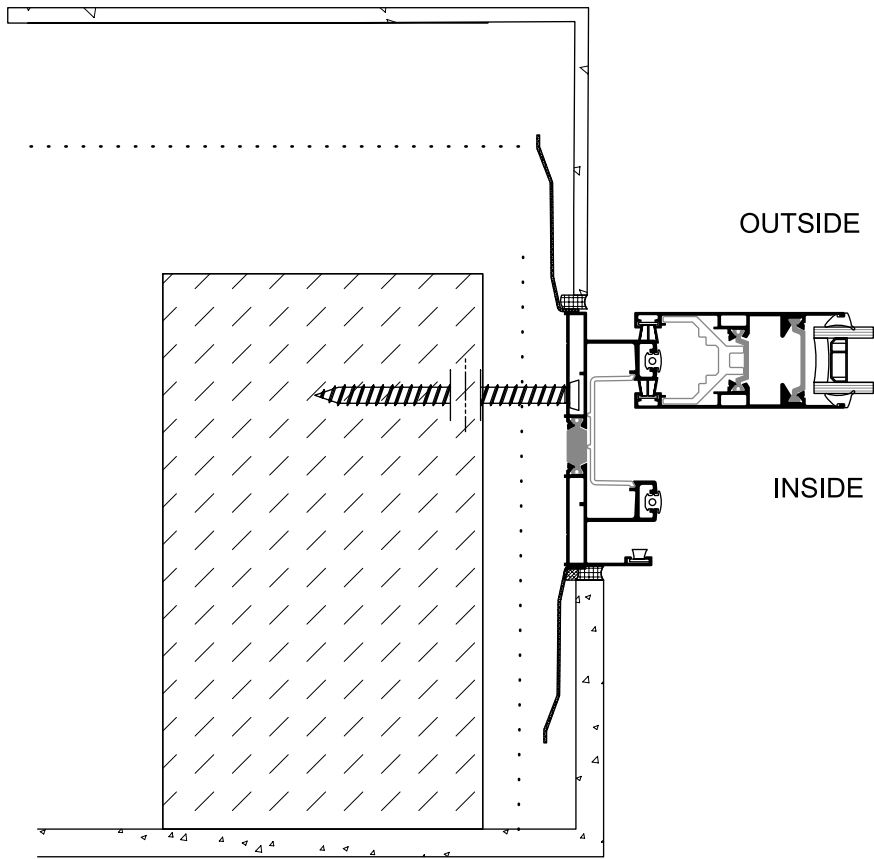

TOP SECTION

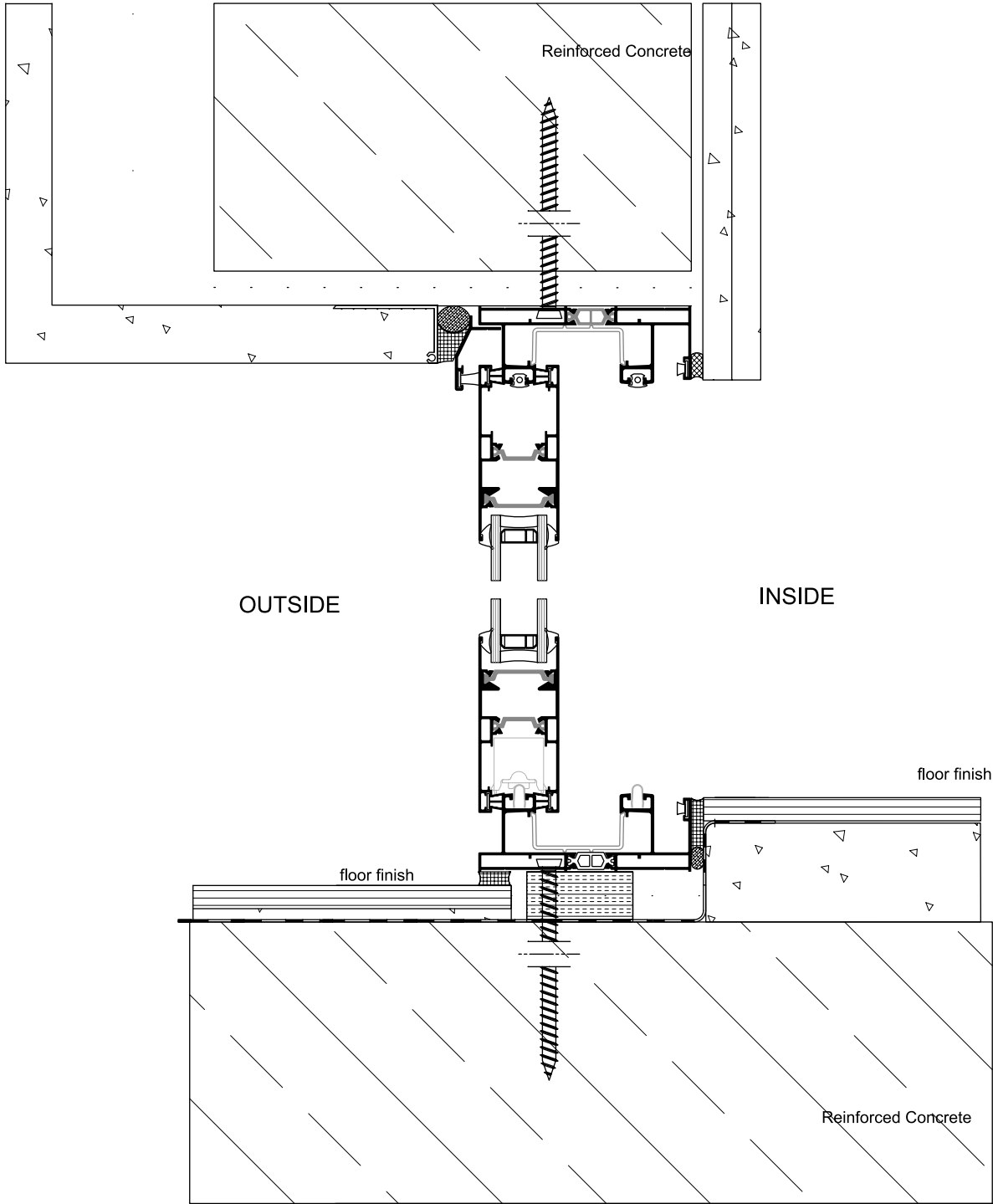

BOTTOM SECTION

# Applications

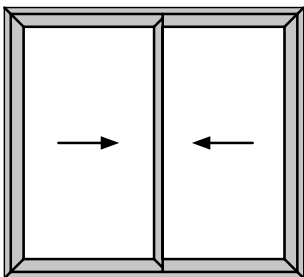

2 SASHES / 2 TRACK

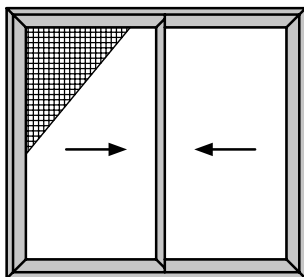

2 SASHES / 2 TRACK / FLYSCREEN

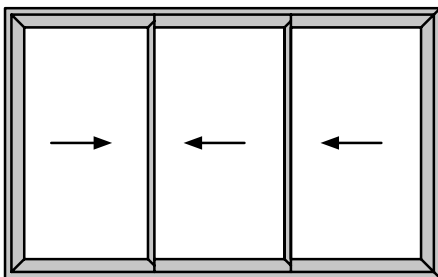

3 SASHES / 3 TRACK

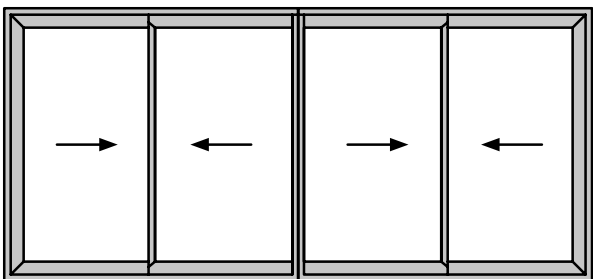

4 SASHES / 2 TRACK

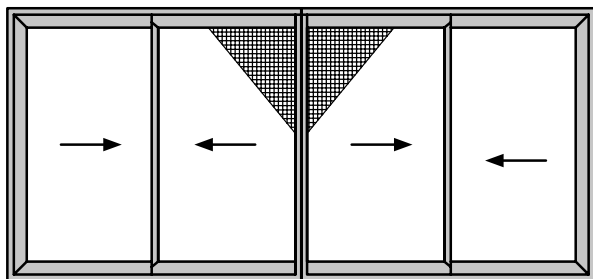

4 SASHES / 2 TRACK / FLYSCREEN

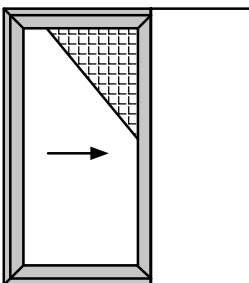

POCKET WINDOW  
1 SASH / 1 TRACK / SHUTTER

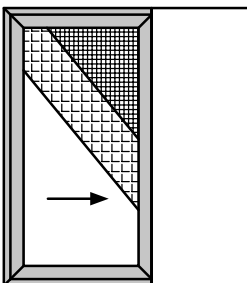

POCKET WINDOW  
1 SASH / 1 TRACK / FLYSCREEN / SHUTTER

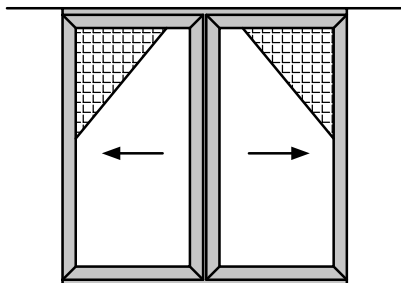

POCKET WINDOW  
2 SASHES / 1 TRACK / SHUTTER

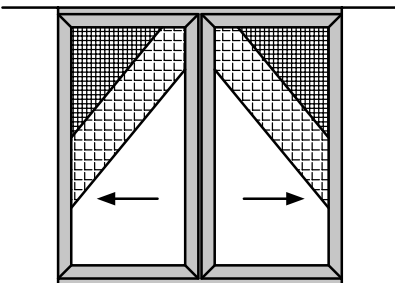

POCKET WINDOW  
2 SASHES / 1 TRACK / FLYSCREEN / SHUTTER

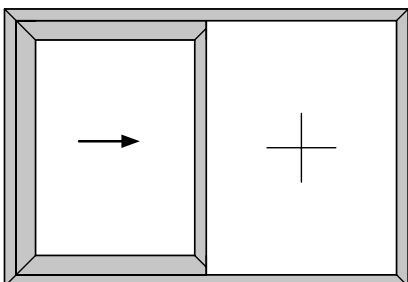

1 SASH / FIXED LIGHT

# Table of performance

## CERTIFICATION



**WATER TIGHTNESS**  
EN 12208



**AIR PERMEABILITY**  
EN 12207



**WIND LOAD RESISTANCE**  
MAX TEST PRESSURE  
EN 12210



**WIND LOAD RESISTANCE**  
TO FRONTAL DEFLECTION  
EN 12210



**SOUND REDUCTION**  
EN 10140, EN 717

## CLASSIFICATION

1A (0 Pa)	2A (50 Pa)	3A (100 Pa)	4A (150 Pa)	5A (200 Pa)	6A (250 Pa)	7A (300 Pa)	8A (450 Pa)	9A (600 Pa)
1 (150 Pa)	2 (300 Pa)	3 (600 Pa)	4 (600 Pa)					
1 (400 Pa)	2 (800 Pa)	3 (1200 Pa)	4 (1600 Pa)	5 (2000 Pa)				
A (≤ 1/150)		B (≤ 1/200)				C (≤ 1/300)		
		38 dB						

ALUMIL has also certified the system SMARTIA S350 according to ASTM standards which are available upon request.

## THERMAL PERFORMANCE

DIMENSIONS IN MM  
(W x H)

U<sub>w</sub> in W/m<sup>2</sup>K  
(U<sub>g</sub> = 0,8)

U<sub>w</sub> in W/m<sup>2</sup>K  
(U<sub>g</sub> = 1,0)

U<sub>w</sub> in W/m<sup>2</sup>K  
(U<sub>g</sub> = 1,1)

S350 2 SASHES / 2 TRACK	2300 x 2180	1,76	1,92	1,99
S350 LT 2 SASHES / 2 TRACK	2300 x 2180	1,75	1,91	1,99
S350 4 SASHES / 2 TRACK	4600 x 2180	1,71	1,87	1,95
S350 LT 4 SASHES / 2 TRACK	4600 x 2180	1,70	1,86	1,95



Cradle to Cradle Certified® is the global standard for products that are safe, circular and responsibly made

## REFERENCE PROJECTS



1

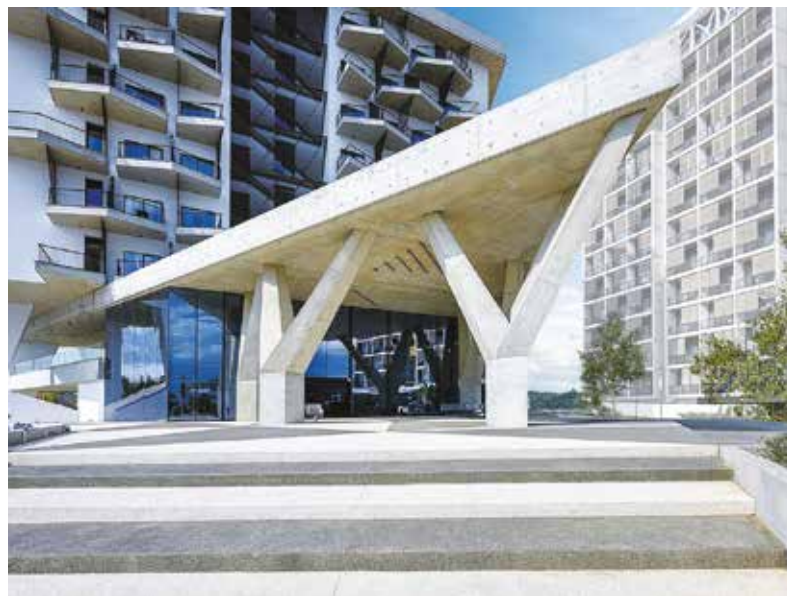

2



3

1. PRIVATE RESIDENCE / LEFKADA, GREECE
2. TRIANGLE STUDENT HALLS / NICOSIA, CYPRUS
3. CRONWELL RESORT SERMILIA / CHALKIDIKI, GREECE

4. CARAVIA BEACH HOTEL / KOS, GREECE
5. DOC - TEMPORARY FLOATING HOUSE / CALARASI, ROMANIA
6. PRIVATE RESIDENCE / SKIATHOS, GREECE



4



5



6

www.alumil.com

DISCOVER MORE:



ALUMIL  
MIDDLE EAST DMCC

MAZAYA BUSINESS AVENUE BB1  
29TH FLOOR, OFFICE #2907  
JUMEIRAH LAKES TOWERS, DUBAI, UAE  
TEL.: +971 4 4425930  
FAX: +971 4 4416528  
EMAIL: marketing.uae@alumil.com  
**www.alumil.ae**

ALUMIL  
HEADQUARTERS

KILKIS INDUSTRIAL AREA  
KILKIS - GR 61100  
TEL.: +30 23410 79300  
FAX.: +30 23410 71988  
E-MAIL: info@alumil.com



**ALUMIL  
MIDDLE EAST DMCC**

MAZAYA BUSINESS AVENUE BB1  
29TH FLOOR, OFFICE #2907  
JUMEIRAH LAKES TOWERS,  
DUBAI, UAE  
**TEL.:** +971 4 4425930  
**FAX:** +971 4 4416528  
**EMAIL:** marketing.uae@alumil.com

**ALUMIL  
HEADQUARTERS**

KILKIS INDUSTRIAL AREA  
KILKIS - GR 61100  
**TEL.:** +30 23410 79300  
**FAX.:** +30 23410 71988  
**E-MAIL:** info@alumil.com

**[www.alumil.ae](http://www.alumil.ae)**

**alumil**